

NOTE:
 BOTTOM LAYER OF INSULATION SHALL BE LAID DOWN IN
 A STAGGERED PROFILE. STAGGER AND OFFSET TOP LAYER
 OF INSULATION FROM BOTTOM LAYER TO PREVENT
 ALIGNED EDGES.

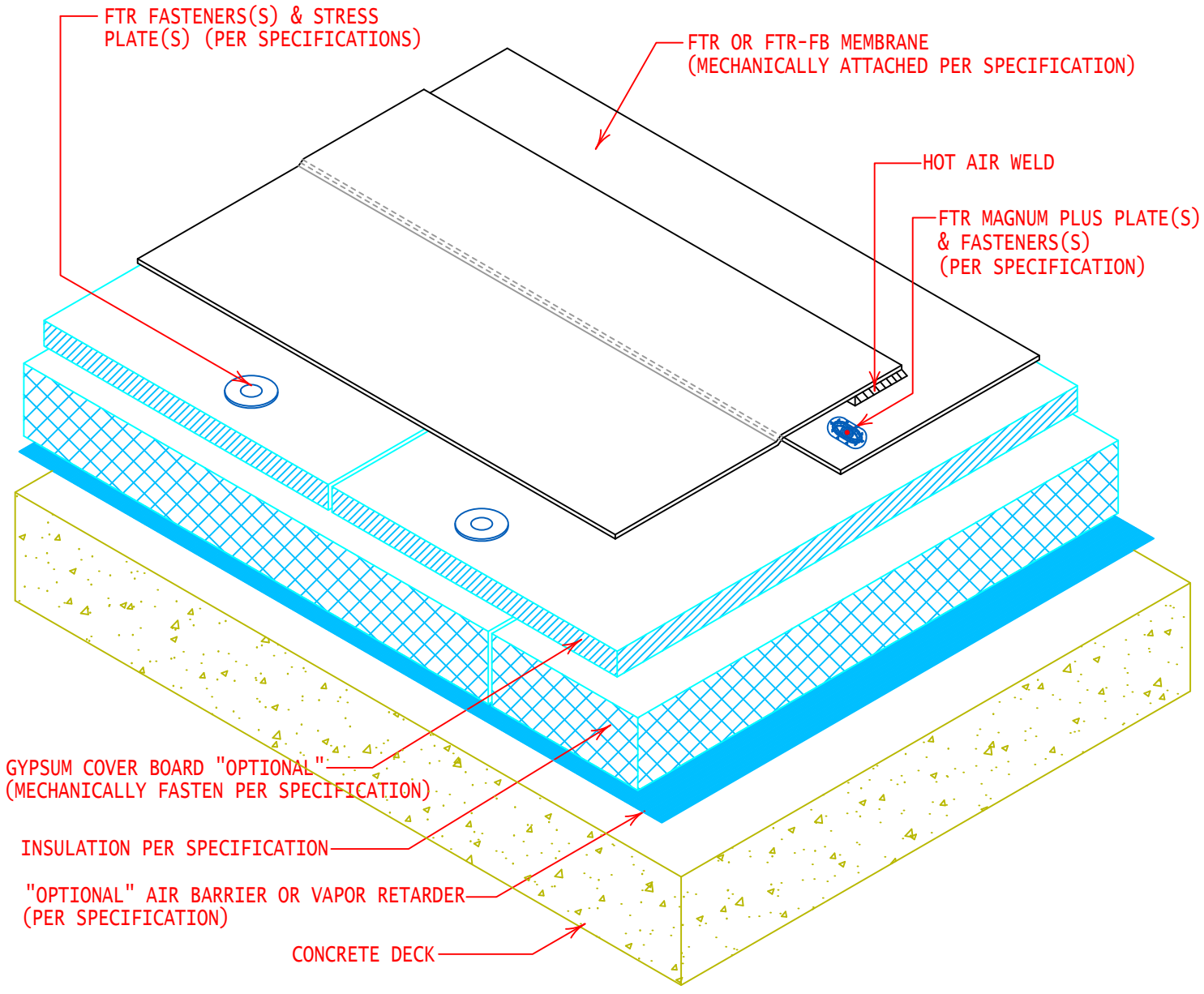

GENERAL REFERENCE:
 "FTR GS 01/21"
 APPLICABLE SYSTEMS:
 "FTR MA 01/21"

COMPOSITE ROOF SYSTEM CROSS SECTION
 (MECHANICALLY FASTENED SYSTEM)

REVISES DETAIL	ISSUE DATE	DRAWING NUMBER
ALL PREVIOUS	03-15-21	FTR-DMFS1a