

A close-up, grayscale photograph of a metal hinge mechanism, showing the rounded, polished surfaces of the hinge pins and the textured metal body. The background is blurred, focusing attention on the mechanical details.

# FOCUS ON HINGES FOR WHITE GOODS INDUSTRY

FOR YOUR CONFIDENTIAL USE ONLY - BRUSCHI



3 different hinges for White Goods Industry

We actually produce for our **customers**



# Washing Machine Hinges

Case Study 1

Case Study 1 | Aesthetic requirements - No parting line

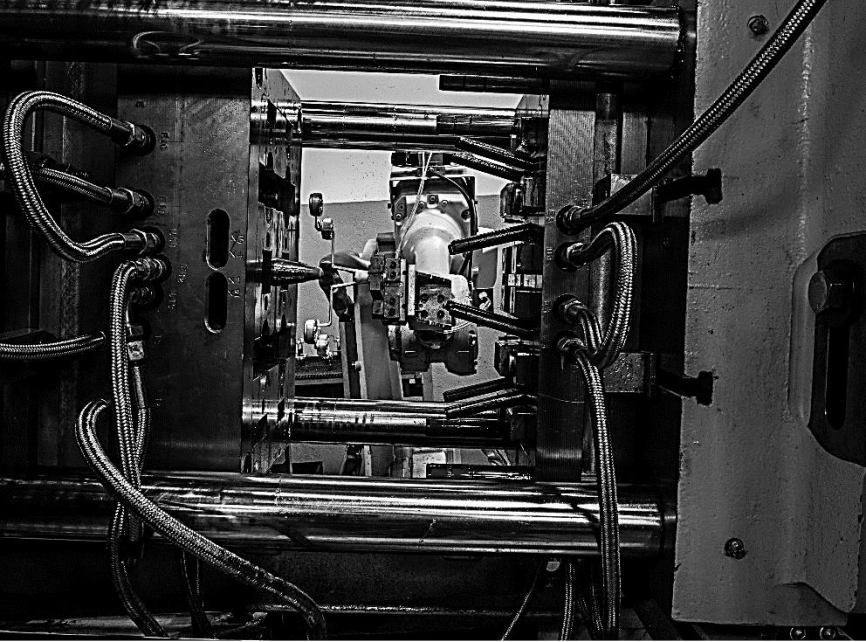

## Washing Machine Hinges



Goal: No parting line

SOP: 2010

Number of parts produced: 3 mln



### Main Points

- Design analysis to avoid parting line
- Strict aesthetic requirements
- Automatic processing techniques



# Refrigerator Hinges

Case Study 2

Case Study 2 | New Shapes for Function Component





## Refrigerator Hinges

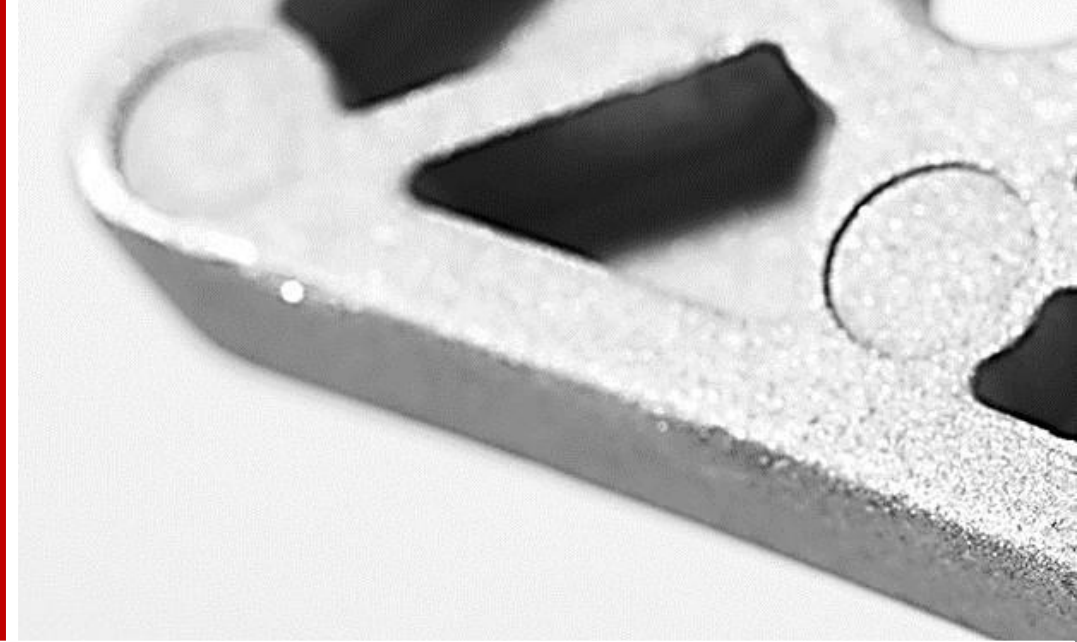

Goal: New shapes

SOP: 2008

Number of parts produced: 2,5mln



### Main Points

- Co-Design activities to develop functional shapes
- Component weight reduction
- Deeper collaboration with the client



# Washing Machine Hinges

Case Study 3

Case Study 3 | Complex mould tools making





## Washing Machine Hinges

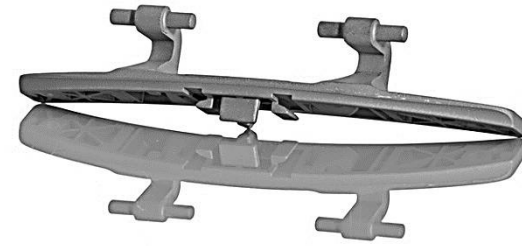

Goal: Complex mould

SOP: 2016

Number of parts produced: 800.000



### Main Points

- Simulation and Filling Optimization to avoid porosity
- Deeper analysis for pins geometry structure
- Automatic assembly with other components





# Dryer Hinges

Case Study 4

Case Study 4 | Design Optimization



## Dryer Hinges



Goal: Design Optimization

SOP: 2014

Number of parts produced: 400.000

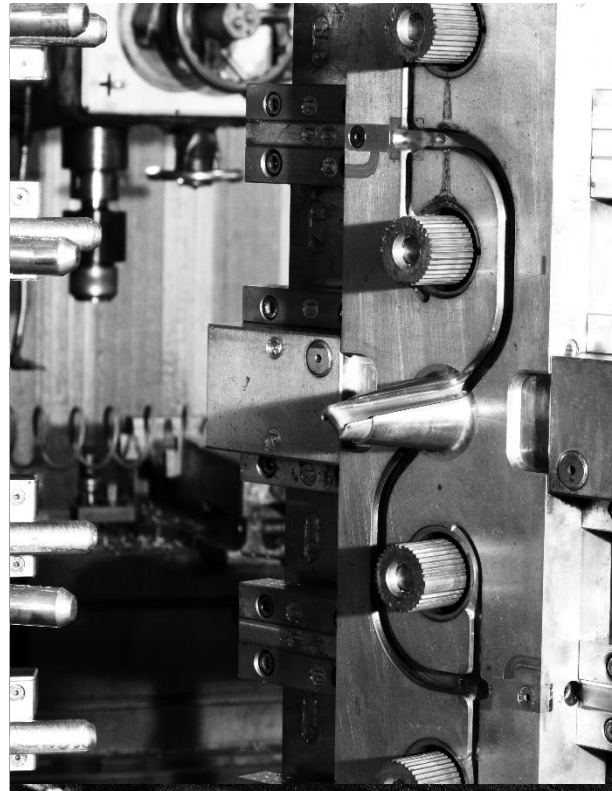

### Main Points

- Co-Design Activity
- Custom Process
- Assembly

# THANK YOU

Want to know more?

*Simone Maggiori - Vice President & Head of Sales*  
[simone.maggiori@bruschitech.com](mailto:simone.maggiori@bruschitech.com)

*Marcello Cazzaniga - Marketing & Business Development Manager*  
[marcello.cazzaniga@bruschitech.com](mailto:marcello.cazzaniga@bruschitech.com)