

M ATC CABINET

Shelf-Mount



CABINETS

CONTROLLERS

DETECTION

PARKING

SIGNALS

SIGNS

SOFTWARE

SPECIALTY

Overview

The M ATC Shelf-Mount Cabinet is part of McCain's revolutionary ATC cabinet series and is built to comply with the latest ATC Standard 5301 V02, making it one of the safest and most efficient cabinets on the market today. The traditional "M" footprint features side-by-side front door design with reduced door swing, ideal for congested or narrow walkways. Through best-in-class diagnostics, smart components, and cutting-edge technology, McCain's ATC Cabinets are the safest available today. With the most sold in the industry, our proven ATC Cabinets meet the needs of today's smart cities and are ready for tomorrow's challenges, including the future of connected and autonomous vehicles.

Benefits

- Safeguards against accidental shock from inadvertent contact with high voltages
- Detects a dark approach for increased driver safety
- Monitors FTR and flasher continuously to ensure operability
- Promotes easy access with side-by-side front door designs
- Reduced door swing ideal for heavily trafficked walkways
- Connected vehicle ready
- ATC Cabinet with traditional NEMA "M" footprint

Product Description

The McCain M ATC Shelf-Mount Cabinet's modern design and advanced safety features complement the operational capabilities of ATC controllers and aim to protect agency, personnel, and public interests.

Unrivaled benefits include load current monitoring to detect a dark approach, no AC power exposed to reduce accidental contact with high voltages, and the ability to keep the intersection in flash while replacing the output assembly.

The cabinet can manage up to 48 detector inputs and 16-channel outputs without any complex wiring. Compact components take up half the space with 48 input channels fitting in the space of the 24-channel input assembly.

M ATC Cabinet - Shelf Mount

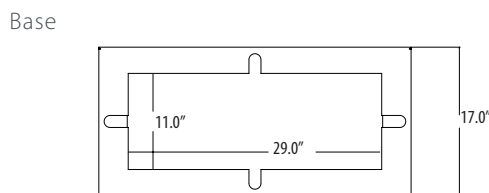
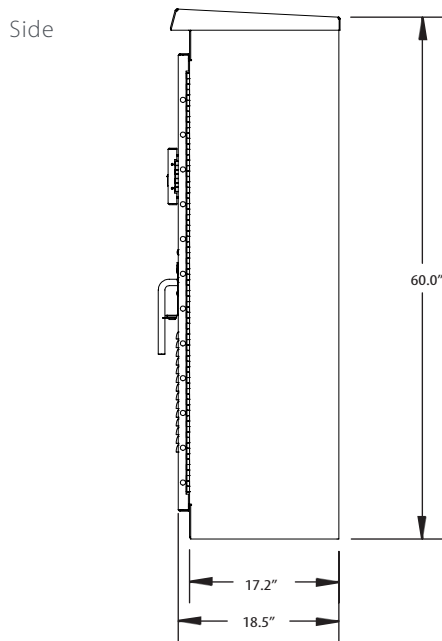
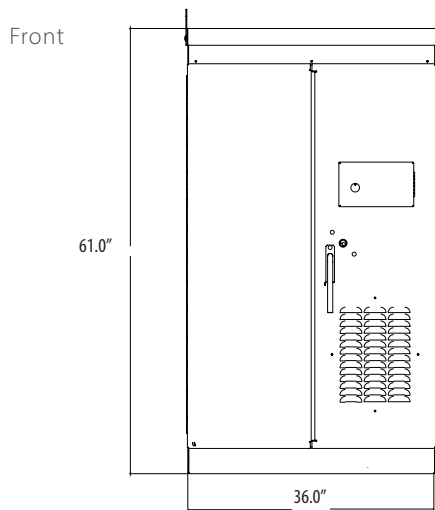

Dimensions rounded to the nearest 0.1"

Standard Features

- Field output termination assembly provides removable contact blocks for easy connections to field signal wires, sockets for flash transfer relays (FTRs), and flash program blocks (FPBs) for output channels
- All channels are flashable and programmable
- FPBs control and select the color (red, yellow, or dark) during flash
- Hermetically sealed high-density FTR features an LED indicator to visually confirm relay is operational and contacts have transferred
- Interior LED cabinet light
- Model 2202 dual flasher/switch pack combination
- Exterior is continuously welded

Assemblies & Components

- 24 or 48-channel input assembly
- 2 or 4-channel industry standard detection modules
- 4 channel detector, PPB, EVP, etc.
- 16-channel output assembly
- 32-channel CMU
- CMU auxiliary display unit
- Model 2216-24 cabinet power supply
- DC power/communication assembly
- Clean AC power assembly
- Police panel with On/Off, MCE, Auto/Flash and Interval Advance push button cable
- Slide-out drawer for storing programming blocks, plans, etc.

General Specifications

Dimensions:	61"H x 36"W x 17"D (rounded to the nearest inch)
Material:	5052-H32 aluminum, 0.125" thick
Finishes:	Natural, powder coat (standard, anti-graffiti, and custom colors)
Doors:	Front door (2)
Latching System:	3-point, choice of Corbin or Best locks
Handles:	3/4" round, stainless steel with padlock hasp
Door Stops:	90° and 180° (±10°), bottom
Ventilation:	Thermostatically controlled 100 CFM fan, louvered air intake in door, Ring Panel air filter
Mounting:	Base mounted
Shipping Weight:	235 lbs without plug-ins or controller

Options

- 3/4" x 16" anchor bolts for mounting (4)
- Garmin GPS Communication Panel
- ATC Cabinet Test Display
- ATC Cabinet Input Test Panel
- Input File Test Card
- ATC CyberCabinet
- ATC Cabinet Alarm Panel