

ATTENTION: PLEASE READ BEFORE INSTALLING THE PUMP MODULE

This pump module requires a firmware and portal update to work. After installing your pump module (see below) you will need to contact esusupport@blacklinesafety.com with your organisation details and EXO serial number. We will arrange to have a firmware update sent to your unit and portal activated for pump modules. Once completed your pump module will function.

INSTALL THE G7 EXO FOUR-CHANNEL PUMP MODULE

Follow these steps to switch out a diffusion module gas inlet for a four-channel pump module.

1. Ensure the EXO is:
 - In a dry, safe, non-hazardous environment
 - Not connected to any external charging source, like the trickle charger or a solar panel
 - Powered off
2. Use a Philips screwdriver to remove the three screws holding the diffusion module to the EXO body.
3. Gently pull out the diffusion module until it is free of the EXO.
4. Detach the diffusion module from the EXO gas tubing by twisting and pulling the quick connect.
5. Remove the diffusion module.
6. Hold the four-channel pump module up to the EXO and use the quick connect to re-attach the gas tubing.
7. Gently slide the pump module into the EXO body, taking care to ensure the gas tubing is not crimped or pinched between the module and EXO. The module should fit tight to the EXO body.
8. Use the three screws to attach the pump module.
9. Power the EXO on. In the LCD screen under the Gas options menu > Inlet settings, the new pump inlets (1-4) will display as OFF.
10. Connect tubing to the inlet you want to use.
11. Go to the Gas options menu > Inlet settings. Select the inlet you connected the tubing to. Use the arrow buttons and OK to toggle the inlet to ON. Your EXO now has pumps functionality.

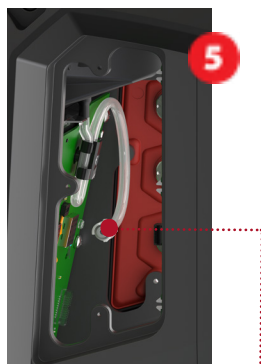

EXO tubing with quick connect



Four-channel



Visit [support.Blacklinesafety.com](https://support.blacklinesafety.com) to download the technical user manual with descriptions of how to use and configure your device and for detailed specifications.