

S-5-H90

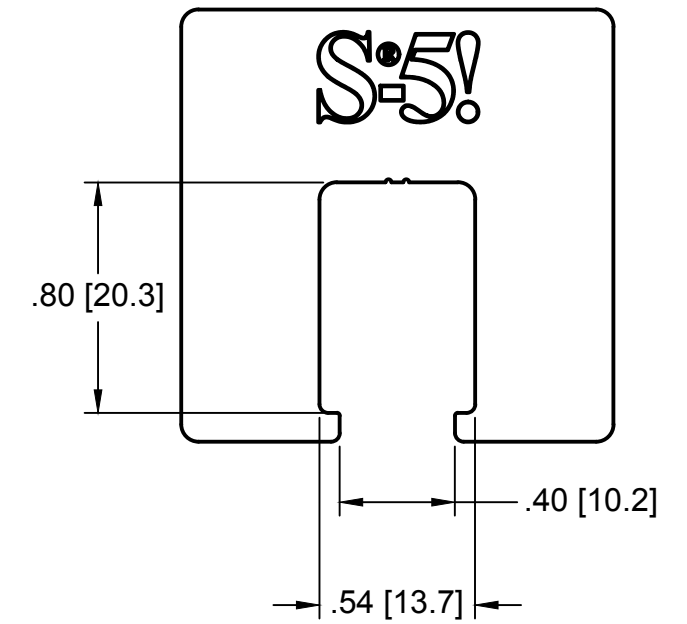

Left

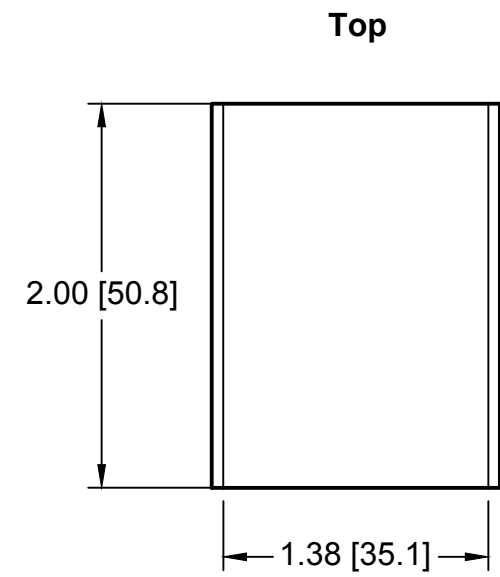
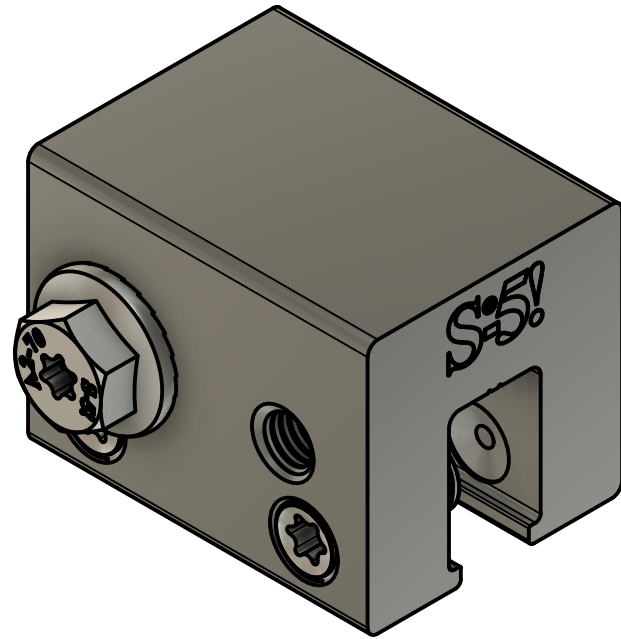
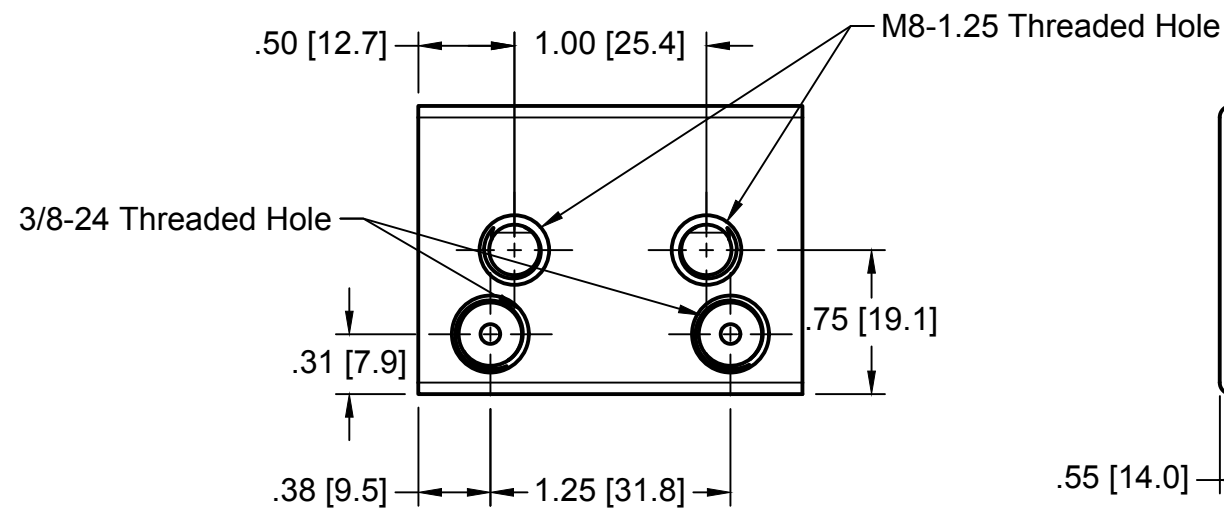

Front

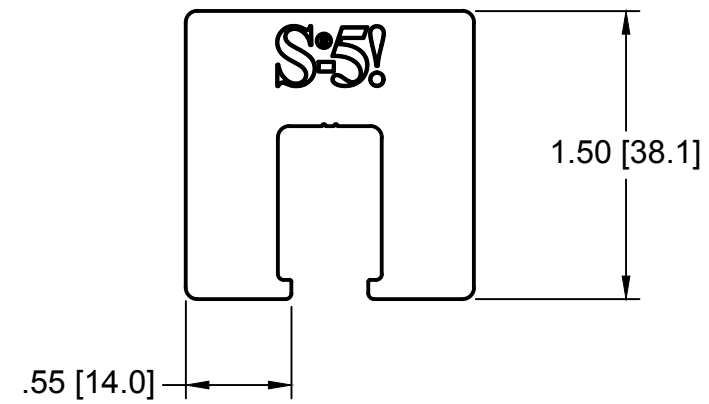

General Notes:

1. S-5-H90
2. 0.9" 3/8-24 T30 Drive SetScrew
4. M8-1.25 X 17mm (13mm/T30 Torx Drive)
5. Example Roof

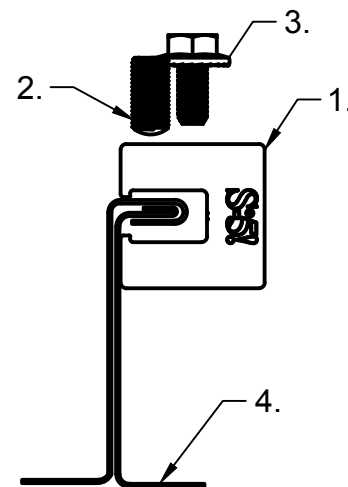

MATERIAL: 6000 Series AL		METAL ROOF INNOVATIONS, LTD.		
EST ASSEMBLY WT: 0.371 lbs		8750 WALKER RD COLORADO SPRINGS, CO 80908 719-495-0518 719-495-0045 (FAX)		
HARDWARE: <small>1/2" 3/8-24 T30 Drive SetScrew M8-1.25 (13mm) Torx Drive</small>	TITLE S-5-H90 [CCD]	DRAWING NO. U11-B-14-D	DRAWN BY SNLR	DATE 3/7/2022
	SCALE 1:2	FILE NAME U11-B-14-D (S-5-H90) [CCD]		
S-5!® PRODUCTS ARE PROTECTED BY MULTIPLE U.S. AND FOREIGN PATENTS. VISIT OUR WEBSITE AT WWW.S-5.COM FOR COMPLETE INFORMATION ON PATENTS AND TRADEMARKS				