

S-5![®]

The Right Way!

The right way to attach almost anything to metal roofs!

Installation Instructions

Stop! Has your snow retention system been designed properly with the assistance of an authorized S-5![®] distributor?

Notice to S-5![®] product users: Specific layout and assembly schematics for S-5![®] products are the responsibility of the user or project designer. Due to the many variables involved with specific panel products, climates, snow melt phenomena, and job particulars, the manufacturer cannot and does not express any opinions as to the suitability of any S-5![®] assembly for any specific application and assumes no liability with respect thereto. More information is available from S-5![®] distributors as well as from the S-5![®] website:

www.S-5.com. This document is an installation guide only and the photographs and drawings herein are for the purpose of illustrating installation, tools and techniques, not system designs. Information contained within is intended to apply to the document as a whole.

X-Clip II[™] or X-Clip III[™] are optional components that can be added to your S-5! X-Gard[™] snow retention system to further retard the migration of snow. One or two clips are used between seams (see www.S-5.com for details).

Tools Needed

- Self-Drilling Stainless Steel Screws (included)
- 5/16" Hex Drive Socket
- Screw Gun*

*For time saving tool recommendations contact S-5!

To Install X-Clip[™]

STOP! Be sure you are using the correct X-Clip! Use of the incorrect X-Clip can cause damage to the X-Gard system or roof. Below is a guideline for determining which X-Clip to use.

X-Clip II	X-Clip III
X-Clip II is especially made for seam heights of 1" (25 mm) and 1-3/4" (44.5 mm). It will also fit 2" (51 mm) vertical seams, but not 2" (51 mm) horizontal.	X-Clip III is designed for seam heights of 2" (51 mm) up to 3" (76 mm). X-Clip III should not be used on 3" horizontal seams.

1. Center the appropriate X-Clip on the NEX[®] 2.0 pipe between two clamps when using one X-Clip per panel. When using two X-Clips per panel, space X-Clips an equal distance from seam and other X-Clip.

Note: two X-Clips are recommended when panel width exceeds 24".

Important: X-Clip should be placed between panel striations not on top.

2. While applying downward pressure on the part, ensure that the "toe" engages the surface of the panel just before the "heel" (see diagram 1 above).

3. Secure the X-Clip by driving the stainless steel, self-drilling screw through the pre-punched holes of the X-Clip and into the pipe. Be careful not to overtighten the screws; if your screw gun RPMs accelerate, you have likely stripped it out. If a fastener has been stripped, it is important to remove the fastener and shift the X-Clip over slightly and re-fasten. To avoid stripping, use screw gun with adjustable torque clutch.

S-5![®] Warning! Please use this product responsibly!

Products are protected by multiple U.S. and foreign patents. For published data regarding holding strength, fastener torque, patents, and trademarks, visit the S-5! website at www.S-5.com.

Copyright 2014, Metal Roof Innovations, Ltd. S-5! products are patent protected.

S-5! aggressively protects its patents, trademarks, and copyrights. Version 031116.

These instructions are for use by those experienced in the trade. Always follow appropriate safety precautions and use appropriate tools.

XC231-V1.10316

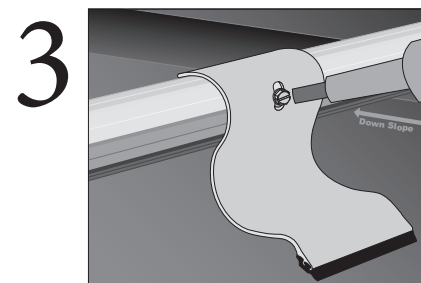
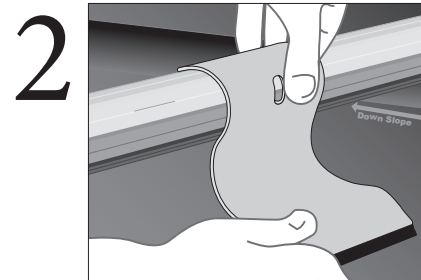
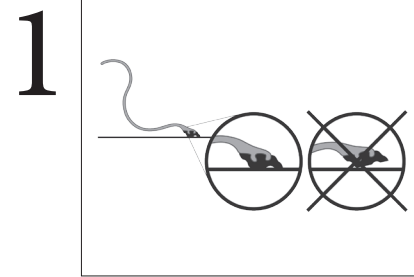

Above illustrations show X-Clip III[™].