

PROJECT:	Circulators	UNIT TAG:		QUANTITY:	1
REPRESENTATIVE:	Hurley Engineering	TYPE OF SERVICE:	Recirculation	DATE:	
ENGINEER:	TBD	SUBMITTED BY:	Devin Carle	DATE:	
CONTRACTOR:	TBD	APPROVED BY:		DATE:	
		ORDER NO.:		DATE:	

ALPHAHWR-D 15-55 HWR-D

The ALPHA 15-55 HWR-D is a hot water recirculation pump started via a push button when a demand for hot water is identified within the occupancy. The push button will activate the pump via a Bluetooth signal and will run until the water entering the water piping reaches a temperature of 102°F, as indicated by the external temperature sensor, or has been operating continuously for 5 minutes.



Product photo could vary from the actual product

Conditions of Service	Pump Data	Motor Data
Flow: 12.5 US gpm	Maximum operating pressure: 145.04 psi	P1 max: 2 .. 45 W
Head: 6.742 ft	Liquid temperature range: 35.6 .. 230 °F	Rated voltage: 115 V
Efficiency: 35.6 %	Maximum ambient temperature: 104 °F	Main frequency: 60 Hz
Liquid: Water	Approvals: ETL, FCC, NSF	Enclosure class: IP42
Temperature: 140 °F	Pipe connection: 1 1/4	Insulation class: F
NPSH required: ft	Product number: On request	Motor protection: NONE
Specific Gravity: 0.985		Thermal protection: ELEC

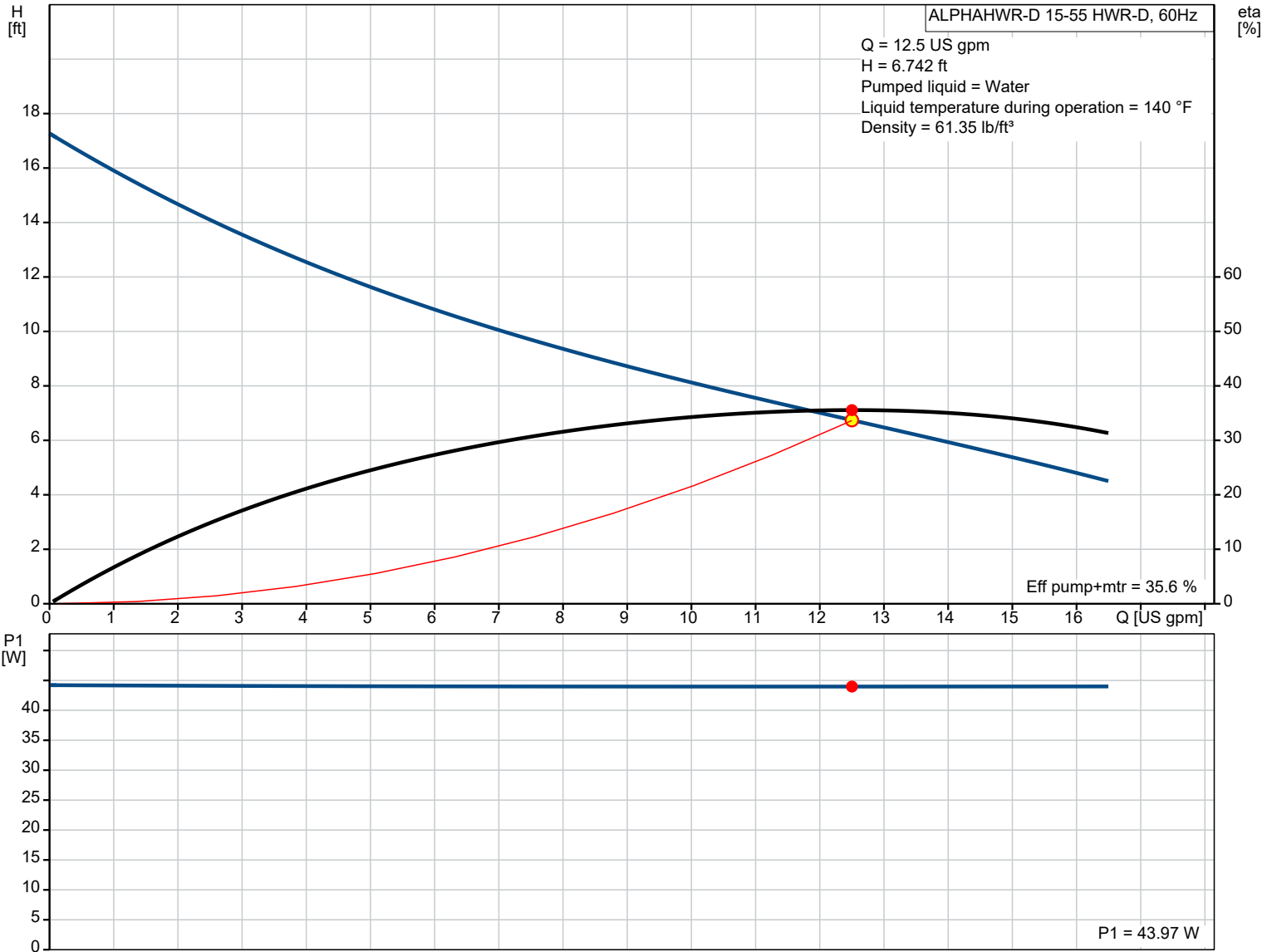

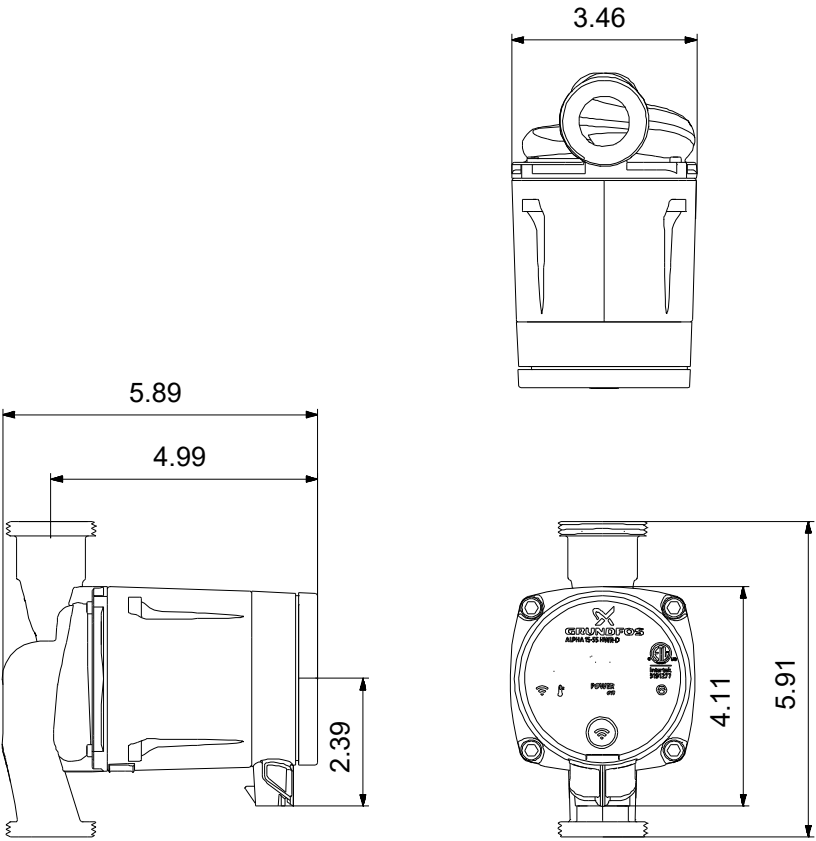

Materials:
Pump housing: Stainless steel
Pump housing: EN 1.4308
Impeller: Composite

Count	Description
1	<p>ALPHAHWR-D 15-55 HWR-D</p>  <p>Product photo could vary from the actual product</p> <p>Product No.: On request</p> <p>The Grundfos ALPHA HWR-D is a high-efficiency, variable speed circulator fitted with electronically commutated motor. Designed for on-demand hot water recirculation systems.</p> <p>The pump is started via a push button, when a demand for hot water is identified within the occupancy. The push button will activate the pump via a wireless signal and will run until the water entering the water piping reaches temperature of 102 °F, as indicated by the external temperature sensor (optional), or has been operating continuously for 5 minutes.</p> <p>The on-demand functionality allows the homeowner to only run the hot water recirculation pump when there is demand, saving thousands of gallons of water a year.</p> <p>This pump is complete with an integrated check-valve.</p> <p>For power connection the pump is delivered with a fixed line cord. The pump communicates wirelessly with push button and temperature sensor making installation simple and intuitive.</p> <p>Liquid: Pumped liquid: Water Liquid temperature range: 35.6 .. 230 °F Selected liquid temperature: 140 °F Density: 61.35 lb/ft³</p> <p>Technical: Actual calculated flow: 12.5 US gpm Resulting head of the pump: 6.742 ft TF class: 110 Approvals on nameplate: ETL, FCC, NSF</p> <p>Materials: Pump housing: Stainless steel EN 1.4308 Impeller: Composite</p> <p>Installation: Range of ambient temperature: 33.8 .. 104 °F Maximum operating pressure: 145.04 psi Pipe connection: 1 1/4 Pressure stage: PN 10 Port-to-port length: 5 15/16 in</p> <p>Electrical data: Power input - P1: 2 .. 45 W Main frequency: 60 Hz Rated voltage: 1 x 115 V Maximum current consumption: 0.02 .. 0.65 A Enclosure class (IEC 34-5): IP42 Insulation class (IEC 85): F</p> <p>Others: Net weight: 5.06 lb Gross weight: 5.76 lb Shipping volume: 0.28 ft³</p>



Company name: Hurley Engineering

Created by:

Phone:**Date:**

4/22/2021

Count	Description
	Country of origin: US Custom tariff no.: 8413.70.2005



On request ALPHAHWR-D 15-55 HWR-D 60 Hz

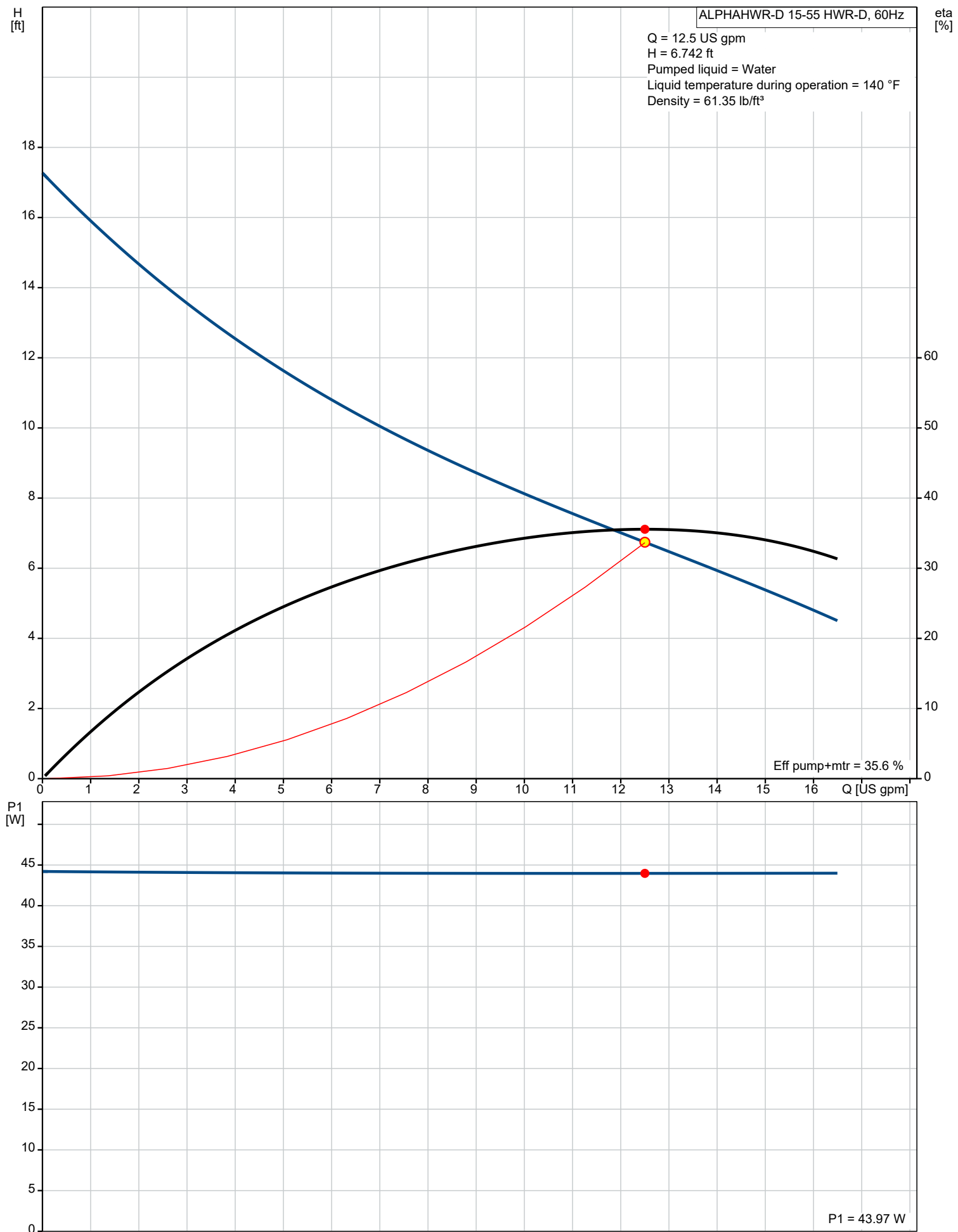

Description	Value
General information:	
Product name:	ALPHAHWR-D 15-55 HWR-D
Product No.:	On request
EAN:	On request
Technical:	
Actual calculated flow:	12.5 US gpm
Resulting head of the pump:	6.742 ft
Head max:	18.05 ft
TF class:	110
Approvals on nameplate:	ETL, FCC, NSF
Materials:	
Pump housing:	Stainless steel
Pump housing:	EN 1.4308
Impeller:	Composite
Installation:	
Range of ambient temperature:	33.8 .. 104 °F
Maximum operating pressure:	145.04 psi
Pipe connection:	1 1/4
Pressure stage:	PN 10
Port-to-port length:	5 15/16 in
Liquid:	
Pumped liquid:	Water
Liquid temperature range:	35.6 .. 230 °F
Selected liquid temperature:	140 °F
Density:	61.35 lb/ft³
Electrical data:	
Power input - P1:	2 .. 45 W
Main frequency:	60 Hz
Rated voltage:	1 x 115 V
Maximum current consumption:	0.02 .. 0.65 A
Enclosure class (IEC 34-5):	IP42
Insulation class (IEC 85):	F
Motor protection:	NONE
Thermal protec:	ELEC
Controls:	
Pos term box:	6H
Others:	
Net weight:	5.06 lb
Gross weight:	5.76 lb
Shipping volume:	0.28 ft³
Sales region:	USA
Country of origin:	US
Custom tariff no.:	8413.70.2005

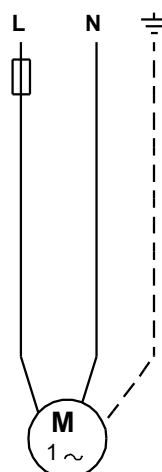
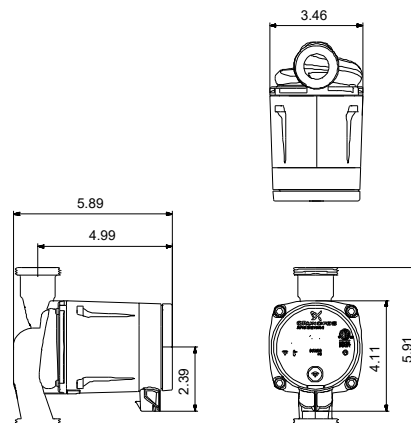
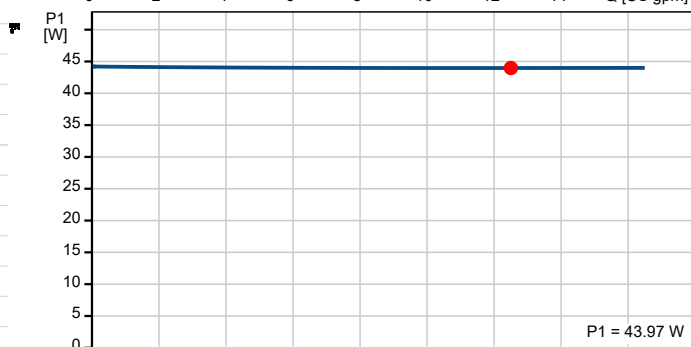
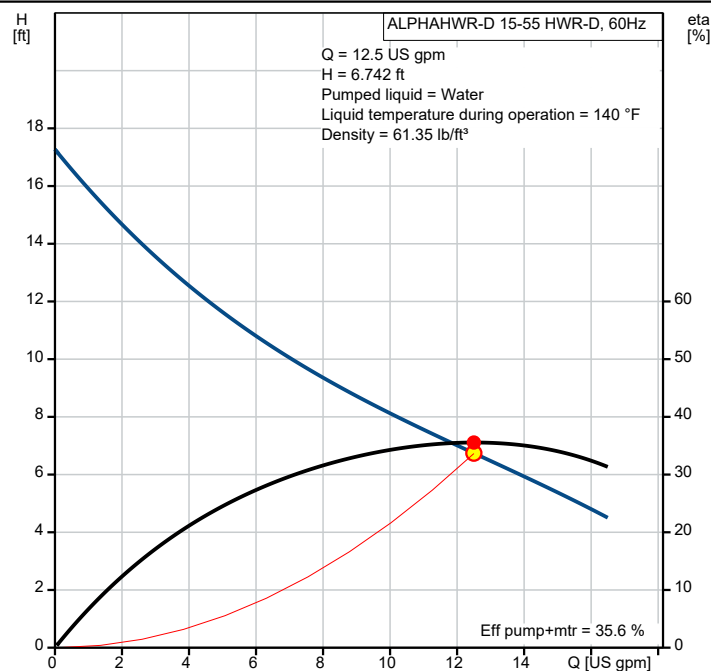

On request ALPHAHWR-D 15-55 HWR-D 60 Hz

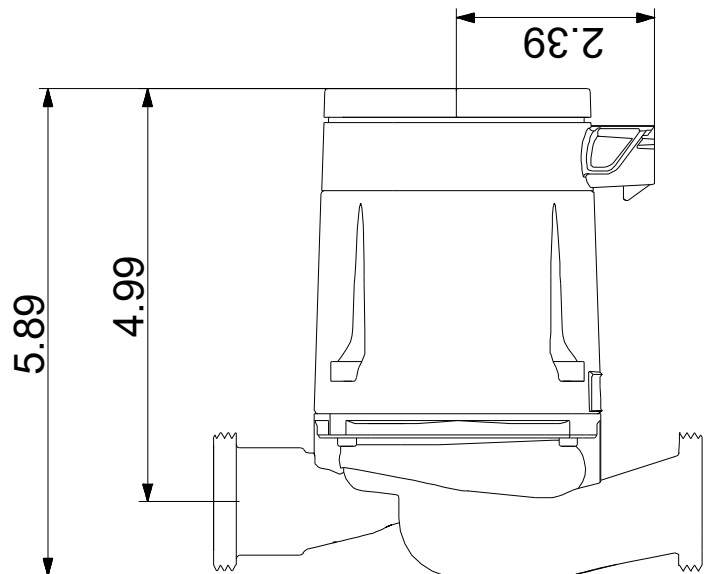
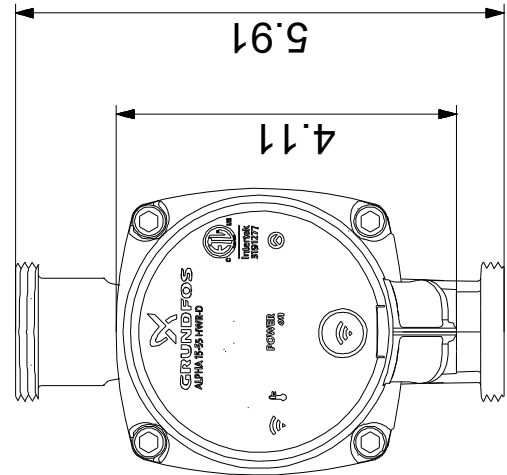
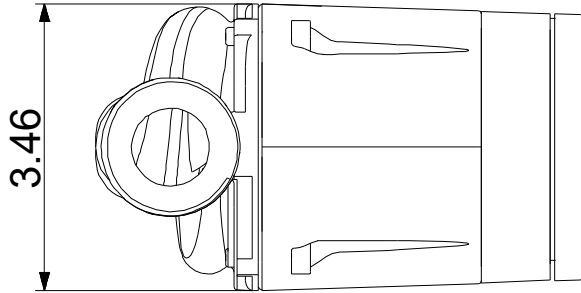

On request ALPHAHWR-D 15-55 HWR-D 60 Hz

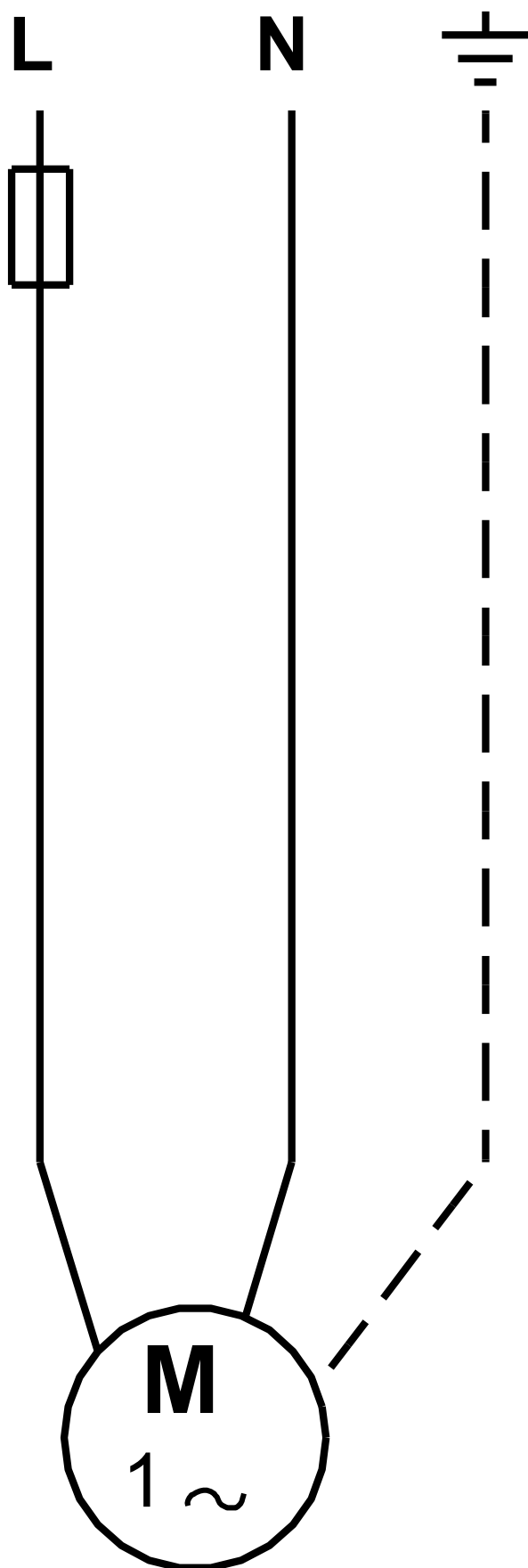



Company name: Hurley Engineering
Created by:
Phone:

Date: 4/22/2021

Order Data:

Product name: ALPHAHWR-D 15-55 HWR-D
Amount: 1
Product No.: On request

Total: Price on request
