

PROJECT:	Circulators	UNIT TAG:	_____	QUANTITY:	1
REPRESENTATIVE:	Hurley Engineering	TYPE OF SERVICE:	Recirculation	DATE:	_____
ENGINEER:	TBD	SUBMITTED BY:	Devin Carle	DATE:	_____
CONTRACTOR:	TBD	APPROVED BY:	_____	DATE:	_____
		ORDER NO.:	_____	DATE:	_____



ALPHAHWR-D 15-55 HWR-D

The ALPHA 15-55 HWR-D is a hot water recirculation pump started via a push button when a demand for hot water is identified within the occupancy. The push button will activate the pump via a Bluetooth signal and will run until the water entering the water piping reaches a temperature of 102°F, as indicated by the external temperature sensor, or has been operating continuously for 5 minutes.

Product photo could vary from the actual product

Conditions of Service		Pump Data		Motor Data	
Flow:	12.5 US gpm	Maximum operating pressure:	145.04 psi	P1 max:	2 .. 45 W
Head:	6.742 ft	Liquid temperature range:	35.6 .. 230 °F	Rated voltage:	115 V
Efficiency:	35.6 %	Maximum ambient temperature:	104 °F	Main frequency:	60 Hz
Liquid:	Water	Approvals:	ETL, FCC, NSF	Enclosure class:	IP42
Temperature:	140 °F	Pipe connection:	1 1/4	Insulation class:	F
NPSH required:	ft	Product number:	On request	Motor protection:	NONE
Specific Gravity:	0.985			Thermal protection:	ELEC

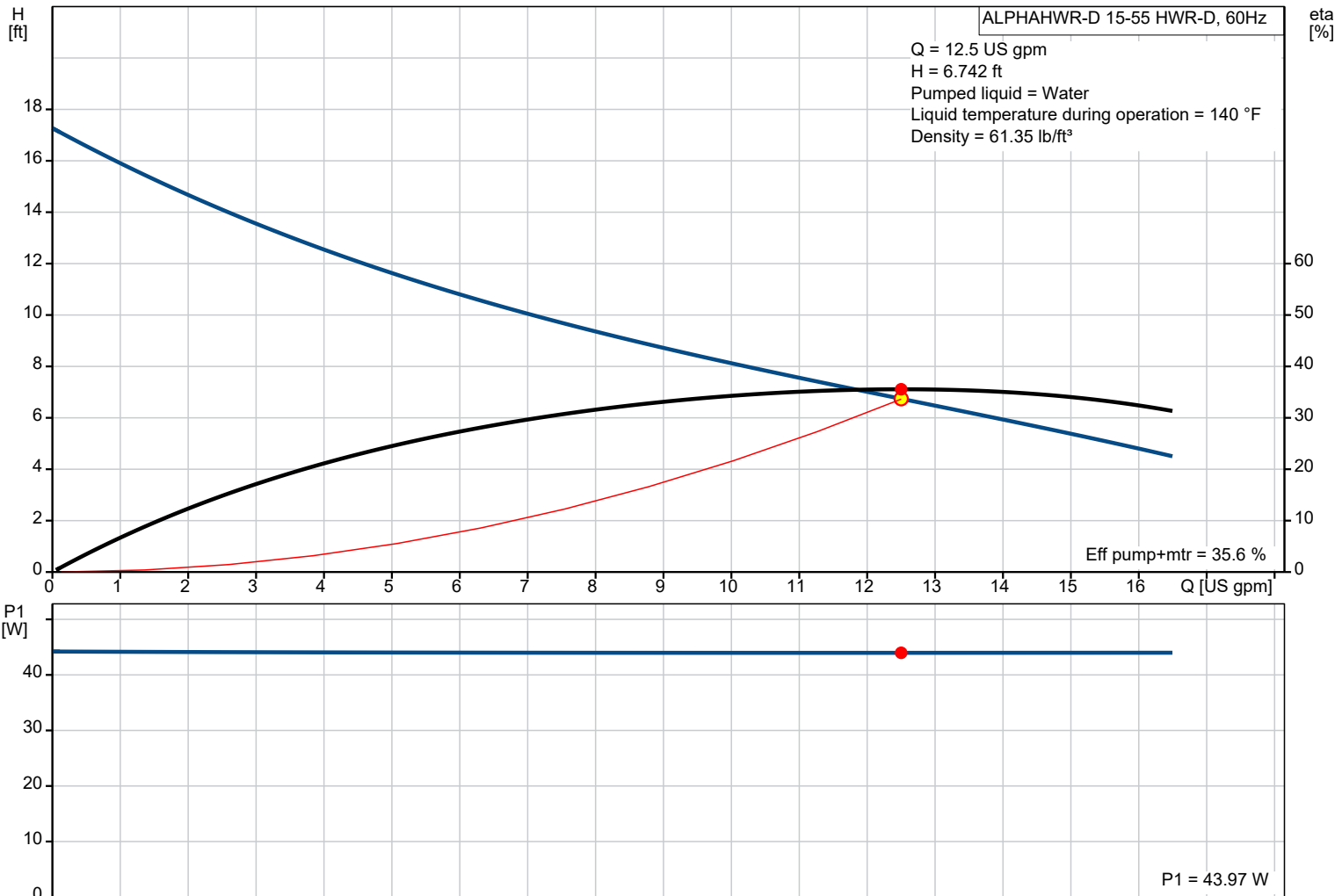

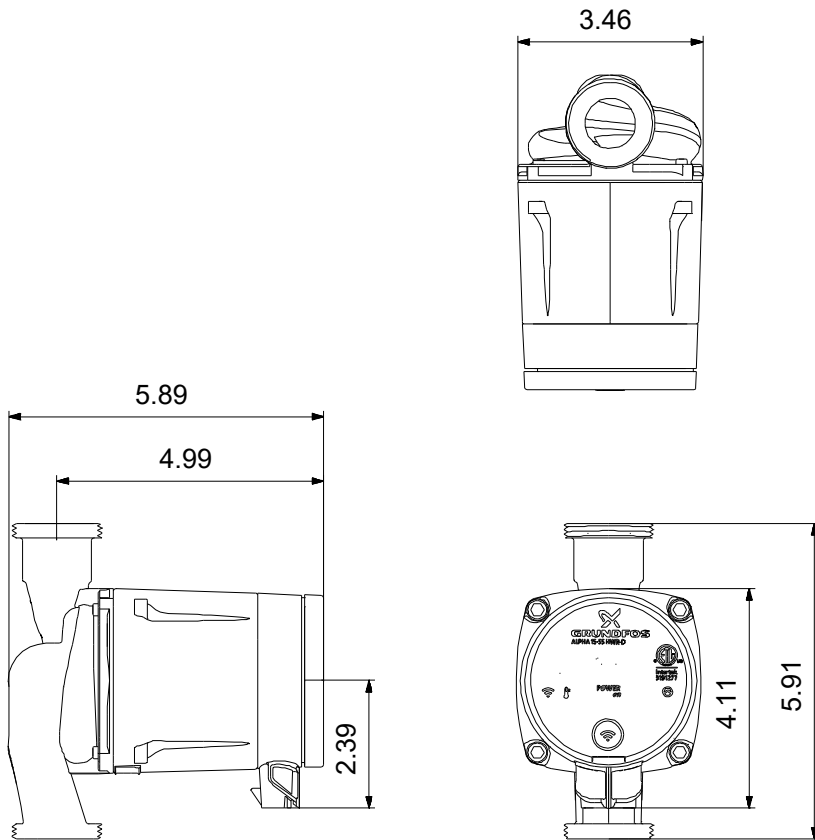

Materials:

- Pump housing: Stainless steel
- Pump housing: EN 1.4308
- Impeller: Composite

Count	Description
-------	-------------

1	ALPHAHWR-D 15-55 HWR-D
---	------------------------



Product photo could vary from the actual product

Product No.: On request

The Grundfos ALPHA HWR-D is a high-efficiency, variable speed circulator fitted with electronically commutated motor. Designed for on-demand hot water recirculation systems.

The pump is started via a push button, when a demand for hot water is identified within the occupancy.

The push button will activate the pump via a wireless signal and will run until the water entering the water piping reaches temperature of 102 °F, as indicated by the external temperature sensor (optional), or has been operating continuously for 5 minutes.

The on-demand functionality allows the homeowner to only run the hot water recirculation pump when there is demand, saving thousands of gallons of water a year.

This pump is complete with an integrated check-valve.

For power connection the pump is delivered with a fixed line cord.

The pump communicates wirelessly with push button and temperature sensor making installation simple and intuitive.

Liquid:

Pumped liquid: Water
 Liquid temperature range: 35.6 .. 230 °F
 Selected liquid temperature: 140 °F
 Density: 61.35 lb/ft³

Technical:

Actual calculated flow: 12.5 US gpm
 Resulting head of the pump: 6.742 ft
 TF class: 110
 Approvals on nameplate: ETL, FCC, NSF

Materials:

Pump housing: Stainless steel
 EN 1.4308
 Impeller: Composite

Installation:

Range of ambient temperature: 33.8 .. 104 °F
 Maximum operating pressure: 145.04 psi
 Pipe connection: 1 1/4
 Pressure stage: PN 10
 Port-to-port length: 5 15/16 in

Electrical data:

Power input - P1: 2 .. 45 W
 Main frequency: 60 Hz
 Rated voltage: 1 x 115 V
 Maximum current consumption: 0.02 .. 0.65 A
 Enclosure class (IEC 34-5): IP42
 Insulation class (IEC 85): F



Company name: Hurley Engineering

Created by:

Phone:

Date:

4/22/2021

Count	Description
-------	-------------

Others:

Net weight: 4.95 lb

Gross weight: 5.6 lb

Shipping volume: 0.28 ft³

Country of origin: US

Custom tariff no.: 8413.70.2005



Company name: Hurley Engineering

Created by:

Phone:

Date:

4/22/2021

On request ALPHAHWR-D 15-55 HWR-D 60 Hz

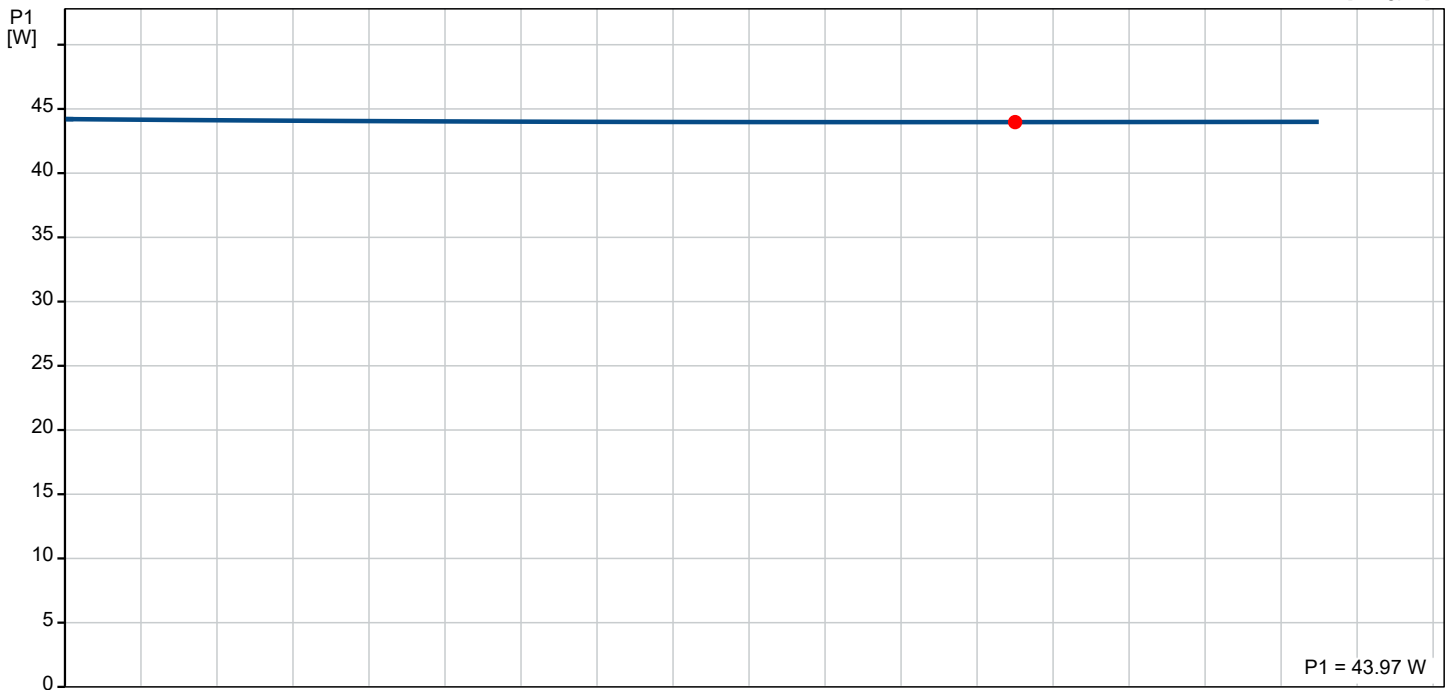
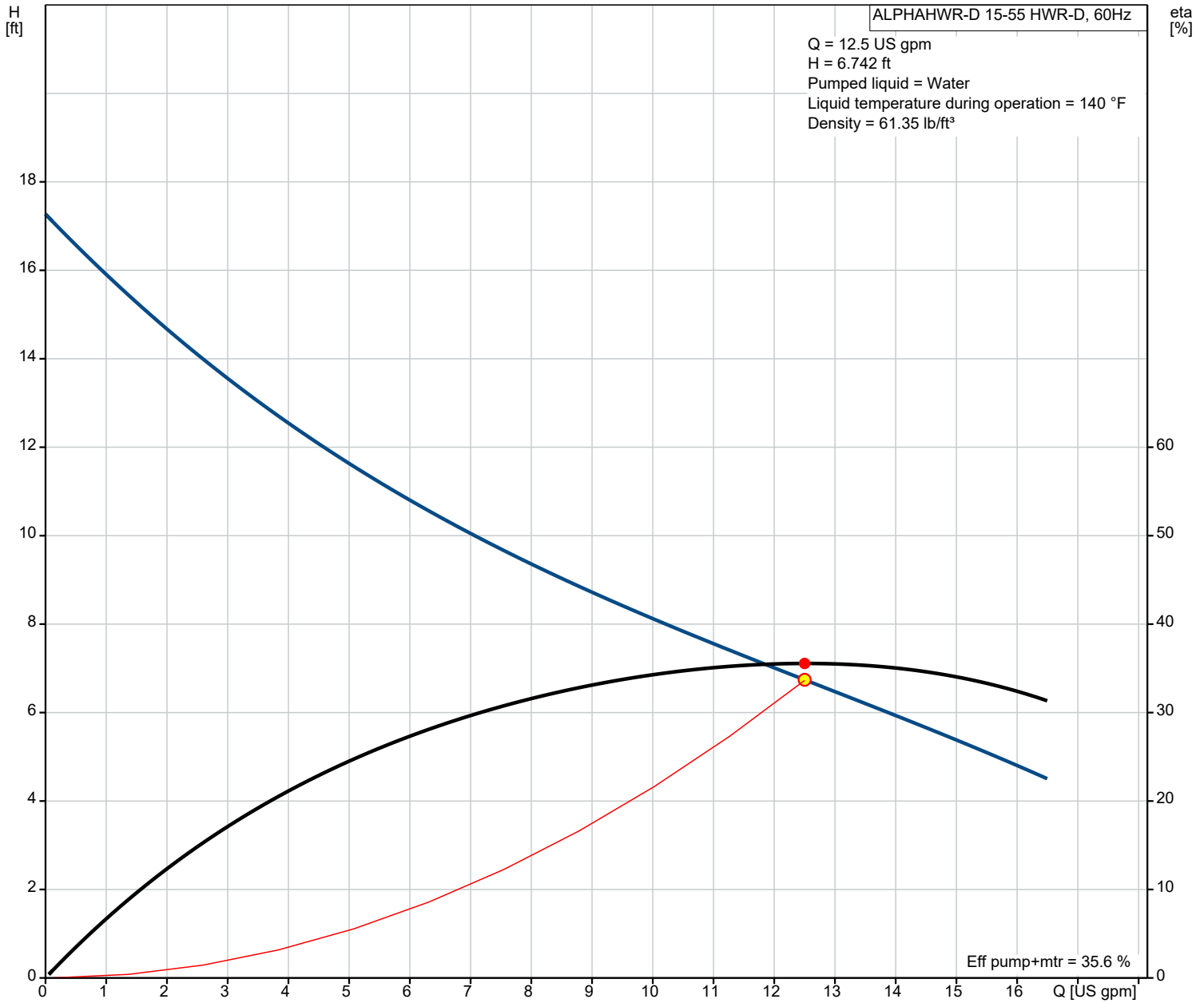

Description	Value
General information:	
Product name:	ALPHAHWR-D 15-55 HWR-D
Product No.:	On request
EAN:	On request
Technical:	
Actual calculated flow:	12.5 US gpm
Resulting head of the pump:	6.742 ft
Head max:	18.05 ft
TF class:	110
Approvals on nameplate:	ETL, FCC, NSF
Materials:	
Pump housing:	Stainless steel
Pump housing:	EN 1.4308
Impeller:	Composite
Installation:	
Range of ambient temperature:	33.8 .. 104 °F
Maximum operating pressure:	145.04 psi
Pipe connection:	1 1/4
Pressure stage:	PN 10
Port-to-port length:	5 15/16 in
Liquid:	
Pumped liquid:	Water
Liquid temperature range:	35.6 .. 230 °F
Selected liquid temperature:	140 °F
Density:	61.35 lb/ft ³
Electrical data:	
Power input - P1:	2 .. 45 W
Main frequency:	60 Hz
Rated voltage:	1 x 115 V
Maximum current consumption:	0.02 .. 0.65 A
Enclosure class (IEC 34-5):	IP42
Insulation class (IEC 85):	F
Motor protection:	NONE
Thermal protec:	ELEC
Controls:	
Pos term box:	6H
Others:	
Net weight:	4.95 lb
Gross weight:	5.6 lb
Shipping volume:	0.28 ft ³
Sales region:	USA
Country of origin:	US
Custom tariff no.:	8413.70.2005

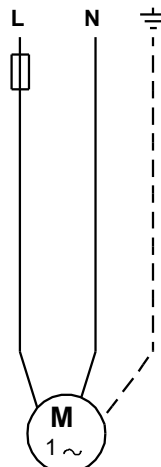
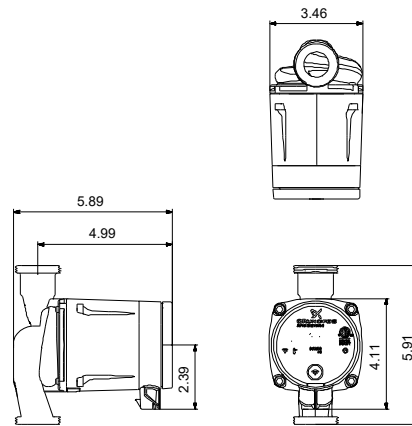
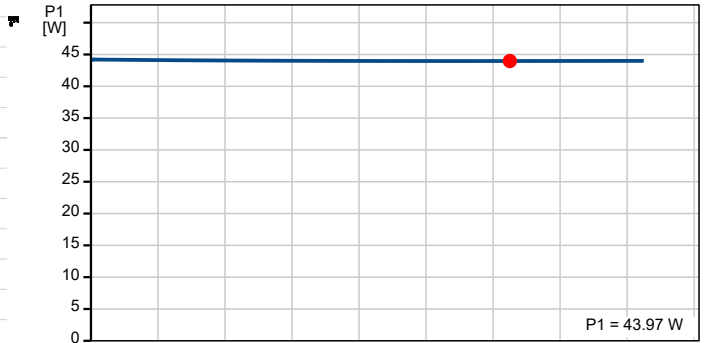
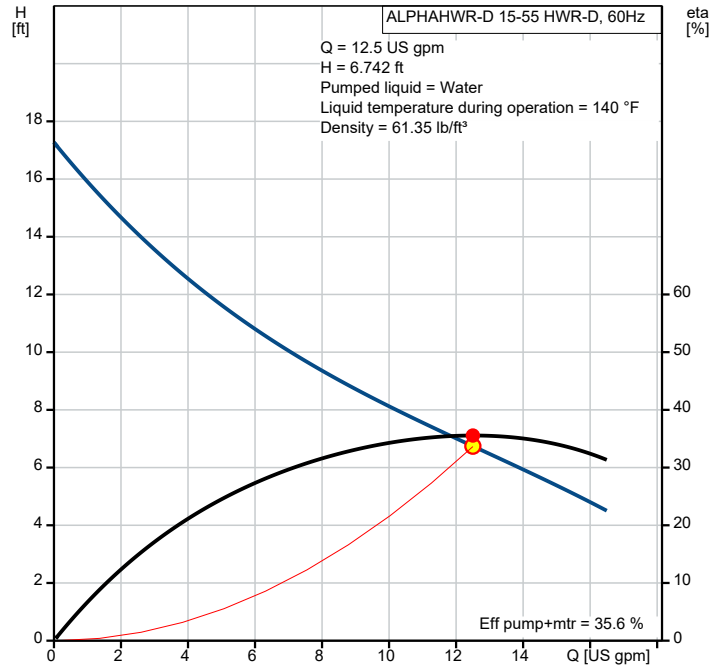

On request ALPHAHWR-D 15-55 HWR-D 60 Hz

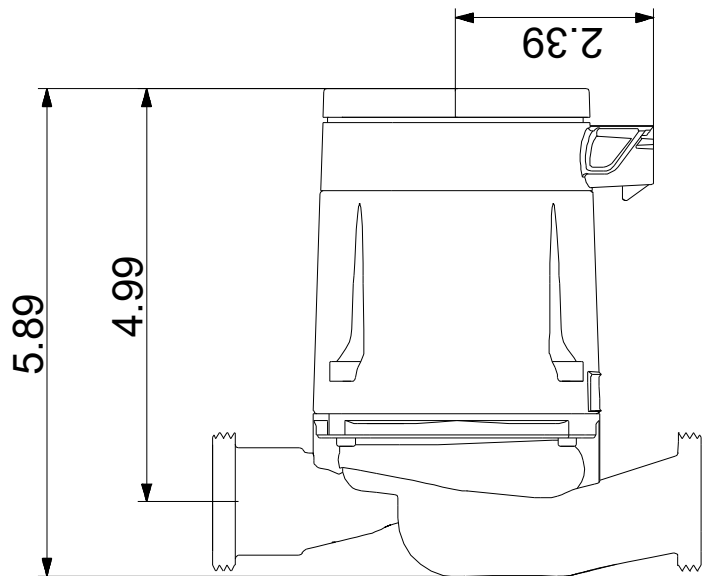
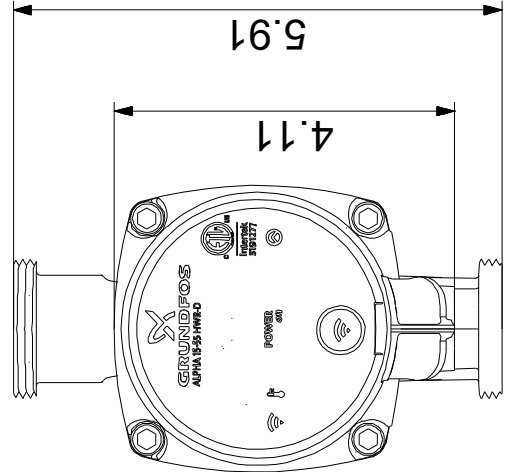
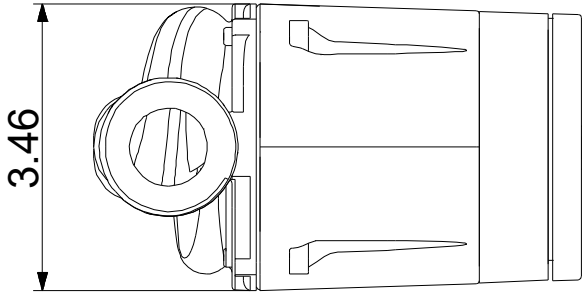

On request ALPHAHWR-D 15-55 HWR-D 60 Hz

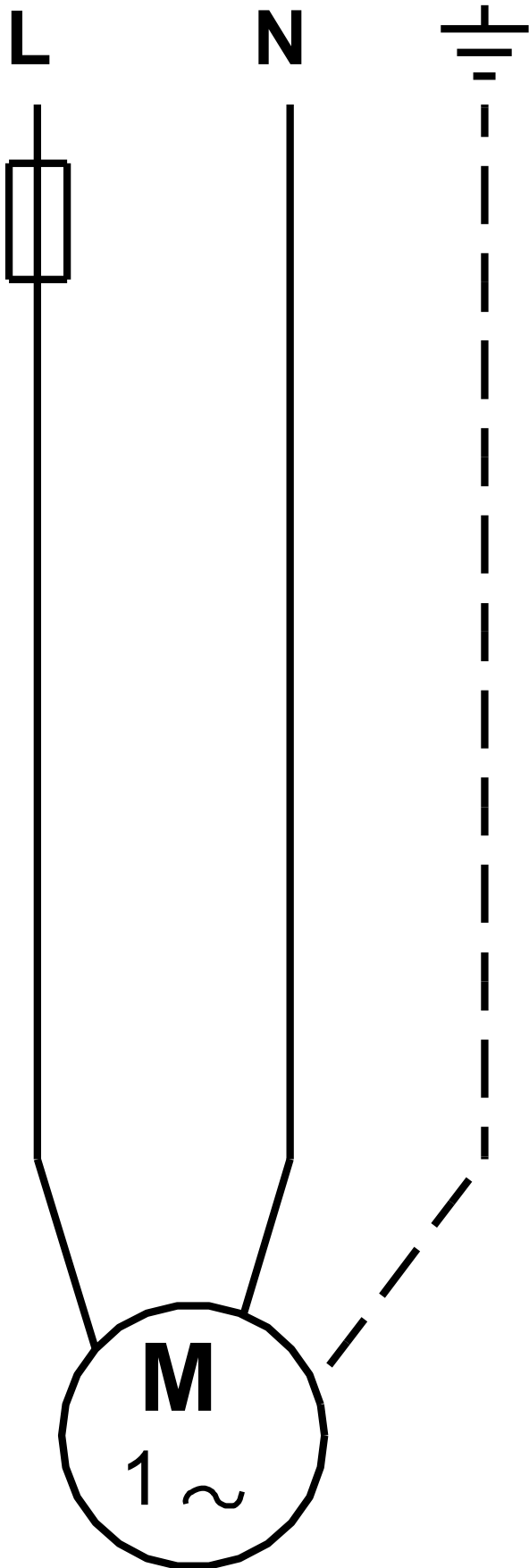



Company name: Hurley Engineering

Created by:

Phone:

Date:

4/22/2021

Order Data:

Product name: ALPHAHWR-D 15-55 HWR-D

Amount: 1

Product No.: On request

Total: Price on request
