

PROJECT:	Circulators	UNIT TAG:		QUANTITY:	1
REPRESENTATIVE:	Hurley Engineering	TYPE OF SERVICE:	Recirculation	DATE:	
ENGINEER:	TBD	SUBMITTED BY:	Devin Carle	DATE:	
CONTRACTOR:	TBD	APPROVED BY:		DATE:	
		ORDER NO.:		DATE:	



ALPHAHWR-D 15-55 HWR-D

The ALPHA 15-55 HWR-D is a wireless push button activated recirculation system that provides comfort in homes with no need for a return line or electricity under the sink. System includes line cord, two (2) activation push buttons, four (4) thermal bypass valves, four (4) hose kits, and one (1) set of 3/4" bronze union isolation valves fittings.

Product photo could vary from the actual product

Conditions of Service		Pump Data		Motor Data	
Flow:	12.5 US gpm	Maximum operating pressure:	145.04 psi	P1 max:	2 .. 45 W
Head:	6.742 ft	Liquid temperature range:	35.6 .. 230 °F	Rated voltage:	115 V
Efficiency:	35.6 %	Maximum ambient temperature:	104 °F	Main frequency:	60 Hz
Liquid:	Water	Approvals:	ETL, FCC, NSF	Enclosure class:	IP42
Temperature:	140 °F	Pipe connection:	1 1/4	Insulation class:	F
NPSH required:	ft	Product number:	On request	Motor protection:	NONE
Specific Gravity:	0.985			Thermal protection:	ELEC

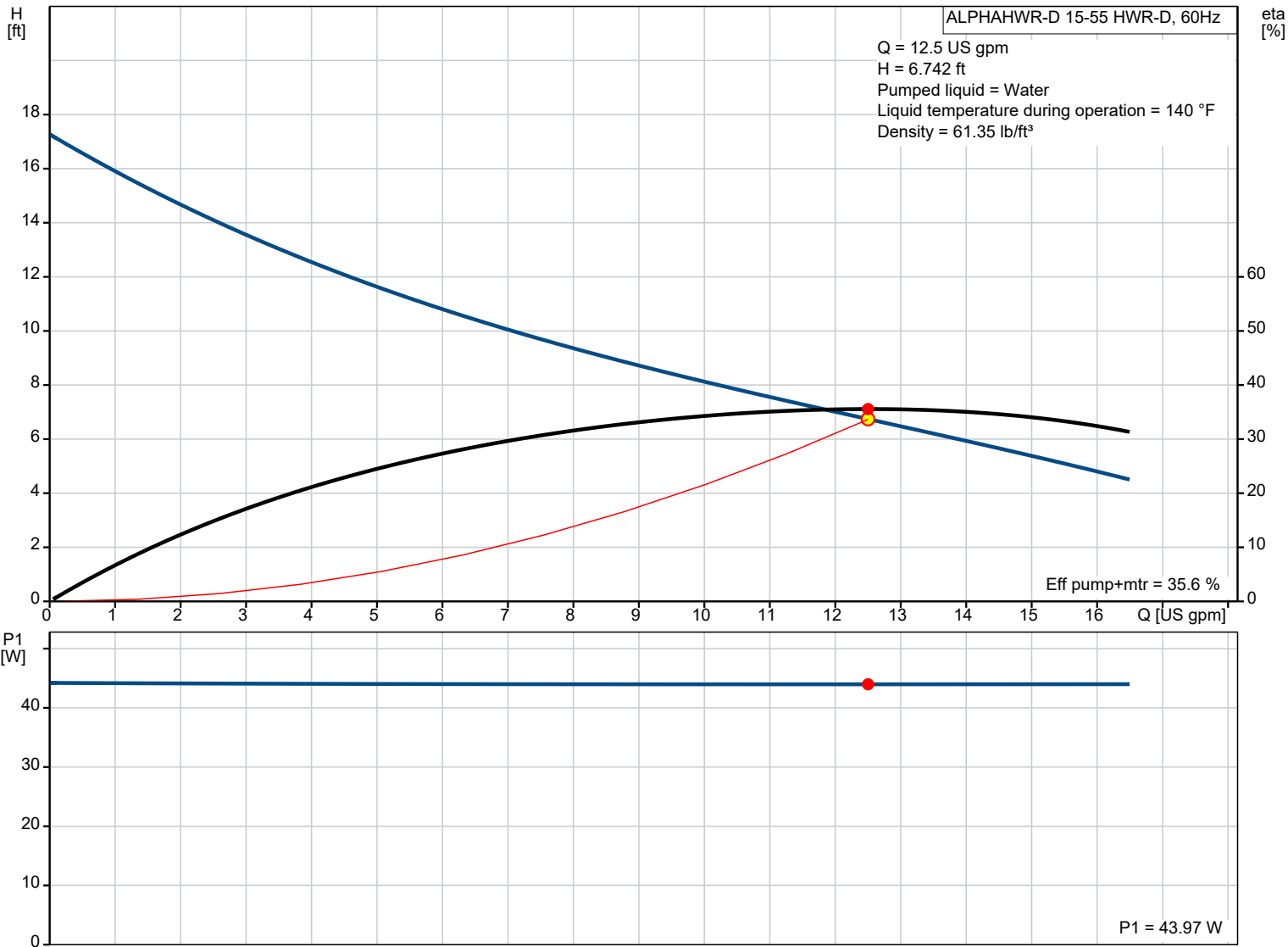

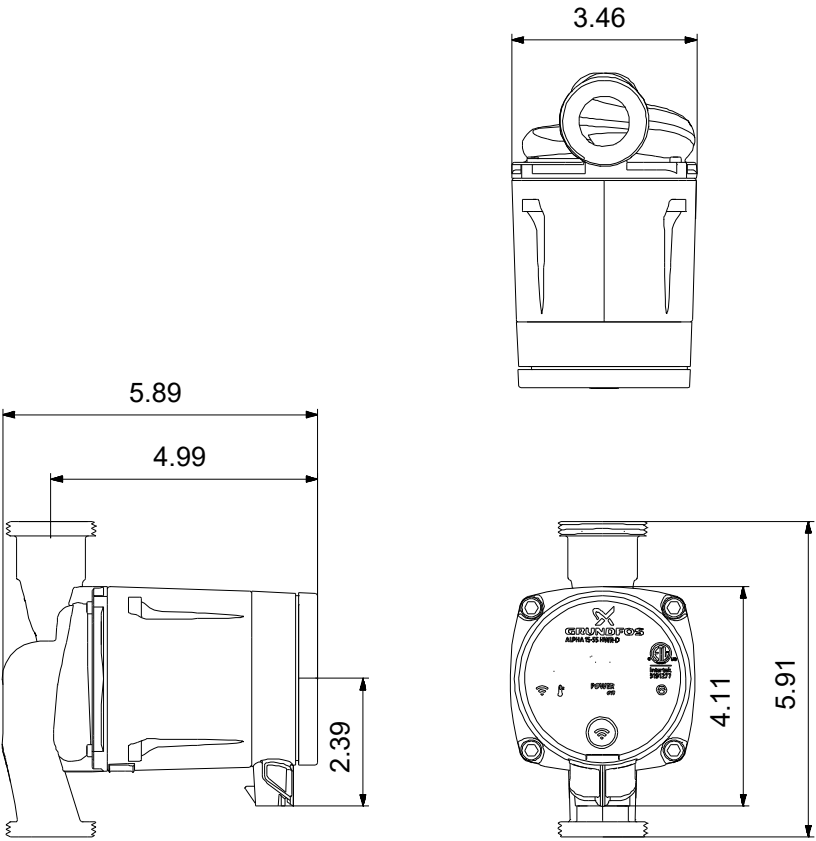

**Materials:**  
Pump housing: Stainless steel  
Pump housing: EN 1.4308  
Impeller: Composite

Count	Description
1	<div><div><div></div><div><p>Product photo could vary from the actual product</p></div></div><p>Product No.: On request</p><p>The ALPHA 15-55 HWR-D COMFORT is a hot water recirculation system to provide comfort in homes with no need for return line or electricity under the sink.</p><p>The ALPHA 15-55 HWR-D COMFORT starts via remote activation push button when there is a demand for hot water. The push button will start the pump via a Bluetooth signal and will circulate hot water until the water entering the COMFORT Valve reaches a temperature of 102 °F or has been operating continuously for 5 minutes.</p><p>System includes line cord, two (2) activation push buttons, four (4) thermal bypass valves, four (4) hose kits, and one (1) set of 3/4" bronze union isolation valves fittings.</p></div>



On request ALPHAHWR-D 15-55 HWR-D 60 Hz

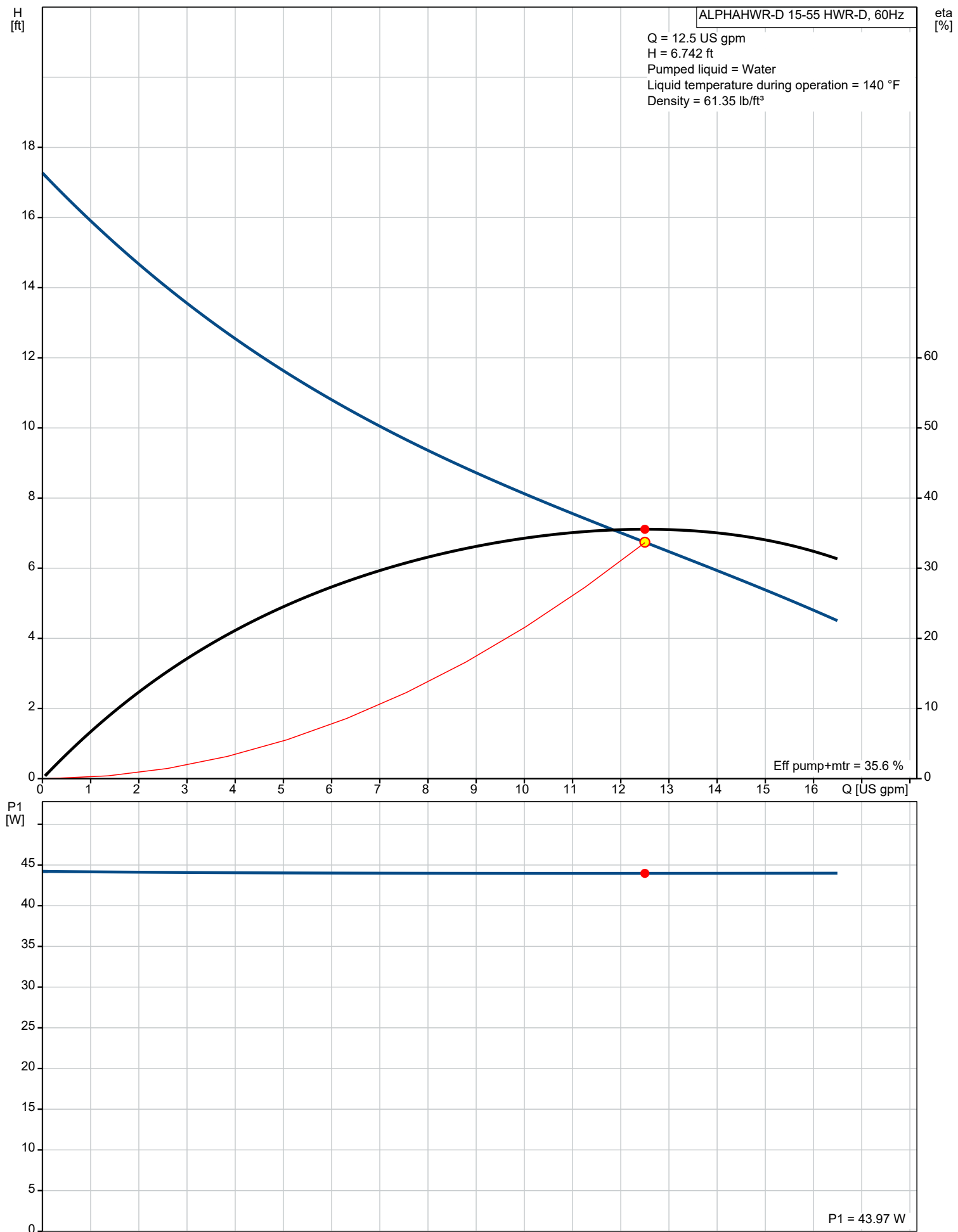

Description	Value
<b>General information:</b>	
Product name:	ALPHAHWR-D 15-55 HWR-D
Product No.:	On request
EAN:	On request
<b>Technical:</b>	
Actual calculated flow:	12.5 US gpm
Resulting head of the pump:	6.742 ft
Head max:	18.05 ft
TF class:	110
Approvals on nameplate:	ETL, FCC, NSF
<b>Materials:</b>	
Pump housing:	Stainless steel
Pump housing:	EN 1.4308
Impeller:	Composite
<b>Installation:</b>	
Range of ambient temperature:	33.8 .. 104 °F
Maximum operating pressure:	145.04 psi
Pipe connection:	1 1/4
Pressure stage:	PN 10
Port-to-port length:	5 15/16 in
<b>Liquid:</b>	
Pumped liquid:	Water
Liquid temperature range:	35.6 .. 230 °F
Selected liquid temperature:	140 °F
Density:	61.35 lb/ft³
<b>Electrical data:</b>	
Power input - P1:	2 .. 45 W
Main frequency:	60 Hz
Rated voltage:	1 x 115 V
Maximum current consumption:	0.02 .. 0.65 A
Enclosure class (IEC 34-5):	IP42
Insulation class (IEC 85):	F
Motor protection:	NONE
Thermal protec:	ELEC
<b>Controls:</b>	
Pos term box:	6H
<b>Others:</b>	
Net weight:	12.7 lb
Gross weight:	13.1 lb
Shipping volume:	0.28 ft³
Sales region:	USA
Country of origin:	US
Custom tariff no.:	8413.70.2005

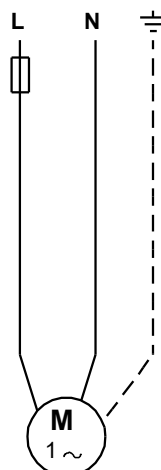
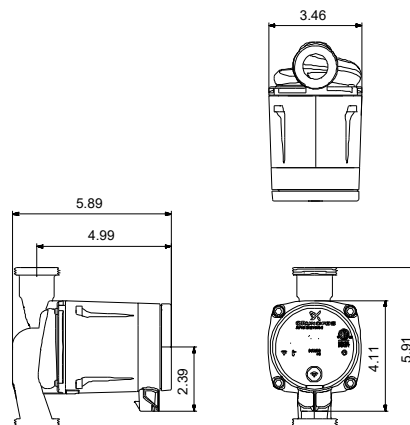
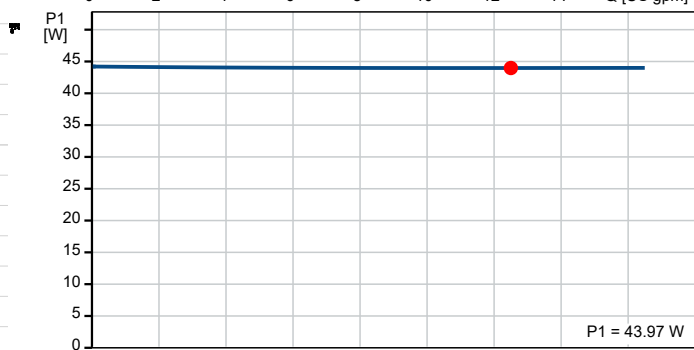
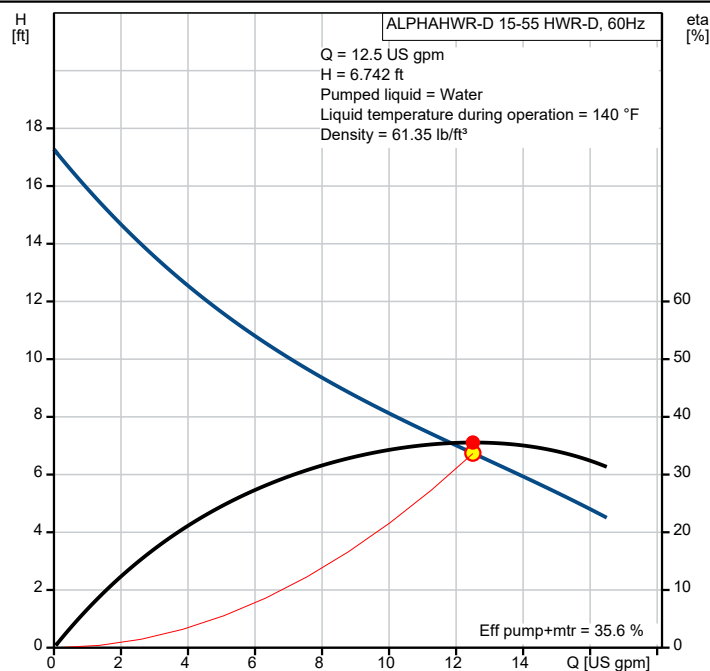

## On request ALPHAHWR-D 15-55 HWR-D 60 Hz

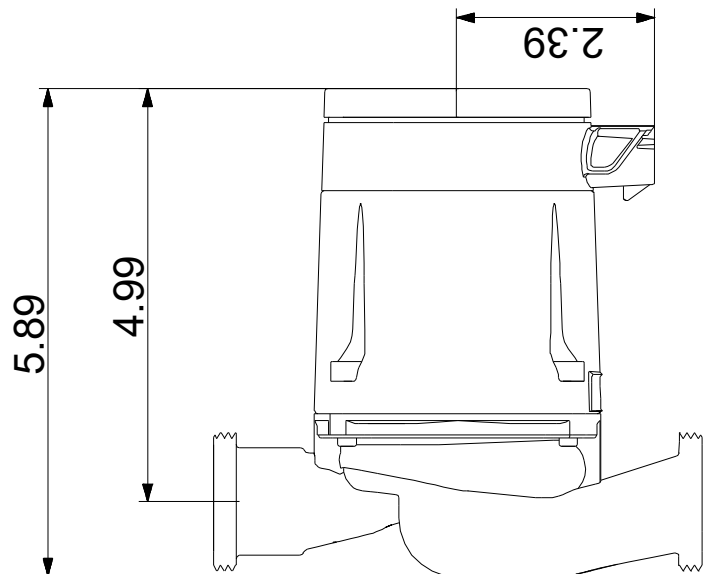
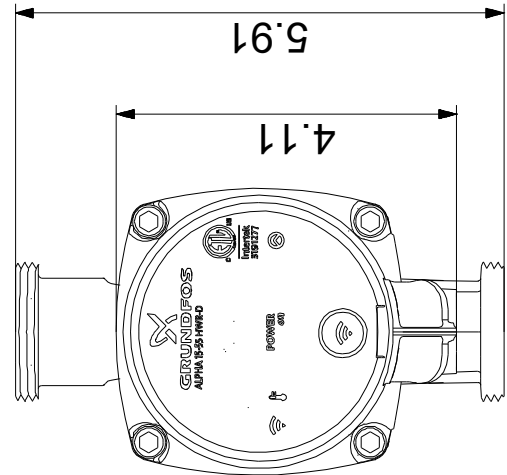
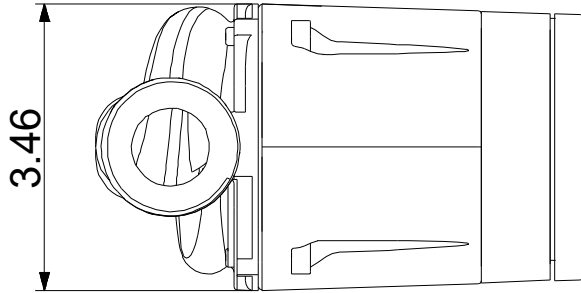

On request ALPHAHWR-D 15-55 HWR-D 60 Hz

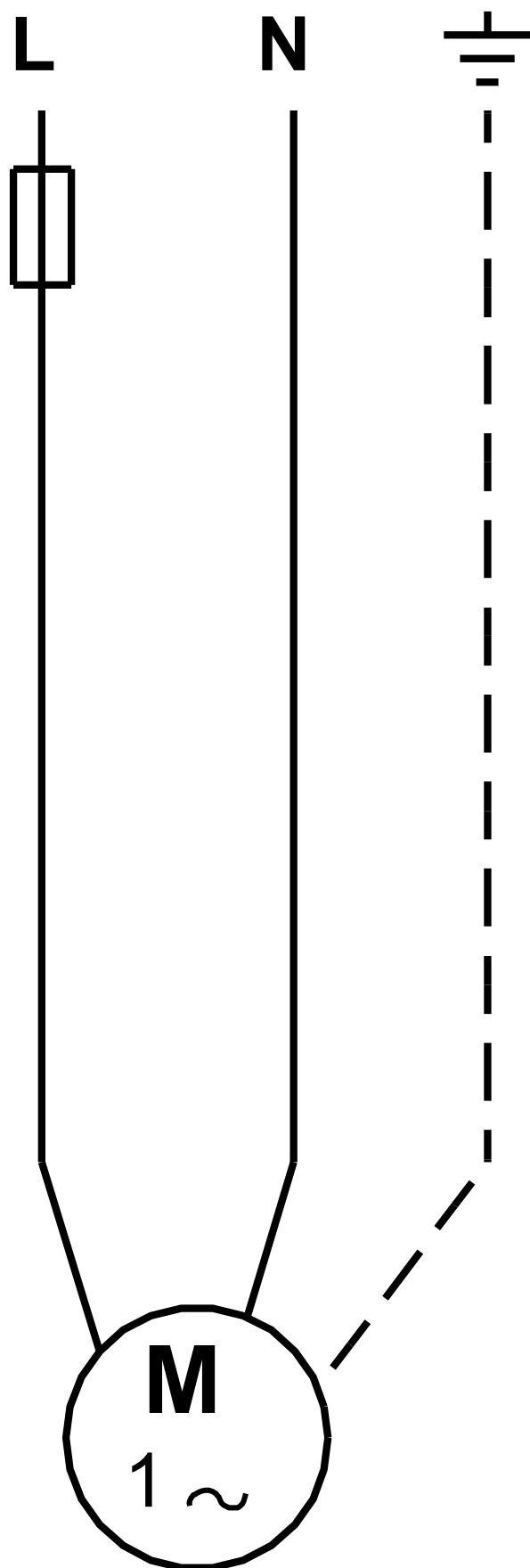



**Company name:** Hurley Engineering

**Created by:**

**Phone:**

**Date:**

4/22/2021

---

**Order Data:**

Product name: ALPHAHWR-D 15-55 HWR-D

Amount: 1

Product No.: On request

Total: Price on request

---