

**Southeast Pump & Equipment, Inc.****02/01/21****SweepCLEAR/Standard TAS/AV Pricing - 300#**

PART NUMBER	AS tank SIZE	Tank Diameter, Inches	Tank Height, Inches	TOTAL SALE PRICE		TOTAL WEIGHT, #
TAS-STD-300#-02	2	12	19	\$2,234		51
TAS-STD-300#-02.5	2.5	12	19	\$2,381		56
TAS-STD-300#-03	3	12	19	\$2,782		66
TAS-STD-300#-04	4	14	29	\$3,703		109
TAS-STD-300#-05	5	14	29	\$4,121		133
TAS-STD-300#-06	6	20	41	\$5,876		240
TAS-STD-300#-08	8	20	41	\$7,134		338
TAS-STD-300#-10	10	30	58	\$9,880		689
TAS-STD-300#-12	12	30	58	\$12,170		811
TAS-STD-300#-14	14	36	76	CF		1159
TAS-STD-300#-16	16	48	100	CF		2777
TAS-STD-300#-18	18	54	116	\$36,914		3339
TAS-STD-300#-20	20	60	130	CF		4990
TAS-STD-300#-24	24	72	152	CF		8434

CF - CONSULT FACTORY

## Notes:

- 1.) Pressure Drop - 2' TDH or less
- 2.) Can be piped "Inline" or Offset
- 3.) Prices Subject to Change Without Notice
- 4.) PRICE INCLUDES TAS, SWEEPCLEAR MEDIA, AUTO AIR VENT
- 5.) PRICE DOES NOT INCLUDE INSTALLATION
- 6.) ASME CODE TANKS, 300# RATING, FLANGED CONNECTION, SOLID TOP
- 7.) Manufactured in accordance with Section VIII of the ASME Boiler and Pressure Vessel Code

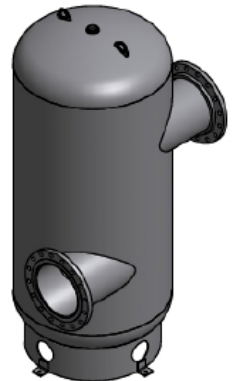

[www.southeastpump.com](http://www.southeastpump.com)  
[sales@southeastpump.com](mailto:sales@southeastpump.com)  
 678.990.1388

[www.sweepclear.com](http://www.sweepclear.com)  
[sales@sweepclear.com](mailto:sales@sweepclear.com)  
 (678) 458-6906