



## EXTRA-DUTY WEATHER RESISTANT PANEL MOUNT HOUSING (M8)

Designed for wet or damp locations, Extra-Duty M8 Thru-View® Housings allow customers to plug items into their customized GracePort® and close the cover to provide in-use protection against rain and moisture.

The NEC recognizes that most residential in-use receptacle covers are not suitable for commercial and industrial usage. In these applications they describe an industrial in-use cover as extra-duty. Built for long life, the industrial M8 extra-duty housing fits this need.

The extra-duty in-use cover requirement applies to devices plugged into 15-20 Amp/125-250Volt receptacles in wet or damp locations unattended by the worker. Wet locations are subject to routine high pressure spray then a standard UL Type 4/4X Thru-View® should be used.

### MOUNTING DIMENSIONS INCHES (MM)

HOUSING CODE	WEIGHT (OZ)	A	B	C	D	EØ
M8	17.6	4.80 ± .010 (122.0 ± .2)	3.15 ± .010 (80.0 ± .2)	5.83 ± .004 (148.0 ± .1)	2.76 ± .004 (70.0 ± .1)	.26 ± .010 (6.5 ± .2)

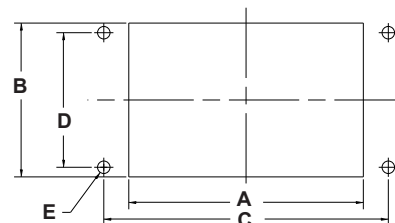

### OVERALL DIMENSIONS INCHES (MM)

HOUSING CODE	F	G	H	I	K	L	MØ	NØ
M8	6.50 (165.0)	3.78 (96.0)	5.02 (127.6)	4.59 (116.7)	9.03 (229.4)	0.57 (14.4)	.45 .20 (11.5 5.2)	.26 ± .004 (6.5 ± .1)

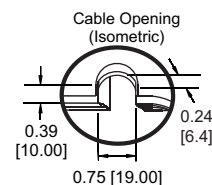
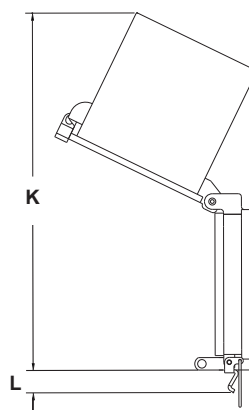
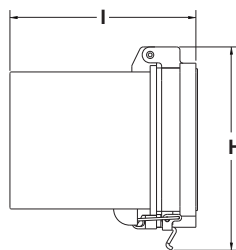
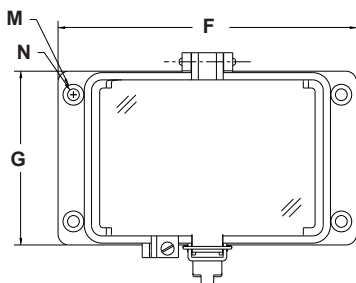

### Don't see what you're looking for?

Contact us at [sales@grace-eng.com](mailto:sales@grace-eng.com), call 1-800-280-9517 or visit [www.graceport.com](http://www.graceport.com) to chat with our customer service.

FOR MORE INFORMATION VISIT [GRACEPORT.COM](http://GRACEPORT.COM) OR CALL 1.800.280.9517

Warning: Verify an electrical conductor has been de-energized using an adequately rated test instrument before working on it. Follow appropriate Energy Control (Lockout/Tagout) procedures as per OSHA Subpart S.

© Grace Engineered Products, Inc. All rights reserved. Specifications are subject to change with/without notice.



Certification based on final product.

GP-M8-DS-EN 2006