

NOTE:
 BOTTOM LAYER OF INSULATION SHALL BE LAID DOWN IN
 A STAGGERED PROFILE. STAGGER AND OFFSET TOP LAYER
 OF INSULATION FROM BOTTOM LAYER TO PREVENT
 ALIGNED EDGES.

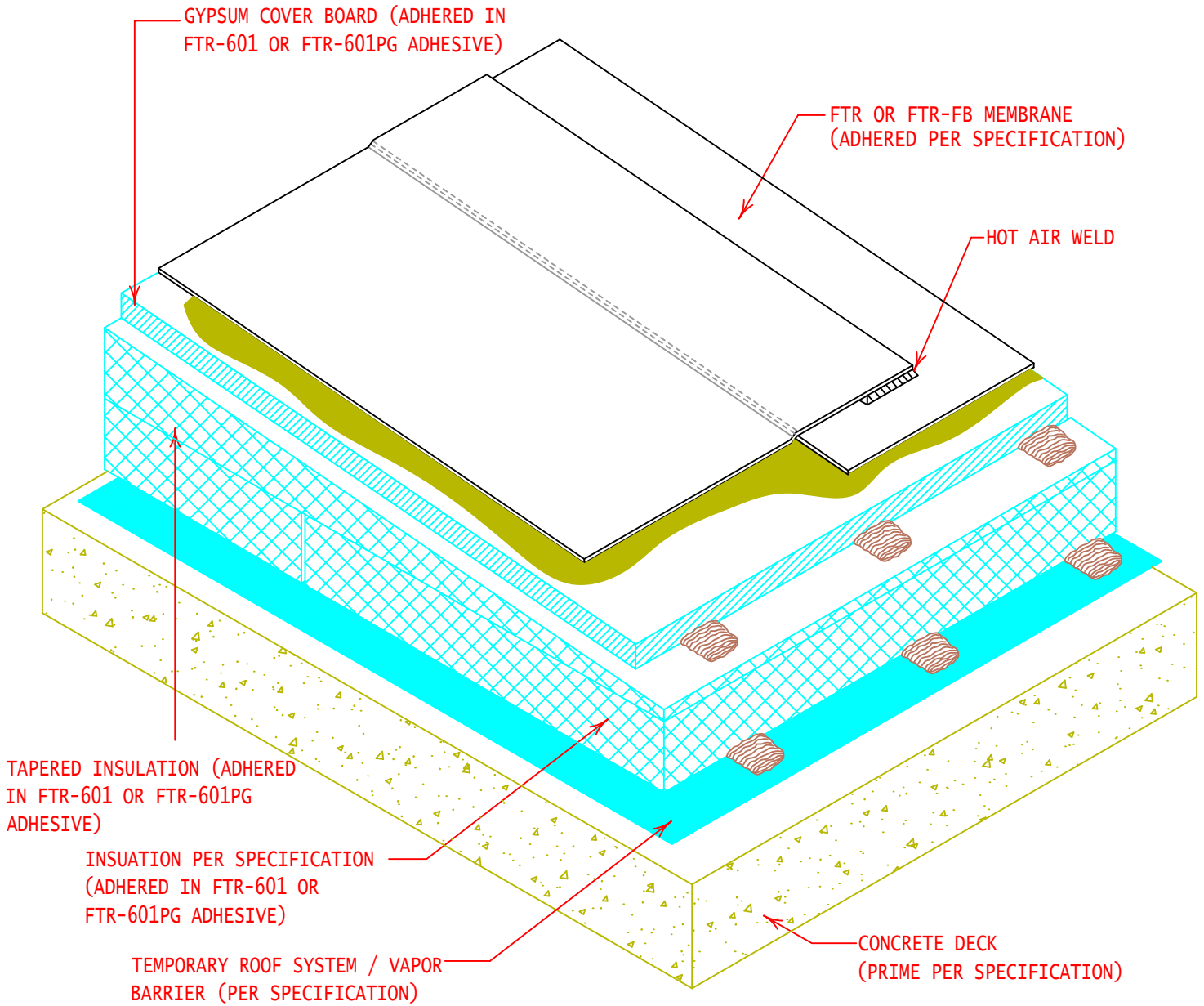

GENERAL REFERENCE:
 "FTR GS 01/21"
 APPLICABLE SYSTEMS:
 "FTR AD 01/21"

TAPERED ROOF SYSTEM CROSS SECTION
 WITH COVERBOARD

REVISES DETAIL	ISSUE DATE	DRAWING NUMBER
ALL PREVIOUS	10-14-21	FTR-DAS2b