

NOTE:  
BOTTOM LAYER OF INSULATION SHALL BE LAID DOWN IN  
A STAGGERED PROFILE. STAGGER AND OFFSET TOP LAYER  
OF INSULATION FROM BOTTOM LAYER TO PREVENT  
ALIGNED EDGES.

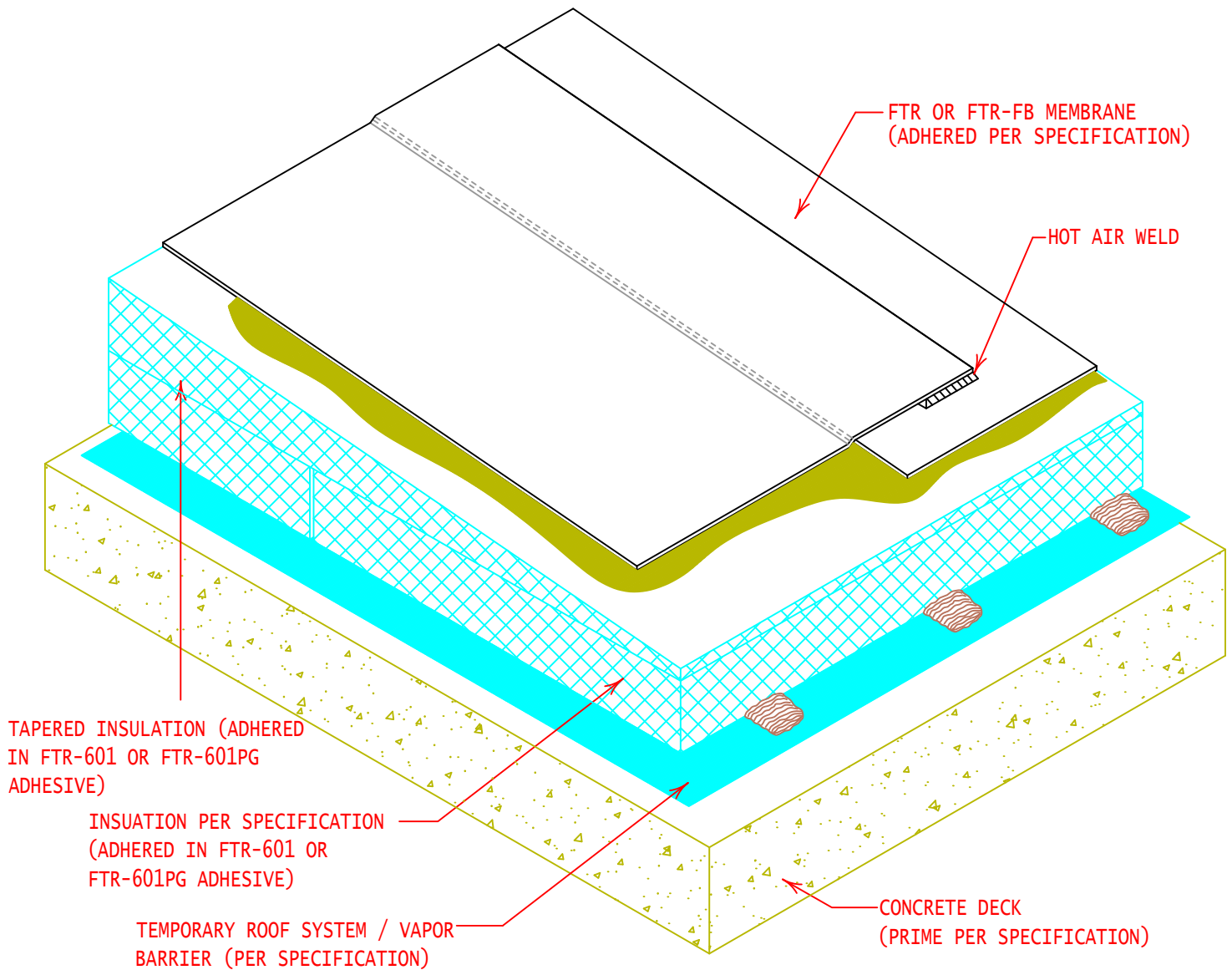

GENERAL REFERENCE:  
"FTR GS 01/21"  
APPLICABLE SYSTEMS:  
"FTR AD 01/21"

### TAPERED ROOF SYSTEM CROSS SECTION WITH COVERBOARD

REVISES DETAIL  
ALL PREVIOUS

ISSUE DATE  
03-15-21

DRAWING NUMBER  
FTR-DAS2c