

**NOTE:**  
 BOTTOM LAYER OF INSULATION SHALL BE LAID DOWN IN  
 A STAGGERED PROFILE. STAGGER AND OFFSET TOP LAYER  
 OF INSULATION FROM BOTTOM LAYER TO PREVENT  
 ALIGNED EDGES.

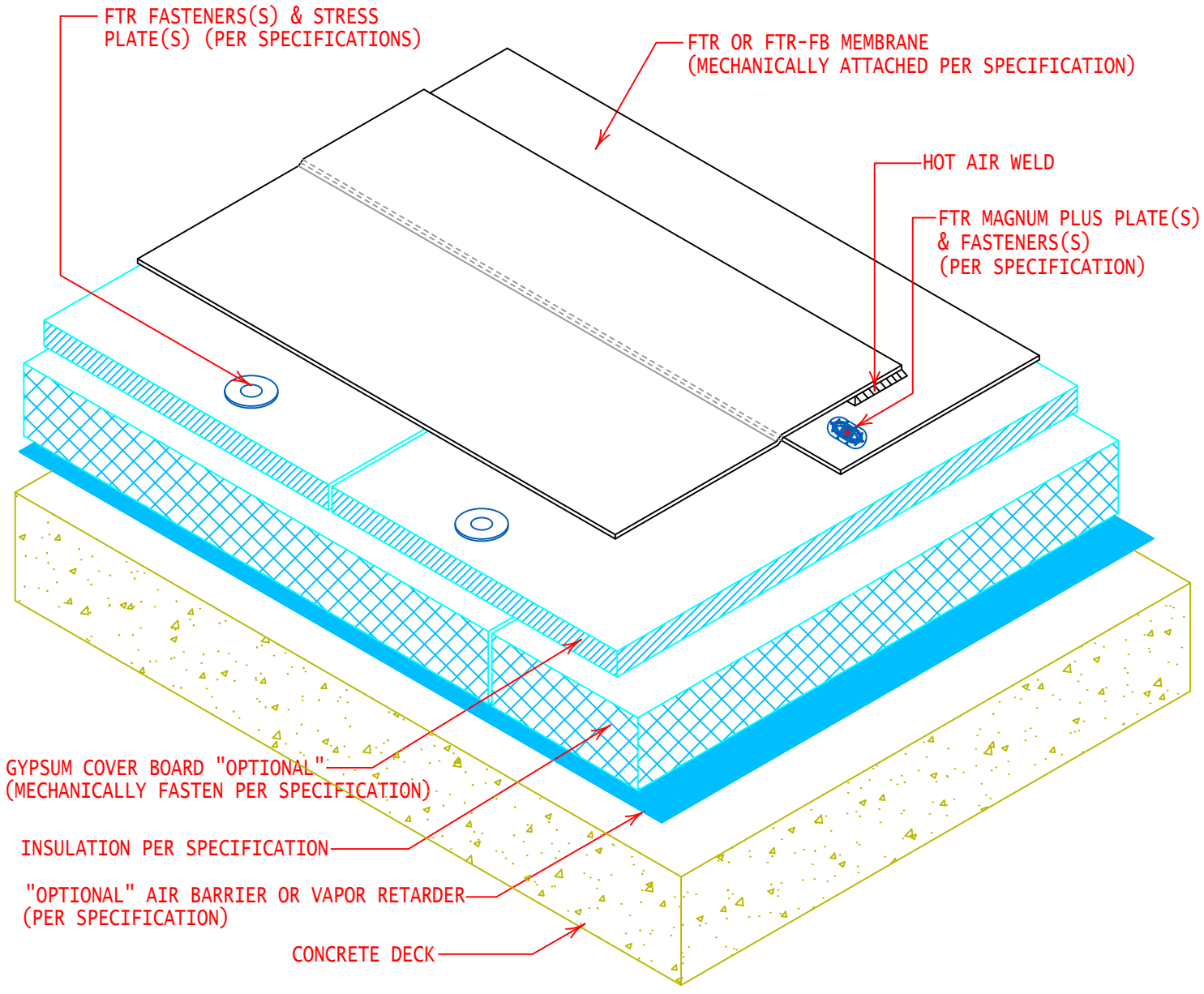

GENERAL REFERENCE: <b>"FTR GS 01/21"</b>		
APPLICABLE SYSTEMS: <b>"FTR MA 01/21"</b>		
<b>CONCRETE ROOF SYSTEM CROSS SECTION          (MECHANICALLY FASTENED SYSTEM)</b>		
REVISES DETAIL	ISSUE DATE	DRAWING NUMBER
<b>ALL PREVIOUS</b>	<b>03-15-21</b>	<b>FTR-DMFS1a</b>