

FiberTite U-Anchor™ Installation

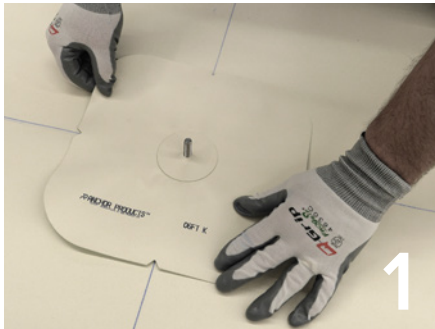

FiberTite U-Anchors are to be installed by FiberTite Authorized Applicators according to specific project engineering requirements. The surface of the FiberTite Roofing Membrane shall be clean, dry and free of any debris that could contaminate the welding of the FiberTite U-Anchor flashing.



1

Tools & Equipment:

- FiberTite 1400, 2400 & 3400 U-Anchors
- Tape measure
- Lumber crayon for marking grid points
- Chalk line with blue chalk
- FiberTite Seam Cleaner
- Clean cotton rags
- Hand held hot air welder, extension cords and appropriate power source
- 2-in Silicone Roller

for Steel Decks:

FiberTite #15 Magnum fasteners of appropriate length to properly engage structural decking
Required fastener lengths may vary per location

for Structural Concrete:

- FiberTite #14 HD Fasteners
- Hammer drill
- 3/16-in carbide drill bit

for Wood Decking:

- FiberTite #14 HD Fasteners
- Screw gun with #3 Phillips bits



2

1. Determine placement of individual FiberTite U-Anchors by transferring project engineering drawings to the previously installed FiberTite Roofing System using a blue chalk line grid. Align the FiberTite U-Anchor plate to the grid using the V-Notches in the flashing to center the plate for placement.

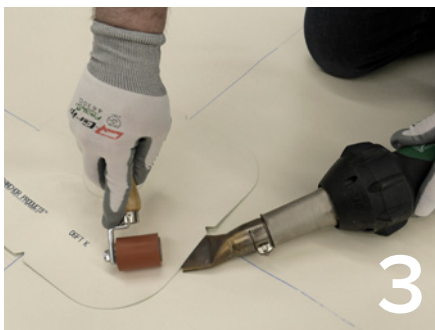

3

2. Install the specified number and location of FiberTite fasteners through the plate and into the structural decking according to the design specifications.

Fasteners shall be installed perpendicular to the decking and engage the structure as follows:

- | | |
|-----------------------------|---|
| Steel Decking: | Minimum ¾-in through the decking |
| Structural Concrete: | Minimum 1-in embedment into the decking |
| Wood Decking: | Minimum 1-in into or ¾-in through the decking |

Once fastened, clean the surface of the roof membrane beneath the FiberTite U-Anchor flashing with FiberTite Seam Cleaner.



4

3. Hot air-weld the perimeter of the FiberTite U-Anchor target flashing to the FiberTite Roofing Membrane maintaining a minimum 1.5-in continuous weld.

4. Complete the installation process by probing the perimeter of the flashing to ensure continuity of the weld.