

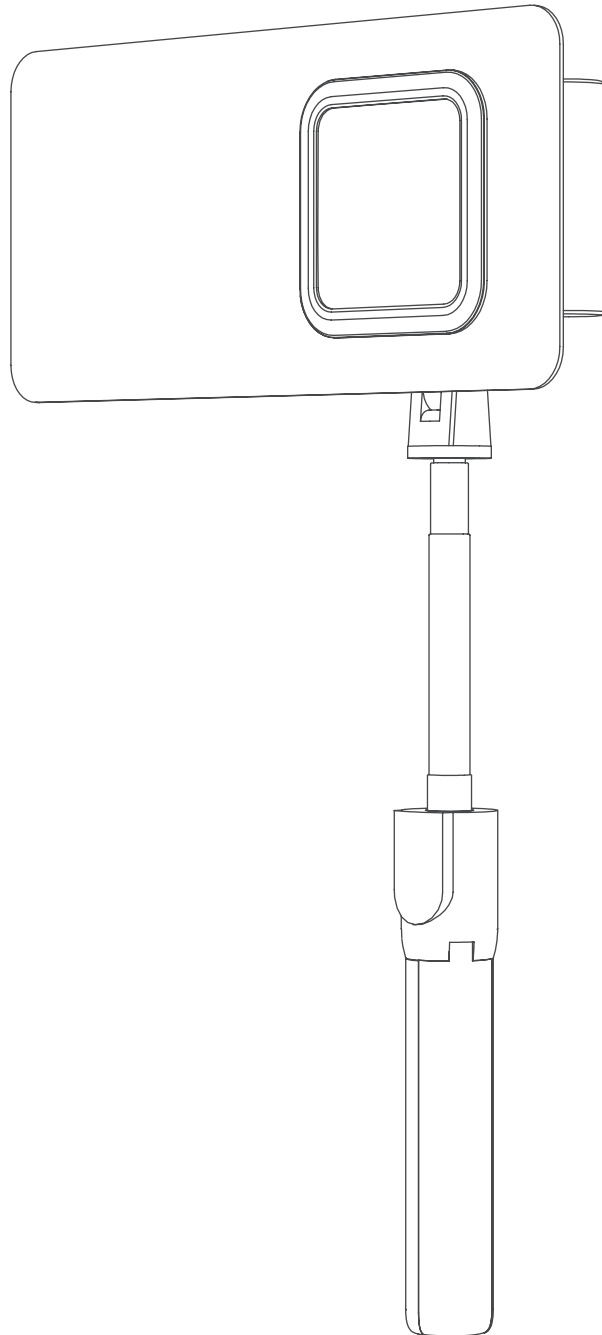





Backstage Pass with Selfie Stick

Assembly Instructions

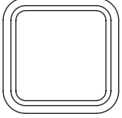

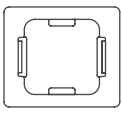
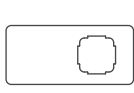
Keep the packaging box
for the return shipment.

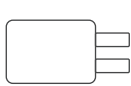
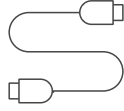
Parts List

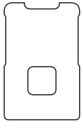
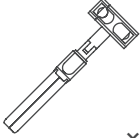
Front Gasket	Device	Back Gasket	Signage	Battery Pack	Wall Plug	Charging Cable	Rubber Band
 ×1	 ×1	 ×1	 ×1	 ×1	 ×1	 ×1	 ×1
 ×1	 ×1						

Installation Steps

- 1** Attach front gasket to the device (a) and insert it into the signage (b). Secure the device and signage by attaching the back gasket (c).

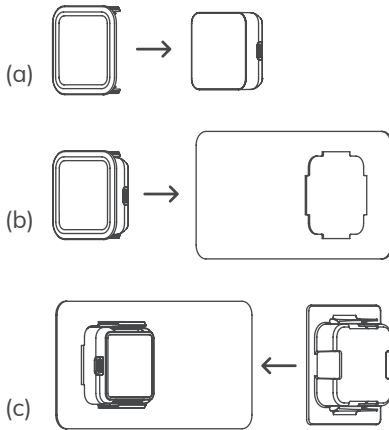

- 2** Pull out rubber cap from the battery pack and plug it into the device.

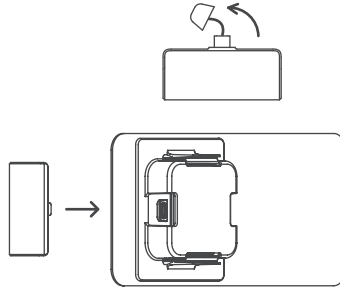

- 3** Pull the rubber band to widen it and wrap around the battery pack and back gasket.

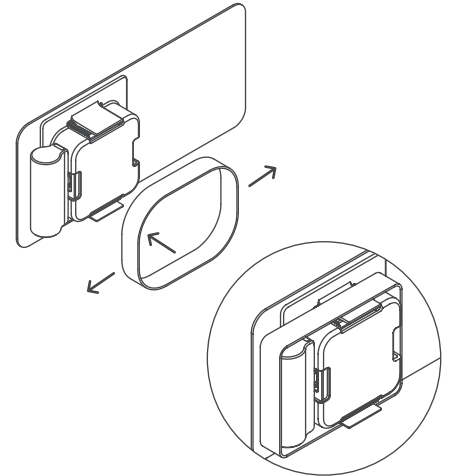

- 4** Peel off double sided tape covers on the back plate and attach it at the back gasket.

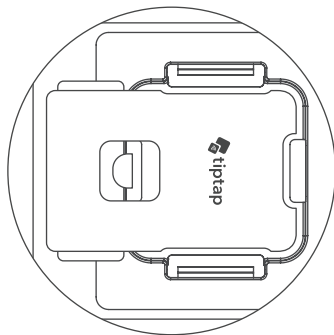

- 5** Unfold the selfie stick, pull out the ridged gasket clamps to make a room, and insert selfie stick inbetween. Once the selfie stick is secured, you may tilt and rotate the signage as you like.

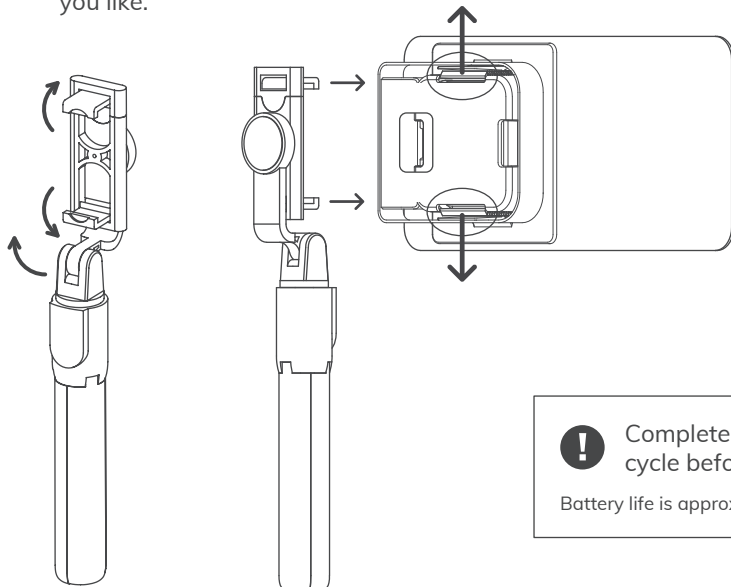

Complete a full charge cycle before use.

Battery life is approximately 10 hours.

Return Shipping

Once the program has ended, pack the original contents in the box it arrived in and affix the return shipping label provided to the outside of the box. If you have misplaced the shipping label please email support@tiptappay.com and we will happily email you a replacement.