



INSTALLATION INSTRUCTION



GENOTEK

C-WE AND CK-WE CEILING EXPANSION JOINT COVER

The following installation instructions are very important. Read them carefully, and be sure you understand them completely before you begin any work.

STORAGE & HANDLING

Upon receipt, this product should be stored in the horizontal position in a clean, dry location. This is a finished product. Store this product in a protected area.

INSTALLATION

1. Cut the aluminum frames to the desired length.
2. For ceiling to ceiling system (C-WE), place frames snugly against the inside corner of the main tees with the recessed slots visible (see Figure 1). For ceiling to wall system (CK-WE), place the recessed wall frame against the adjacent wall making sure the bottom of the frame is level with the frame at the tee (see Figure 2). Transfer the location of the bottom edge of the recessed frame to the wall using a marker.

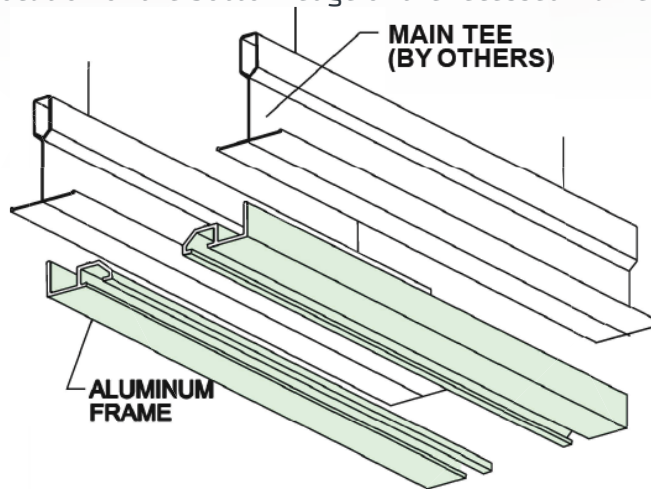

FIGURE 1

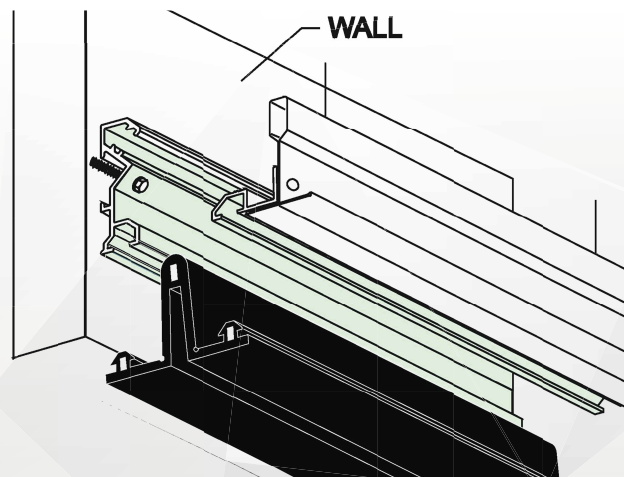

FIGURE 2



C-WE AND CK-WE CEILING EXPANSION JOINT COVER

- Secure the frames to the tees with pop rivets (installer supplied) approximately 50 cm. on center starting 15 cm. from each end (see Figure 3). For ceiling to wall system, secure the frames with pop rivets/ hardware (installer supplied). Press the EPDM seal into the recessed slots of the frames until the seal is flush with the bottoms of the frames.

NOTE: To assist in installing the seal, apply a mist of soapy water solution to the back of the seal. A 25 mm wide seam roller may be used to fully engage the seal ears into the frame slots.

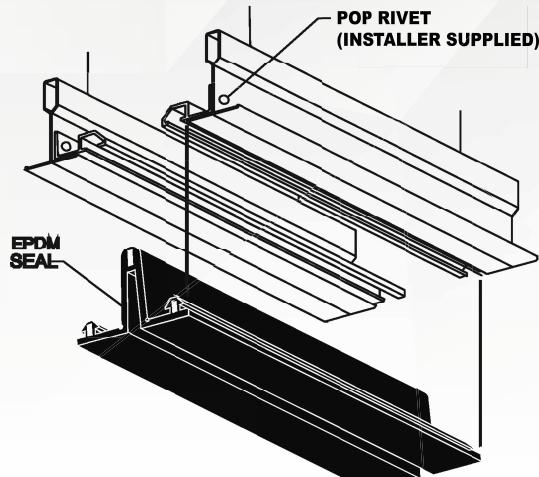

FIGURE 3

- Install ceiling tiles and clean the exposed surfaces (see Figure 4).

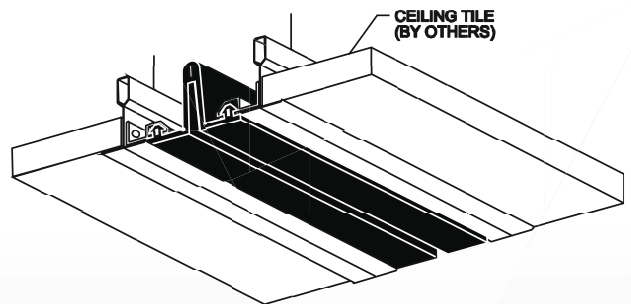
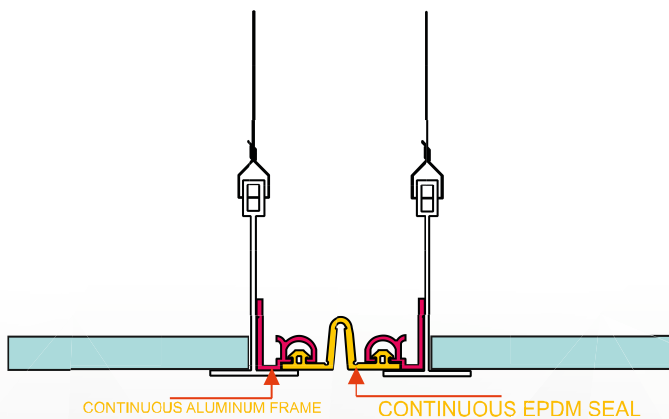

FIGURE 4