



## D-1100 & DK-1100 THERMAL SURFACE MOUNT WALL & CEILING SYSTEMS



### PRODUCT DESCRIPTION

The D - 1100 Expansion Joint Cover is an ideal Cover for Surface Mounted Wall to Wall and Ceiling to Ceiling Applications.

The Series is suitable for areas where Thermal Movements are required and can be used in renovation as well as new construction projects.

The components of the D-1100 cover are:

- Extruded Aluminium Surface Mount Support Profiles.
- Elastomeric Rubber Inserts which absorb the Expansion and Contraction in the adjacent concrete slabs.

The D - 1100 is an Aluminium + Rubber Expansion Joint Cover Profile.

The Elastomeric Rubber Insert of the Profile comes in four standard colours. It is easily replaceable in case of wear and tear.

The Elastomeric Rubber Insert comes in a Smooth finish in order to eliminate any dirt, dust or water accumulation, thus assuring of a Hygienic and Easy to Clean Surface.

The Extruded Aluminium Frames are designed to provide a minimal bump in a Surface Mounted Application.

### RECOMMENDED FOR

- Interior Areas with Small Joint Gaps.
- Areas of Retrofit Application.

### TECHNICAL DATA

#### Support Profiles

The Aluminium profiles are extruded using one of the multiple Aluminium alloys and tempers.

The selection of the Aluminium grade depends on the use case of the profile.

Aluminium grade AA 6063 is the preferred choice for most profiles.

#### Elastomeric Rubber Insert

Material: Thermoplastic Elastomer or Ethylene Propylene Diene Monomer.

Hardness: 60 - 70 ShoreA (ASTM D 2240).

Finish: Grooved Finish. Smooth Finish Elastomeric Rubber can be provided for Areas where Hygiene is of importance.

Colors: Black, Beige, Grey and White.



## D-1100 & DK-1100 THERMAL SURFACE MOUNT WALL & CEILING SYSTEMS

### Optional: Vapour Barrier

Material	Ethylene Propylene Diene Monomer.
Color	Black.
Tensile Strength	1431 psi - ASTM D 412.
Tear Resistance (lbf/in.)	204 - ASTM D 624.
Puncture Resistance (lbf)	60 at 4.49" - ASTM E 154.

### STORAGE & HANDLING

#### ALUMINIUM

##### • Transportation

Aluminium can be damaged during transport and constitutes in the form of scratches and wear marks that can lead to subsequent interfacial corrosion. Such damage prevents satisfactory surface treatment of the profiles.

The appearance of Aluminium is affected by minor transportation damages to the surface of the material but mechanical properties of the metal, however, remain unaffected.

To prevent such damage to the material, it is important for the Aluminium profiles to be packaged in strong paper, plastic or bubble wrap during any moving and transportation to prevent individual profile surfaces from bumping against each other thus causing scratches.

##### • Storage

It is important to note that Aluminium gets easily affected by water and moisture.

Aluminium alloys with higher magnesium content are sensitive to water and condensation, whereas purer alloys have greater resistance to the same.

Moisture damage to Aluminium appears as white patches/spots or dark discolouration marks and can be observed in the event if water or condensation is trapped between Aluminium profile stacked upon or lying very close to each other.

#### EPDM

##### • Storage

The storage temperature must remain below 25° C.

There should be no direct heat sources in the storage area.

The seals should not be exposed to direct sunlight.

The seals must be protected from the effects of ozone and ionizing radiation.

The seals must be stored so as to avoid their being under tensile stress.

### SUBSTRATE REQUIREMENT & PREPARATION

- The surface must have enough clearance from the reinforcement to provide enough space for the anchor.
- The surface must be level with a Maximum Tolerance of +/- 2 mm to provide the best Aesthetic Finish.
- The Gap must be level with a Maximum Tolerance of +/- 5 mm. The largest gap dimension in the length should correlate with the gap size of the Expansion Joint cover ordered.

### INSTALLATION

Kindly refer to the detailed GENOTEK installation instructions or contact your nearest GENOTEK Technical Centre for the same.

### PACKAGING

- Aluminium Support Profile: Standard Supply Length of 3.00 LM per piece.
- Elastomeric Rubber Insert: Standard Supply Length of 25.00 LM per roll.
- Moisture Barrier: Variable Length as per requirement.
- Accessories: Original Manufacturer Packing.



## D-1100 & DK-1100 THERMAL SURFACE MOUNT WALL & CEILING SYSTEMS

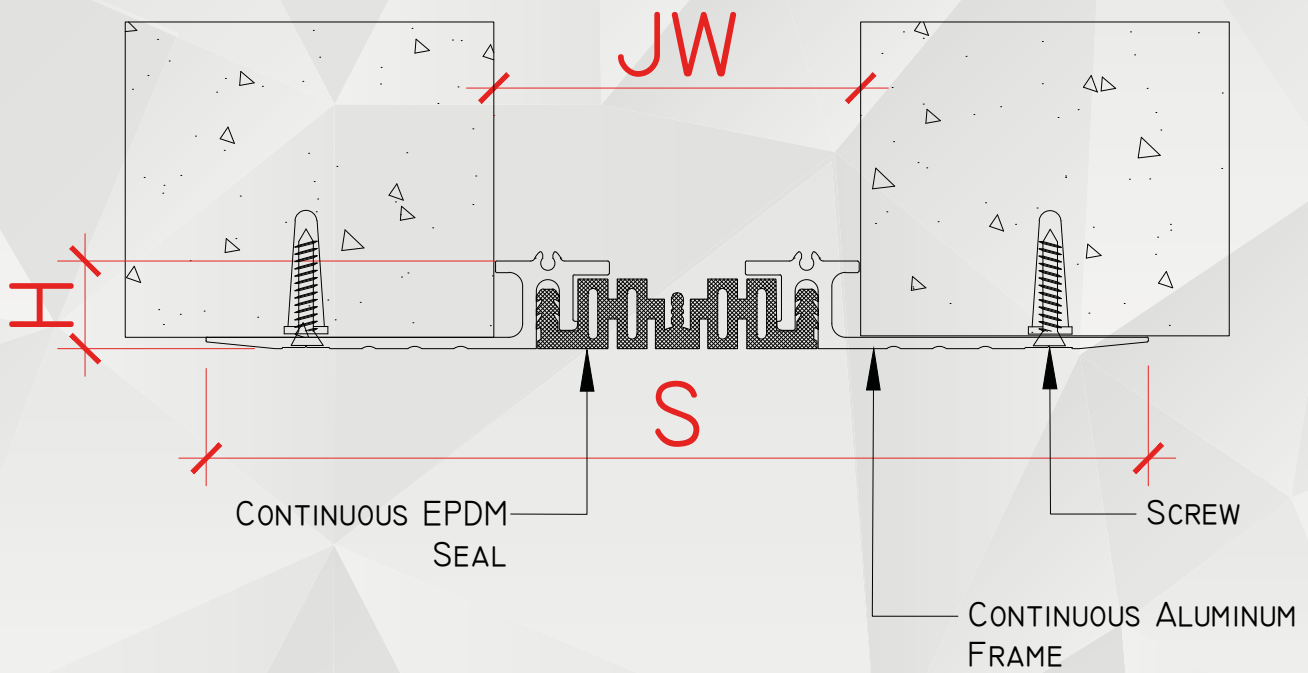

<input checked="" type="checkbox"/>	SKU	NAME	JOINT WIDTH, JW (MM)	HEIGHT, H (MM)	SIGHTLINE, S (MM)	MOVEMENT CAPACITY (%)
<input type="checkbox"/>	DII003016128	D-II00-30	30	16	128	±20
<input type="checkbox"/>	DII005016140	D-II00-50	50	16	140	±20
<input type="checkbox"/>	DII007518188	D-II00-75	75	18	188	±24
<input type="checkbox"/>	DII007520200	D-II00-75	75	20	200	±24
<input type="checkbox"/>	DII008520205	D-II00-85	85	20	205	±24
<input type="checkbox"/>	DII0010020226	D-II00-100	100	20	226	±24
<input type="checkbox"/>	DII0015024270	D-II00-150	150	24	270	±24

NOTE: 1. THE ABOVE DRAWINGS ARE FOR ILLUSTRATION ONLY, PLEASE SEE THE SYSTEM DRAWING OF THE PROFILE FOR THE SECTION DETAILS AS SPECIFICATION MAY VARY.

2. THE ABOVE SIZES ARE FOR REFERENCE, ADDITIONAL SIZES MAY BE AVAILABLE AND / OR CUSTOMIZED. KINDLY CONTACT GENOTEK TECHNICAL SUPPORT FOR MORE INFORMATION.



# TECHNICAL DATA SHEET



GENOTEK

## D-1100 & DK-1100 THERMAL SURFACE MOUNT WALL & CEILING SYSTEMS

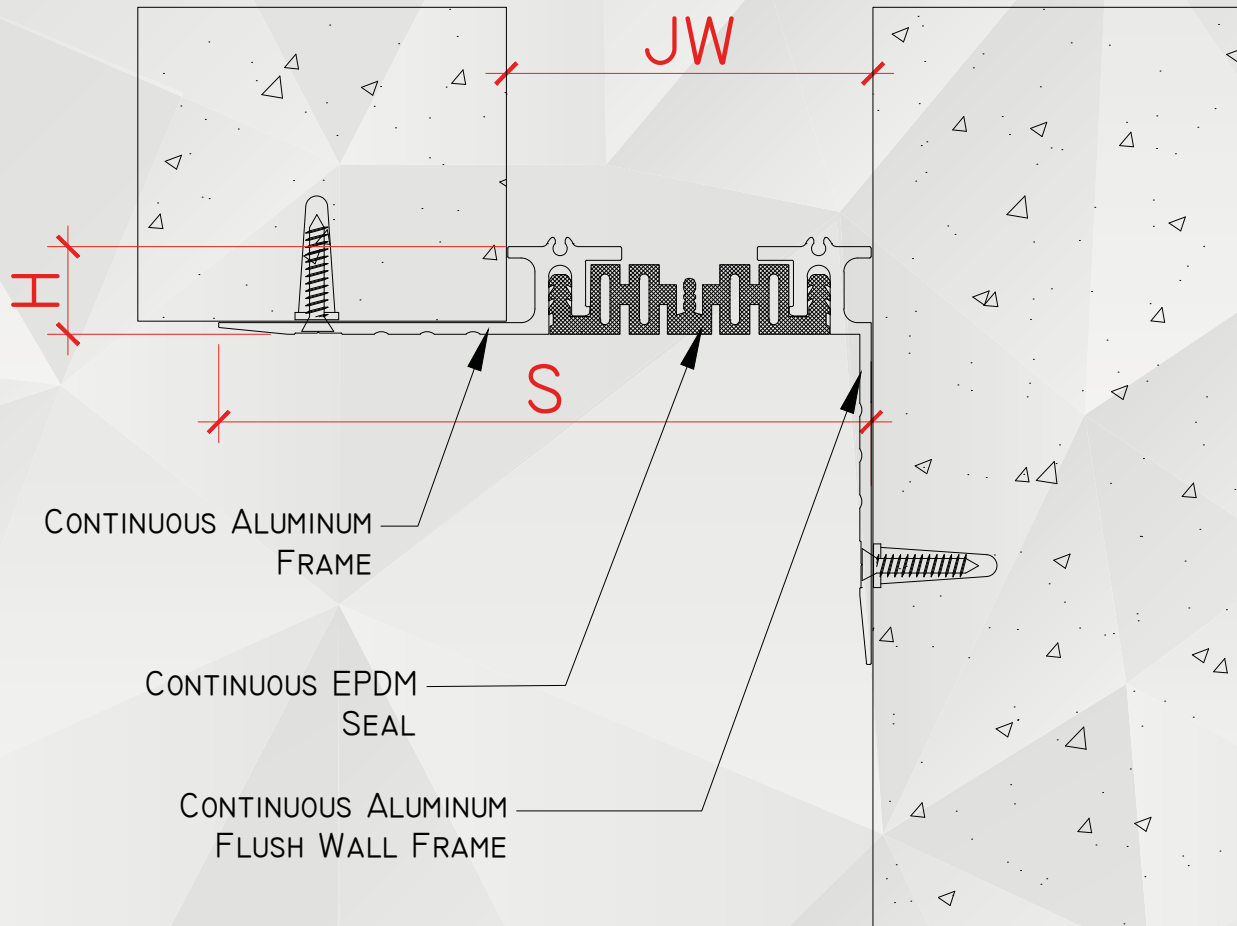

<input checked="" type="checkbox"/>	SKU	NAME	JOINT WIDTH, JW (MM)	HEIGHT, H (MM)	SIGHTLINE, S (MM)	MOVEMENT CAPACITY (%)
<input type="checkbox"/>	DKII00301682	DK-II00-30	30	16	82	±20
<input type="checkbox"/>	DKII005016110	DK-II00-50	50	16	110	±20
<input type="checkbox"/>	DKII007520136	DK-II00-75	75	20	136	±24
<input type="checkbox"/>	DKII007518142	DK-II00-75	75	22	142	±24
<input type="checkbox"/>	DKII008520142	DK-II00-85	85	20	142	±24
<input type="checkbox"/>	DKII0010020163	DK-II00-100	100	20	163	±24
<input type="checkbox"/>	DKII0015024210	DK-II00-150	150	24	210	±24

NOTE: 1. THE ABOVE DRAWINGS ARE FOR ILLUSTRATION ONLY, PLEASE SEE THE SYSTEM DRAWING OF THE PROFILE FOR THE SECTION DETAILS AS SPECIFICATION MAY VARY.

2. THE ABOVE SIZES ARE FOR REFERENCE, ADDITIONAL SIZES MAY BE AVAILABLE AND / OR CUSTOMIZED. KINDLY CONTACT GENOTEK TECHNICAL SUPPORT FOR MORE INFORMATION.