

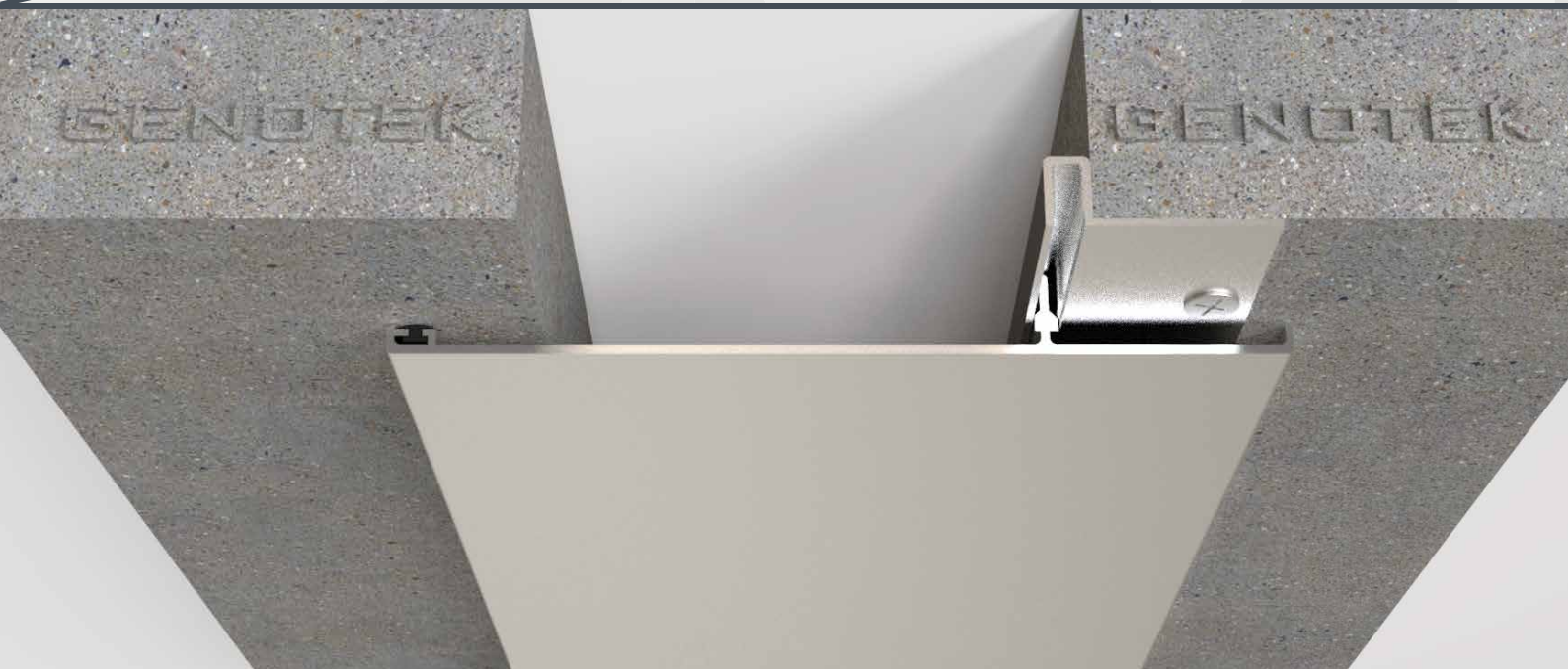

## D-1500 & DK-1500 SURFACE MOUNT WALL & CEILING SYSTEMS



### PRODUCT DESCRIPTION

The D - 1500 Expansion Joint Cover is an ideal Cover for Wall to Wall and Ceiling to Ceiling Applications.

The Series is suitable for Areas where a High Movement Capacity is required.

The components of the D - 1500 cover are:

- Extruded Aluminium Cover Plate.
- Extruded Aluminium Retainer.
- Elastomeric Rubber Gasket.

The D - 1500 is a Full Aluminium Expansion Joint Cover Profile in Anodized Finish.

This Profile is designed to be used in Areas where Tamper-Proof Applications are required.

The Aluminium Cover Plate has a Snap-Fit design and connects to the Aluminium Retainer fixed to the Wall.

The Free-Floating Cover Plate spans across the joint and slides over the Wall Surface to allow movement as and when required.

The Elastomeric Rubber Gasket attached on the Moving Side of the Plate, prevents the Plate from scratching the Finishing Surface of the Wall.

The Cover Plate can be Powder Coated to match the Finishes of the adjacent Wall or Ceiling Slabs.

### RECOMMENDED FOR

- Interior Wall & Ceiling Areas.
- Areas where Low Maintenance Profile is required.

### TECHNICAL DATA

#### Cover Plate & Retainers

The Aluminium profiles are extruded using one of the multiple Aluminium alloys and tempers.

The selection of the Aluminium grade depends on the use case of the profile.

Aluminium grade AA 6063 is the preferred choice for most profiles.

#### Optional: Vapour Barrier

Material	Ethylene Propylene Diene Monomer.
Color	Black.
Tensile Strength	1431 psi - ASTM D 412.
Tear Resistance (lbf/in.)	204 - ASTM D 624.
Puncture Resistance (lbf)	60 at 4.49" - ASTM E 154.



## D-1500 & DK-1500 SURFACE MOUNT WALL & CEILING SYSTEMS

### STORAGE & HANDLING

#### ALUMINIUM

- **Transportation**

Aluminium can be damaged during transport and constitutes in the form of scratches and wear marks that can lead to subsequent interfacial corrosion. Such damage prevents satisfactory surface treatment of the profiles.

The appearance of Aluminium is affected by minor transportation damages to the surface of the material but mechanical properties of the metal, however, remain unaffected.

To prevent such damage to the material, it is important for the Aluminium profiles to be packaged in strong paper, plastic or bubble wrap during any moving and transportation to prevent individual profile surfaces from bumping against each other thus causing scratches.

- **Storage**

It is important to note that Aluminium gets easily affected by water and moisture.

Aluminium alloys with higher magnesium content are sensitive to water and condensation, whereas purer alloys have greater resistance to the same.

Moisture damage to Aluminium appears as white patches/ spots or dark discolouration marks and can be observed in the event if water or condensation is trapped between Aluminium profile stacked upon or lying very close to each other.

### SUBSTRATE REQUIREMENT & PREPARATION

- The surface must have sufficient clearance from the reinforcement to provide enough space for the anchor.
- The surface must be level with a Maximum Tolerance of +/- 2 mm to provide the best Aesthetic Finish.
- The Gap must be level with a Maximum Tolerance of +/- 5 mm. The largest gap dimension in the length should correlate with the gap size of the Expansion Joint Cover ordered.

### INSTALLATION

Kindly refer to the detailed GENOTEK installation instructions or contact your nearest GENOTEK Technical Centre for the same.

### PACKAGING

- Aluminium Cover Plate & Retainers: Standard Supply Length of 3.00 LM per piece.
- Moisture Barrier: Variable Length as per requirement.
- Accessories: Original Manufacturer Packing.



## D-1500 & DK-1500 SURFACE MOUNT WALL & CEILING SYSTEMS

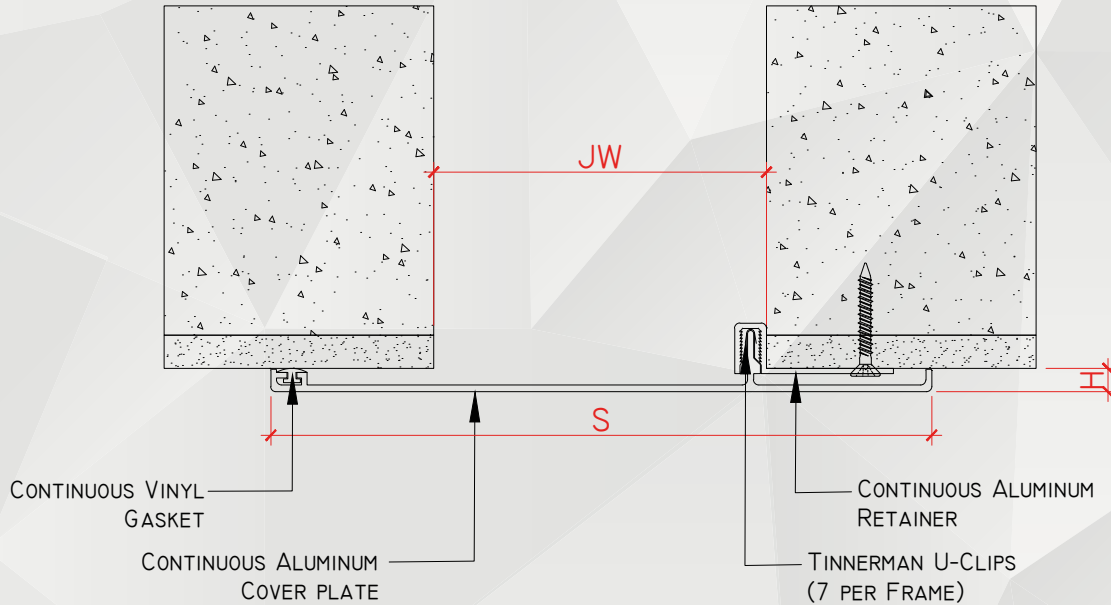

<input checked="" type="checkbox"/>	SKU	NAME	JOINT WIDTH, JW (MM)	HEIGHT, H (MM)	SIGHTLINE, S (MM)	MOVEMENT CAPACITY (%)
<input type="checkbox"/>	DI50030995	D-1500-30	30	9	95	±50
<input type="checkbox"/>	DI500507150	D-1500-50	50	7	150	±50
<input type="checkbox"/>	DI500757175	D-1500-75	75	7	175	±50
<input type="checkbox"/>	DI5001007200	D-1500-100	100	7	200	±50
<input type="checkbox"/>	DI5001257225	D-1500-125	125	7	225	±50

NOTE: 1. THE ABOVE DRAWINGS ARE FOR ILLUSTRATION ONLY, PLEASE SEE THE SYSTEM DRAWING OF THE PROFILE FOR THE SECTION DETAILS AS SPECIFICATION MAY VARY.

2. THE ABOVE SIZES ARE FOR REFERENCE, ADDITIONAL SIZES MAY BE AVAILABLE AND / OR CUSTOMIZED. KINDLY CONTACT GENOTEK TECHNICAL SUPPORT FOR MORE INFORMATION.



## D-1500 & DK-1500 SURFACE MOUNT WALL & CEILING SYSTEMS

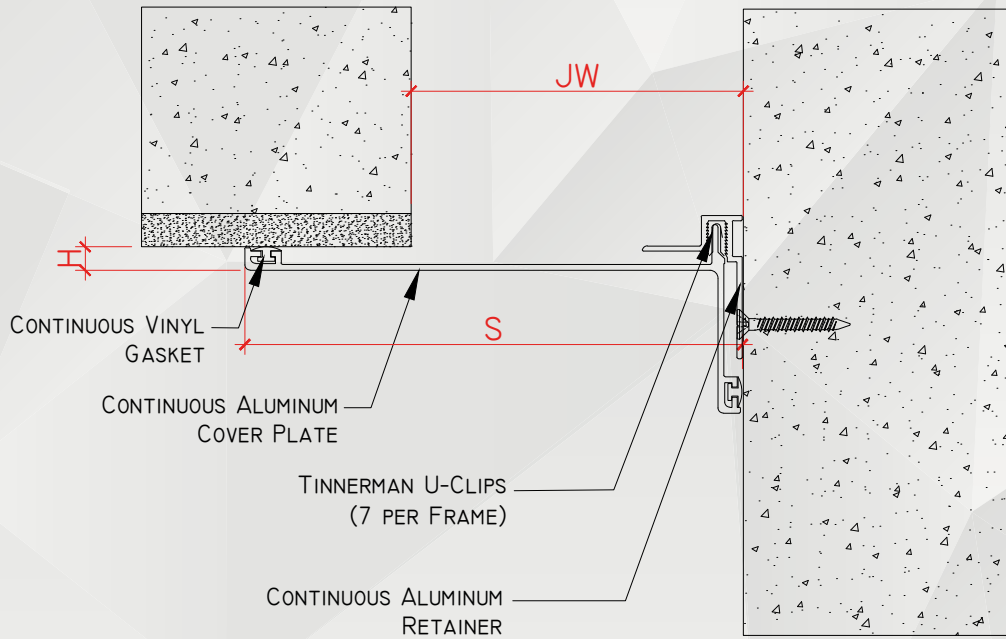

<input checked="" type="checkbox"/>	SKU	NAME	JOINT WIDTH, JW (MM)	HEIGHT, H (MM)	SIGHTLINE, S (MM)	MOVEMENT CAPACITY (%)
<input type="checkbox"/>	DKI50030983	DK-I500-30	30	9	83	±50
<input type="checkbox"/>	DKI500507100	DK-I500-50	50	7	100	±50
<input type="checkbox"/>	DKI500757125	DK-I500-75	75	7	125	±50
<input type="checkbox"/>	DKI5001007150	DK-I500-100	100	7	150	±50
<input type="checkbox"/>	DKI5001257175	DK-I500-125	125	7	175	±50

NOTE: 1. THE ABOVE DRAWINGS ARE FOR ILLUSTRATION ONLY, PLEASE SEE THE SYSTEM DRAWING OF THE PROFILE FOR THE SECTION DETAILS AS SPECIFICATION MAY VARY.

2. THE ABOVE SIZES ARE FOR REFERENCE, ADDITIONAL SIZES MAY BE AVAILABLE AND / OR CUSTOMIZED. KINDLY CONTACT GENOTEK TECHNICAL SUPPORT FOR MORE INFORMATION.