



INSTALLATION INSTRUCTION



GENOTEK

D-4000 AND DK-4000 WALL AND CEILING EXPANSION JOINT COVER



The following installation instructions are very important. Read them carefully, and be sure you understand them completely before you begin any work.

INSTALLATION OF D-4000 and DK-4000

These installation instructions are for the installation of Expansion Joint Cover Types D-4000 and DK-4000. The joint cover system shall be installed as follows:

1. Before beginning installation of the D-4000 and DK-4000, review the layouts for the various types and location as detailed on the approved GENOTEK shop drawings.
2. Select one base member extrusion, and drill the anchor holes into it, spacing the holes a maximum of 45 cm. O.C. The anchor holes at the ends of the extrusion must be a maximum of 15cm. from the end of the extrusion.
3. Drill the anchor holes in the corresponding opposite base member, using the same spacing for the holes as was used for the base member drilled in Step 2.
4. If fire barrier is provided with the system, install it at this time. See the installation instructions for the appropriate fire barrier type provided.
5. Select one of the drilled base members and place it in position against the substrate and along the edge of the joint. Refer to the details for proper positioning of the base member from the edge of the joint. Ensure that the base member is level and properly aligned.



INSTALLATION INSTRUCTION



GENOTEK

D-4000 AND DK-4000 WALL AND CEILING EXPANSION JOINT COVER

6. Select one of the drilled base members and place it in position against the substrate and along the edge of the joint. Refer to the details for proper positioning of the base member from the edge of the joint. Ensure that the base member is level and properly aligned.
7. For concrete or masonry substrates, remove the base member and drill the anchor holes into the substrate at the locations marked in Step 5.
8. Put the base member back into position on the concrete or masonry substrate, aligning the anchor holes in the base member with the anchor holes in the substrate, and attach the base member to the substrate using the M4x40 fasteners (Not supplied by GENOTEK). (See figure 1.)

(NOTE: IF REQUESTED AT THE TIME OF APPROVAL, APPROPRIATE CONCRETE ANCHORS WILL BE PROVIDED FOR CONCRETE AND MASONRY INSTALLATIONS.)

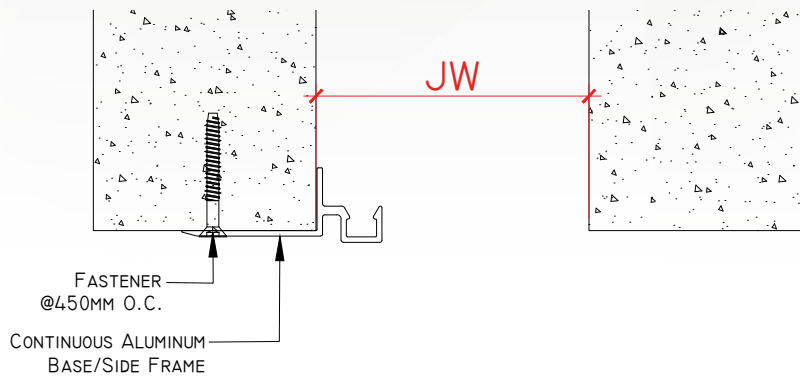

Figure 1.

9. If the substrate is stud and wallboard, use the self-tapping, self-drilling fasteners to attach the base member to the substrate. Ensure that the fasteners are attached to the studs in the wall or ceiling.
10. Place the corresponding opposite base member in position on the substrate along the other edge of the joint. Refer to the details for proper positioning of the base member from the edge of the joint. Ensure that the base member is level and properly aligned. Attach the base member to the substrate using the applicable procedures in Step 4 through Step 8 (see Figure 2).



INSTALLATION INSTRUCTION



GENOTEK

D-4000 AND DK-4000 WALL AND CEILING EXPANSION JOINT COVER

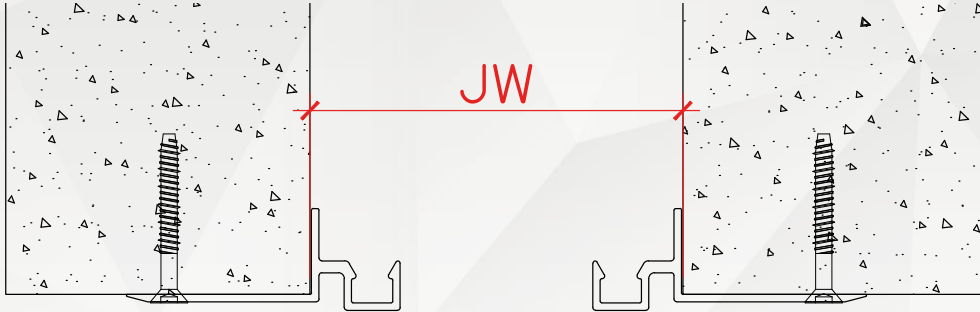

Figure 2.

11. Start the installation of the Cover Plate by cutting first the Plate to length needed.
12. Attach a Turnbar to the backside of the Cover Plate at each hole location. Thread a machine screw approx. 5mm only into the Turnbar for now.
13. Place the Wall Cover with Turnbar Assembly against one side of the Seismic Expansion Joint at an angle that will allow hand penetration behind the Cover Plate (see Figure 3 & 4). With the Cover Plate in this position, reach behind the Cover Plate and locate the top pivot pin of the Turnbar into the pivot pin receivers of the Frame on each side of the joint (one side on DK-4000).

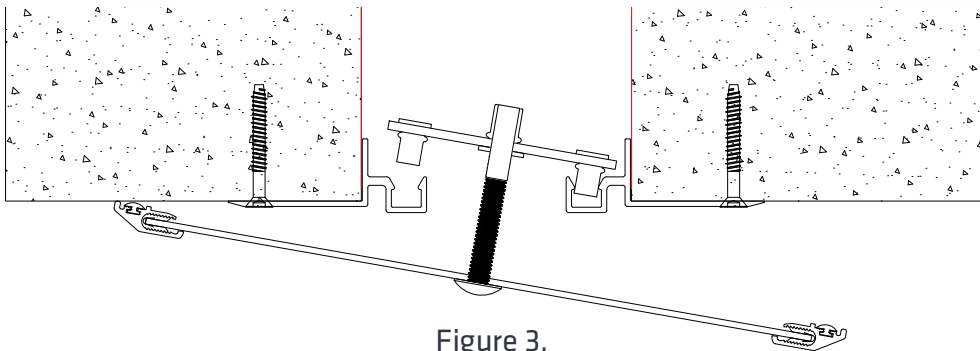

Figure 3.

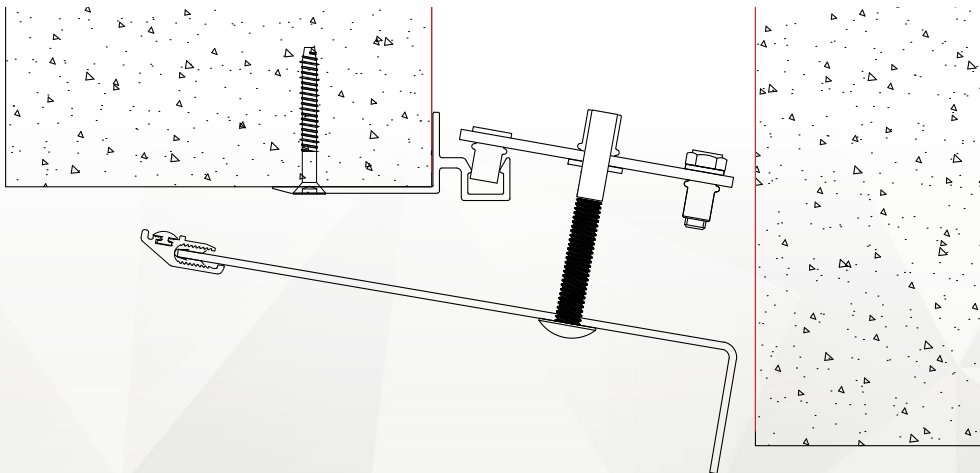

Figure 4.



INSTALLATION INSTRUCTION



GENOTEK

D-4000 AND DK-4000 WALL AND CEILING EXPANSION JOINT COVER

14. Hold the Turnbar securely into position by sliding a wedge block beneath the Cover Plate. Repeat this procedure with the bottom Turnbar.
15. Locate each of the remaining Turnbars into position, then progressively tighten all machine screws until the Cover Plate is securely fastened onto the Frame system.

(NOTE: The Turnbars must be angled the same direction to allow for movement. DK-4000-100 to 150 does not require turnbar installation, only Cover Plate installation required.)

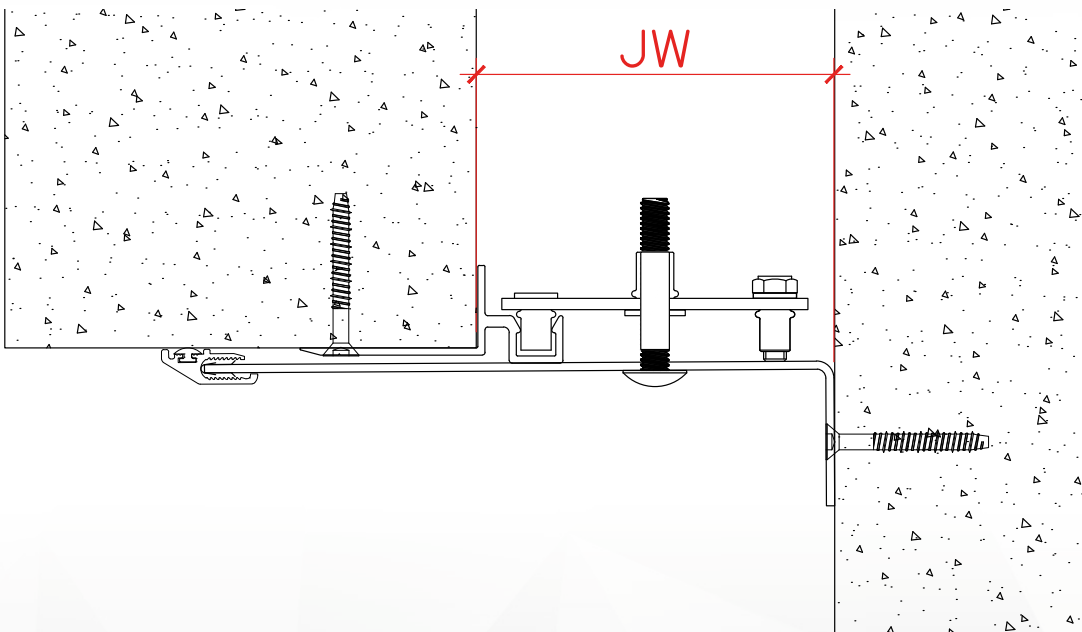
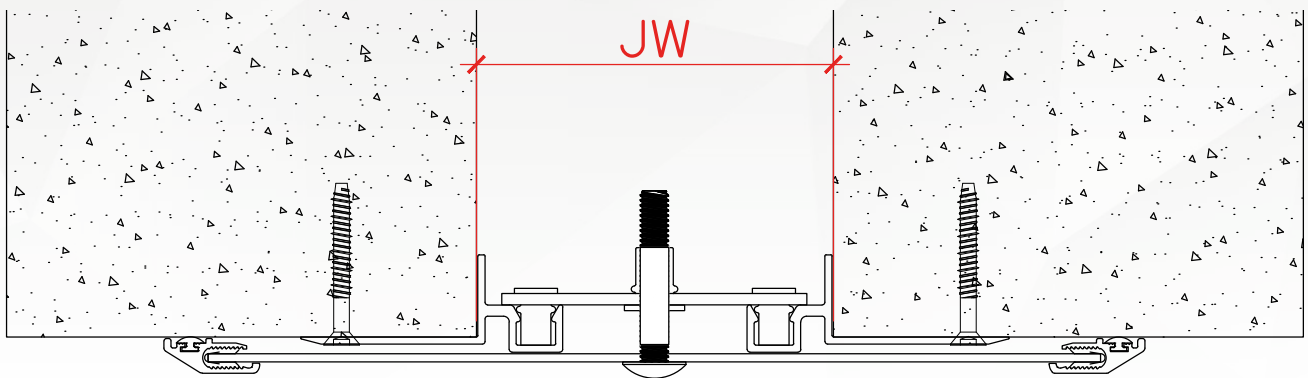

16. Remove all residue and foreign matter from the area and expansion joint cover.
17. Protect the Expansion joint cover until the final inspection.