

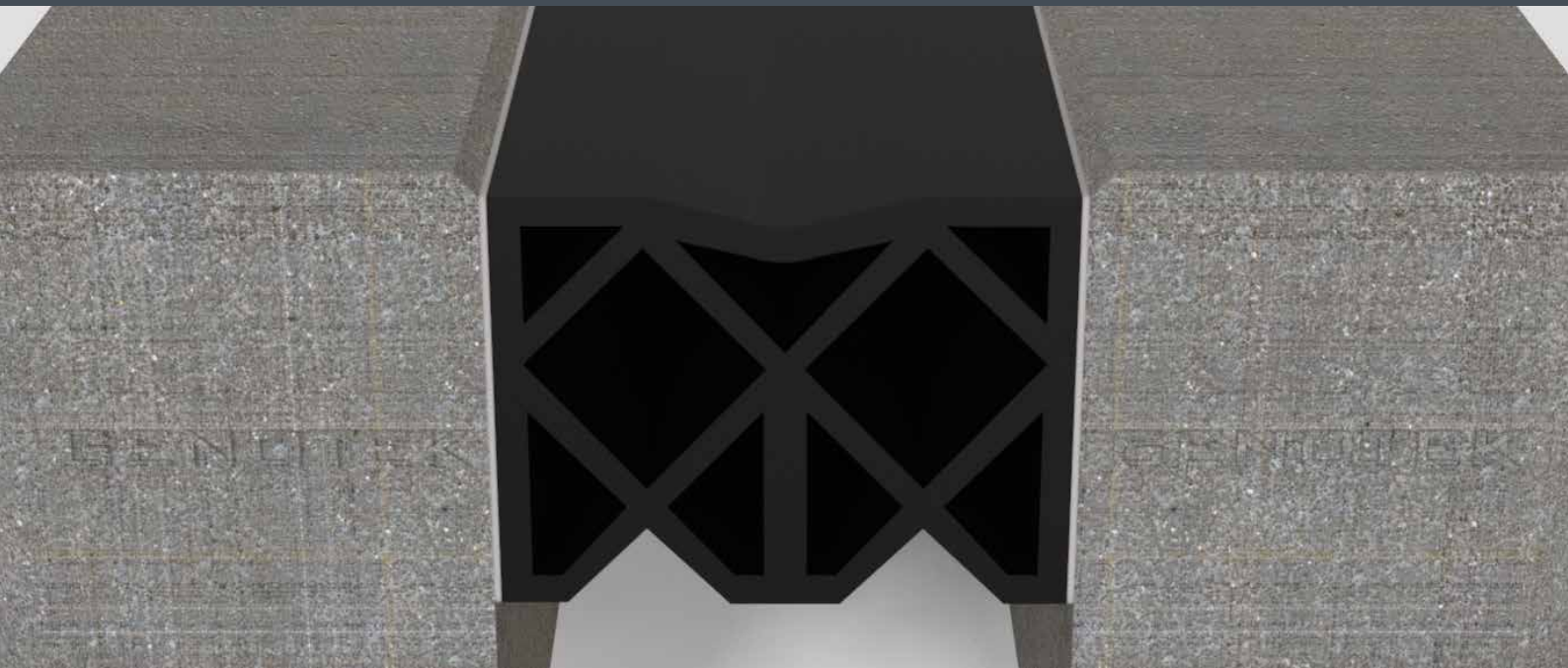

## GN SERIES COMPRESSION SEAL SERIES



### PRODUCT DESCRIPTION

The GN Series Expansion Joint Cover is an ideal Cover for Floor To Floor and Wall To Wall Applications.

The Series is suitable for Exterior Areas where Heavy-Duty Traffic and High Loads are expected.

The components of the GN Series Profile are:

- Continuous Extruded Compression Seal.

The GN Series is a Full Rubber Expansion Joint Cover Profile specifically designed for Areas where Heavy-Duty Vehicular Loads are expected.

The Profile consists of a Single Piece Fully Extruded Elastomeric Rubber Seal with Integral Epoxy Reservoirs to help with installation.

The Profile is specifically designed to be used in Vehicular Load Areas requiring Watertight Profiles and having Bends or Gradients.

After bonding with the adjacent slabs with a High Strength Epoxy, the Profile becomes a Watertight Profile.

The Closed Cell Design allows this Joint System to achieve a +/- 50% Movement Capability.

The Profile is resistant to Road Salts, Fuel, Lubricants, UV Radiation, Ozone, etc.

### RECOMMENDED FOR

- Heavy Duty Traffic Areas and Heavy Load Bearing Areas.
- Expansion Joint Gaps on Highways and Bridge Structures.
- Areas Having Bends and / or Gradients.

### TECHNICAL DATA

#### Extruded Elastomeric Rubber Seal

Material: Thermoplastic Elastomer or Ethylene Propylene Diene Monomer.

Hardness: 60 – 70 ShoreA (ASTM D 2240).

Finish: Grooved Finish.

Colors: Black.



## GN SERIES COMPRESSION SEAL SERIES

### STORAGE & HANDLING

#### EPDM

- **Storage**

The storage temperature must remain below 25° C.

There should be no direct heat sources in the storage area.

The seals should not be exposed to direct sunlight.

The seals must be protected from the effects of ozone and ionizing radiation.

The seals must be stored so as to avoid their being under tensile stress.

### SUBSTRATE REQUIREMENT & PREPARATION

- The Joint Gap must have enough clearance from the reinforcement to provide enough space for the Profile to be inserted for Installation.
- The surface must be level with a Maximum Tolerance of +/- 2 mm to provide the best Aesthetic Finish.
- The Gap must be level with a Maximum Tolerance of +/- 5 mm. The largest gap dimension in the length should correlate with the gap size of the Expansion Joint cover ordered.

### INSTALLATION

Kindly refer to the detailed GENOTEK installation instructions or contact your nearest GENOTEK Technical Centre for the same.

### PACKAGING

- Elastomeric Rubber Profile: Standard Supply Length of 25.00 LM per roll.
- Moisture Barrier: Variable Length as per requirement.
- Accessories: Original Manufacturer Packing.



## GN SERIES COMPRESSION SEAL SERIES

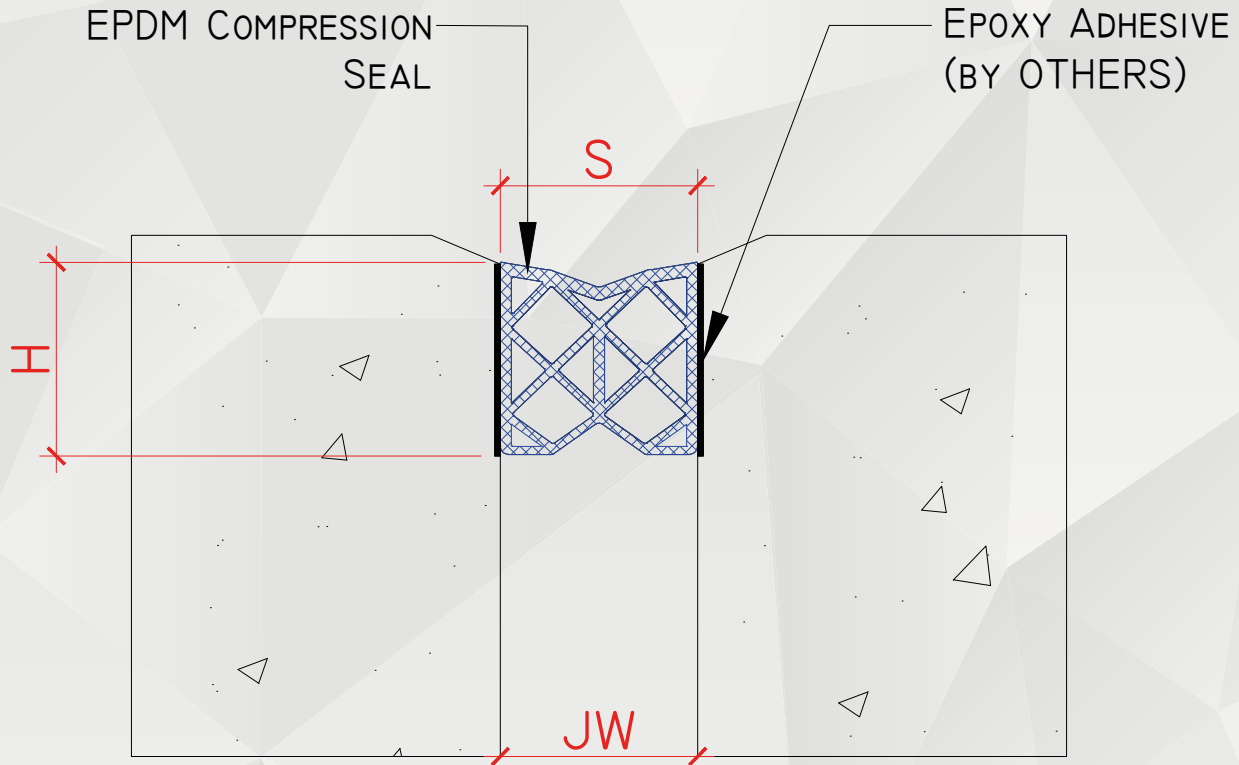

<input checked="" type="checkbox"/>	SKU	NAME	JOINT WIDTH, JW (MM)	HEIGHT, H (MM)	SIGHTLINE, S (MM)	MOVEMENT CAPACITY (%)
<input type="checkbox"/>	GN303536	GN TYPE-1	18-30	35	18-30	±40
<input type="checkbox"/>	GN403846	GN TYPE-2	20-40	38	20-40	±40
<input type="checkbox"/>	GN405050	GN TYPE-2A	20-40	50	20-40	±40
<input type="checkbox"/>	GN505556	GN TYPE-3	27-50	55	27-50	±40
<input type="checkbox"/>	GN506565	GN TYPE-3A	27-50	65	27-50	±40
<input type="checkbox"/>	GN607068	GN TYPE-4	30-60	70	30-60	±40
<input type="checkbox"/>	GN708780	GN TYPE-5	35-70	87	35-70	±40
<input type="checkbox"/>	GN85100100	GN TYPE-5A	50-85	100	50-85	±40
<input type="checkbox"/>	GN9590107	GN TYPE-6	50-95	90	50-95	±40
<input type="checkbox"/>	GN110125125	GN TYPE-6A	90-110	125	90-110	±40
<input type="checkbox"/>	GN120100135	GN TYPE-7	55-120	100	55-120	±40
<input type="checkbox"/>	GN135150150	GN TYPE-7A	110-135	150	110-135	±40

NOTE: 1. THE ABOVE DRAWINGS ARE FOR ILLUSTRATION ONLY, PLEASE SEE THE SYSTEM DRAWING OF THE PROFILE FOR THE SECTION DETAILS AS SPECIFICATION MAY VARY.

2. THE ABOVE SIZES ARE FOR REFERENCE, ADDITIONAL SIZES MAY BE AVAILABLE AND / OR CUSTOMIZED. KINDLY CONTACT GENOTEK TECHNICAL SUPPORT FOR MORE INFORMATION.