

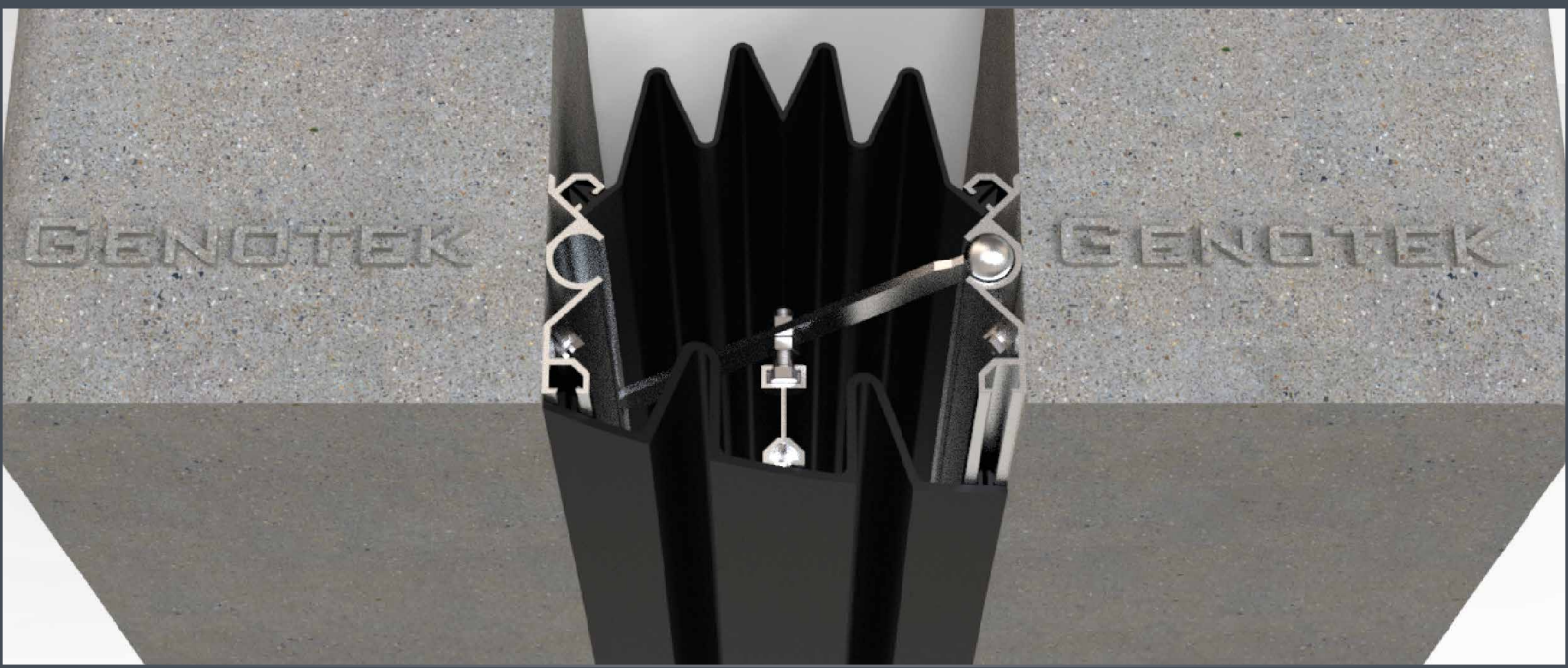

WE SERIES WALL AND CEILING EXPANSION JOINT COVER



The following installation instructions are very important. Read them carefully, and be sure you understand them completely before you begin any work.

INSTALLATION OF WE SERIES

These installation instructions are for the installation of Expansion Joint Cover Types WE- 50 and WE-100. The joint cover system shall be installed as follows:

1. Before beginning installation of the WE Series, review the layouts for the various types and location as detailed on the approved GENOTEK shop drawings.
2. Select one base member extrusion, and drill the anchor holes into it, spacing the holes a maximum of 30 cm. o.c. The anchor holes at the ends of the extrusion must be a maximum of 15 cm. from the end of the extrusion. (If the anchor holes have not been drilled into the base member at the factory.)
3. Drill the anchor holes in the corresponding opposite base member, using the same spacing for the holes as was used for the base member drilled in Step 2.
4. If fire barrier is specified, install it at this time. Refer to the appropriate fire barrier type installation instructions for additional instructions regarding the installation of the fire barrier.
5. If the wall is stud and gypsum wallboard construction, proceed directly to Step 9. If the wall is concrete or masonry construction, follow the instructions given in Step 6. through Step 9.
6. Select one of the drilled base members and place it in proper position against the wall. Ensure that the front of the base member is 3 mm from the surface of the wall. This will allow the face seal to be nominally flush with the wall. Also ensure that the base member is level and properly aligned.
7. Using the base member as a template, mark the locations for the anchor holes on the substrate.



WE SERIES WALL AND CEILING EXPANSION JOINT COVER

8. Remove the base member from its installed position, and drill the anchor holes into the substrate at the locations marked in Step 7.
9. Select the base member.
10. If the installation is exterior, place a continuous bead of silicone sealant or Butyl Tape onto the back side of the base member (see Figure 1).

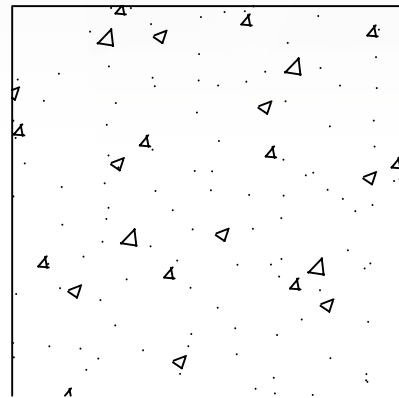
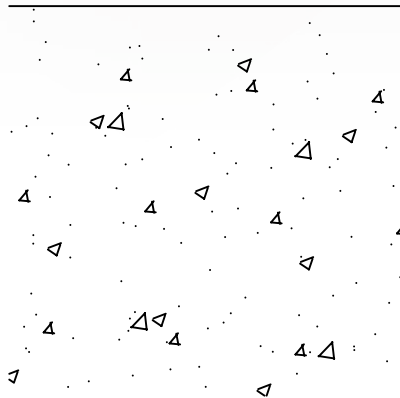
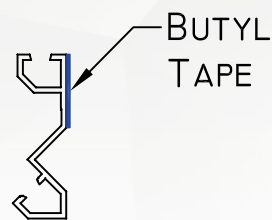

Figure 1.

11. Place the base member back into its installed position in the joint. Ensure that the base member is properly aligned and level and that the front of the base member is set back 3 mm. from the surface of the wall. If the wall is concrete or masonry, ensure that the anchor holes in the base member align properly with the anchor holes in the wall.



WE SERIES WALL AND CEILING EXPANSION JOINT COVER

12. Using the fasteners (pls. be noted that fasteners are not supplied by GENOTEK. They are supplied upon request) , attach the base member to the wall (see Figure 2). Ensure that the base member remains properly aligned and level.

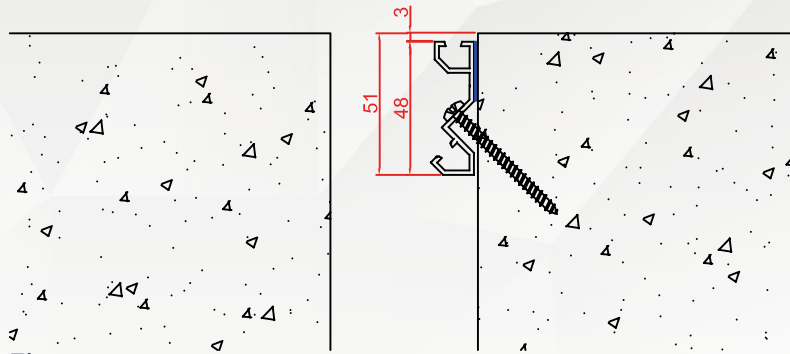

Figure 2.

13. Repeat the procedures, as directed, in Step 5 through Step 12 for the corresponding opposite base member (see Figure 3).

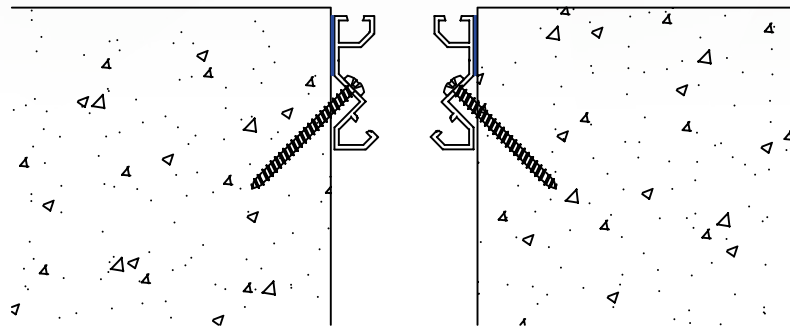

Figure 3.

14. Fill the secondary seal receiver slot of the installed base members with silicone sealant or BASF Sonalastic NP1 (by others) as illustrated in Figure 4.

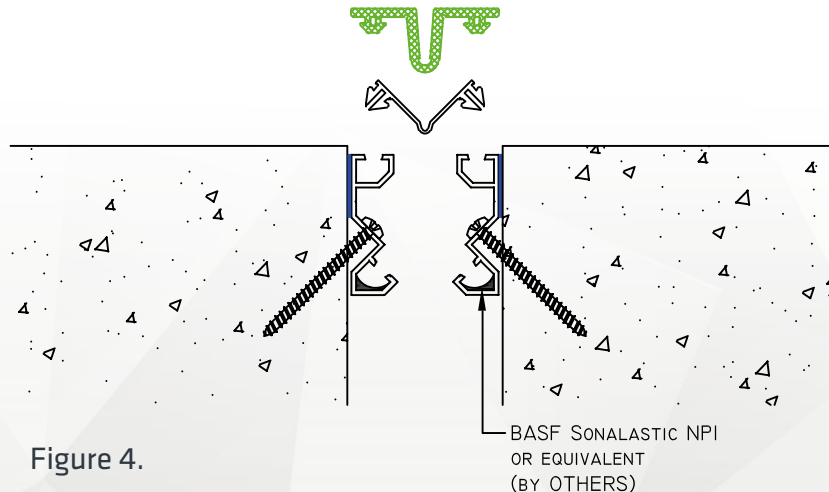

Figure 4.



WE SERIES WALL AND CEILING EXPANSION JOINT COVER

15. Starting at the top of the run, install the Secondary Seal into the Aluminum Frames by pushing the seal tabs into the receiver slots.

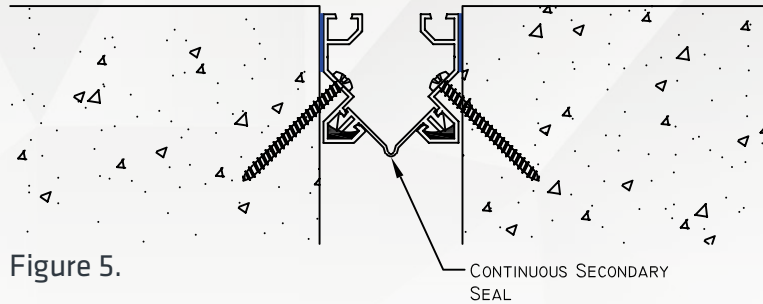

Figure 5.

16. Prior to installation of the Primary Seal, place silicone sealant or BASF Sonalastic NP1 (by others) into the Primary Seal receiver slot of each Aluminum Frame. Note: Application of the Sealant will aid in the installation of the seal and will improve the water resistance of the cover.
17. Cut the Primary Seal to length as needed for the run. When necessary, multiple lengths of seal may have to be spliced together for the required length of the run.
18. Beginning at the top of the run, insert the tabs on the Primary Seal into the receiver slots of the frames.

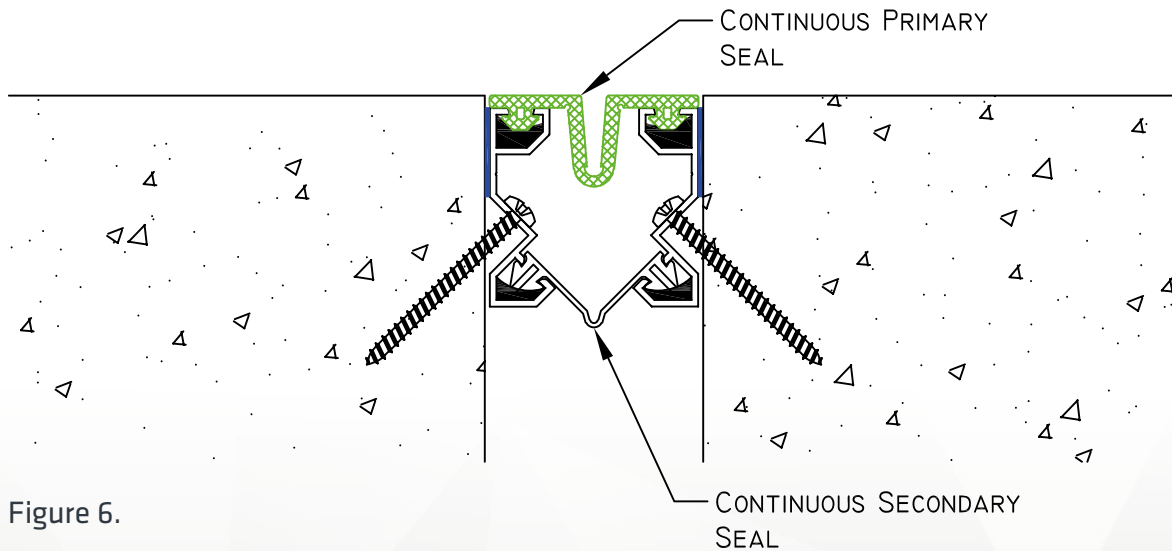

Figure 6.