



INSTALLATION INSTRUCTION



GENOTEK

WTZ-1800, WTZ-IK-1800 AND WTZK-1800 SERIES FLOOR EXPANSION JOINT COVER

GENOTEK WTZ-1800, WTZ-IK-1800 and WTZK-1800 Floor Expansion Joint Cover accommodates heavy duty thermal movement while providing a watertight solution for areas prone to water usage. The system has exceptional durability under heavy traffic and extreme weather conditions.

SYSTEM COMPONENTS

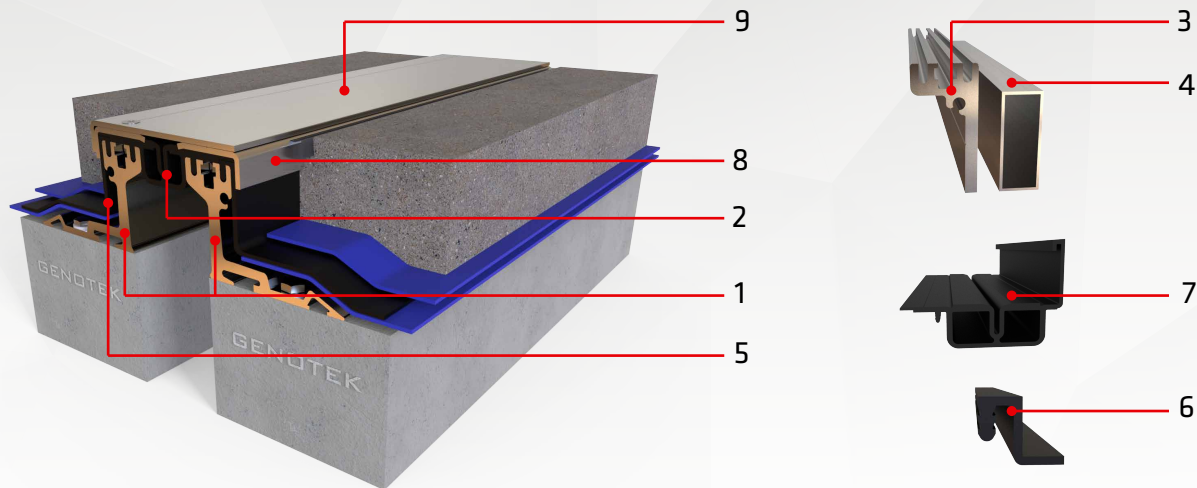

PARTS LIST

| ITEM NUMBER | DESCRIPTION | PART NUMBER |
|-------------|------------------------------|-------------|
| 1 | BASE MEMBER | AY-27052 |
| 2 | CONT. EPDM SEAL | AR-75 |
| 3 | CONT. WALL FRAME | SA-14860 |
| 4 | CONT. ALUMINUM BOX | SA-957 |
| 5 | CONT. LONG FLUSHING SEAL | CE-001 |
| 6 | CONT. SHORT FLUSHING SEAL | CE-002 |
| 7 | CONT. EPDM SEAL (CORNER) | ARK-75 |
| 8 | CONT. RETAINING CAP | SA-11845 |
| 9 | CONT. COVER PLATE (OPTIONAL) | PL-150 |



INSTALLATION INSTRUCTION



GENOTEK

WTZ-1800, WTZ-IK-1800 AND WTZK-1800 SERIES FLOOR EXPANSION JOINT COVER

EQUIPMENT LIST

Before the installation begins, the following materials and equipment must be available on-site.

- Power Source (Generator or access to reliable high-power amperage)
- Worktable
- Angle Grinders with diamond cup blades and abrasive blades for metal
- Compressed Air with small gauge extension tube
- Hammer Drills with depth guides
- Hammer Drill Bits
- Miter Saw
- Cutting-oil
- Drill Index
- High-Speed metal countersink bits
- Standard Industrial-grade high-speed drill
- High Speed drill bits
- Hand-Held metal (fine-toothed) file
- Screw Guns
- Screw Guns Bits
- Torque Wrench with adapter
- Plastic Spray Bottles
- Miter Saw
- Rubber Mallet
- Levels
- Tape Measure
- Box of clean, dry, lint-free, cloth rags
- Vise Grips
- Extension Cords
- Awl
- Open-end Wrenches
- Sockets & Ratchets

INSTALLATION

The following installation instructions are very important. Read them carefully, and be sure you understand them completely before you begin any work.

STORAGE AND HANDLING

The expansion joint covers are shipped unassembled. Upon receipt, this product should be stored in the horizontal position in a clean, dry location. This is a finished product. Store this product in a protected area.

GENOTEK recommends that the concrete poured around joints and block-outs be vibrated before it is allowed to cure. This will help minimize air pockets in the concrete around the joint and blockouts. In addition, GENOTEK recommends leaving the concrete forms in place in the block-out until just prior to the installation of the joint cover system. This will help protect the block-out from potential damage during the work of other sections. These installation instructions are for use in the installation of expansion joint cover types.



WTZ-1800, WTZ-IK-1800 AND WTZK-1800 SERIES FLOOR EXPANSION JOINT COVER

STEP 1. Review Shop Drawing

Review GENOTEK approved shop drawings for types and locations.

STEP 2. Provide Block-outs

Provide block-outs for GENOTEK expansion joint covers in accordance with the approved shop drawings. Block-outs may be formed at the time of the initial concrete pour or at a later time by removing material from the slab. To ensure a good installation use level and true blackout materials. Inspect the blockouts to see that they are flat, level, and clear of all debris. Prepare and clean the block-outs as needed.

NOTE: IF A TOPPING SLAB OR PAVERS ARE TO BE USED FOR THE FINISHED FLOORING, BLOCKOUTS WILL NOT BE USED FOR THE INSTALLATION. THE INSTALLATION SURFACE IS A LEVEL SLAB IN THESE INSTALLATIONS

STEP 3. Make Anchor Hole for Base Member

Select a section of the base member. If the anchor holes have not been predrilled in the base members at the factory, mark the locations for the anchor holes on the selected base member (see Figure 1). Standard anchor spacing is 30 cm. O.C. with an anchor at a nominal 10 cm from each end of the base member. Repeat marking of anchor locations for each section of the base member. If necessary, drill the holes into the base members at the marked locations (see Figure 2).



Figure 1

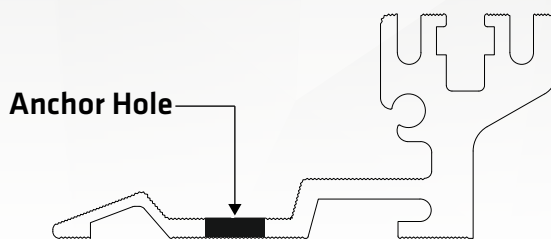

Figure 2

STEP 4. Make Anchor Hole for Wall Member

For Floor-to-Wall joints, select a section of the wall members. If the anchor holes have not been predrilled in the wall members at the factory, mark the locations for the anchor holes on the selected wall member. Standard anchor spacing is 30 cm O.C. with an anchor at a nominal 10 cm from each end of the base member. Repeat marking of anchor locations for each section of the base member. If necessary, drill the holes into the into the wall members at the marked locations (see Figure 3). The wall member anchor holes are to be countersunk.

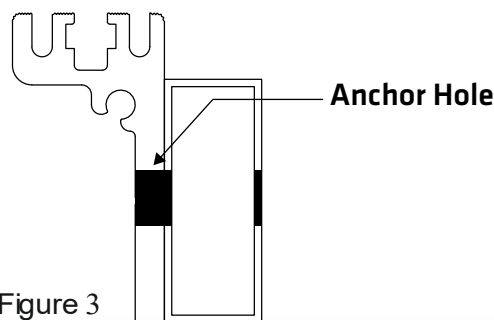
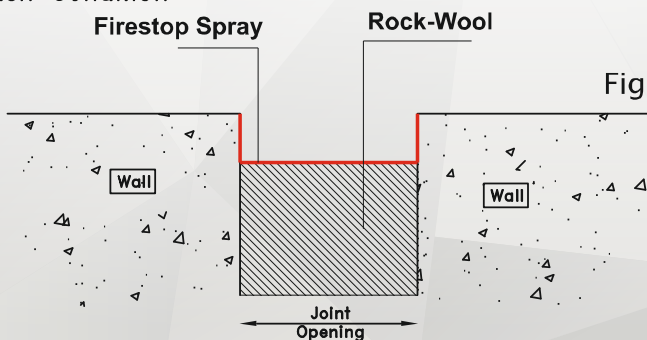

Figure 3

STEP 5. Install Fire Barrier (if required)

If fire barrier is specified, install it at this time. Refer to the installation instructions appropriate for the type of fire barrier provided for the recommended procedures to use in the installation of the fire barrier (see Figure 4).

Flush Condition



Corner Condition

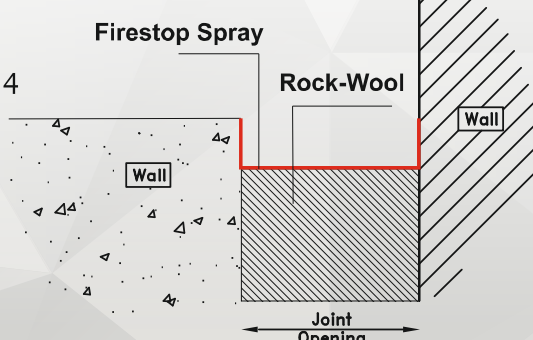

Figure 4



WTZ-1800, WTZ-IK-1800 AND WTZK-1800 SERIES FLOOR EXPANSION JOINT COVER

STEP 6. Install Water Barrier

If water barrier is specified, install it at this time. Refer to the installation instructions entitled, "INSTALLATION INSTRUCTIONS FOR GENOTEK EPDM WATER BARRIER SYSTEMS" for the recommended procedures for the installation of the water barrier.

STEP 7. Preparation for Fixing

Select two base members or a base member and a wall members (for Floor-to-Wall Systems), a cover plate (if applicable), and the elastomeric seal

STEP 8. Assembling the Profiles

Place the base members, or the base member and the wall member, about the width of the elastomeric seal apart on a flat working surface. Ensure that the base members' channels are facing one another (see Figure 5 & 6). If its required use lubricant to tuck seal into base members channel. Once edges of rubber seal and leading edge surfaces of base members channels are lubricated the seal can be tucked into base members rail easily.

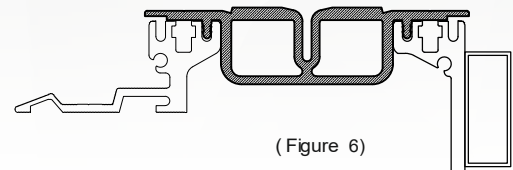
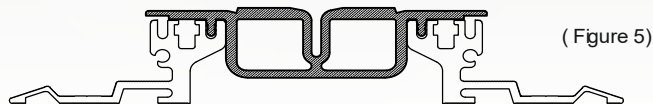

STEP 9. Leveling

Determine the high side of the joint or blockout. Begin the joint cover system on this side of the joint. Determine the high section of the substrate or blockout along the run of the high side of the joint. Begin the joint cover system installation at this section.

STEP 10. Placement

Place the assembled joint cover into its installed position in the blockout and over the joint (see Figure 7). Ensure that the system is plumb, level, properly aligned, and centered over the joint For Floor- to-Wall Systems, ensure that the wall base member is at the proper elevation.

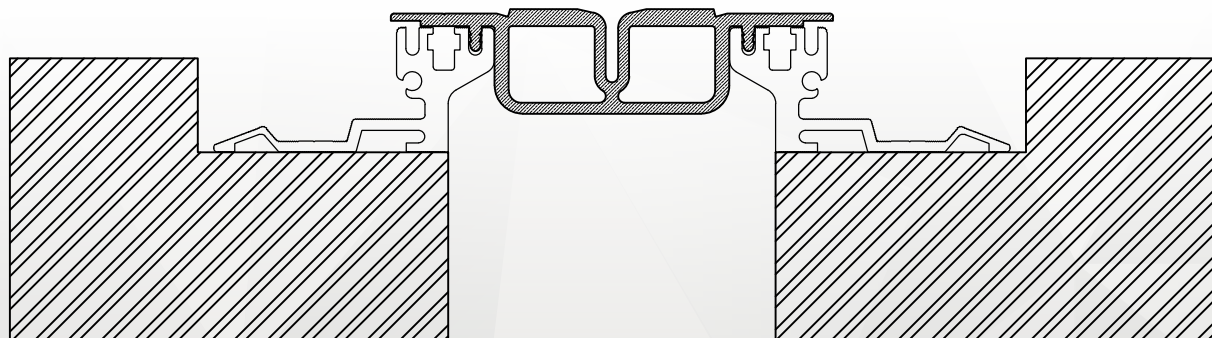

(Figure 7)



WTZ-1800 AND WTZK-1800 SERIES FLOOR EXPANSION JOINT COVER

NOTE: ENSURE THAT THE JOINT COVER BASE MEMBERS REST FIRMLY AND COMPLETELY ON THE SUBSTRATE SURFACE. ENSURE THAT THE COVER SYSTEM IS LEVEL WITH THE FINISHED FLOOR AND THAT THE SYSTEM IS LEVEL ALONG ITS LENGTH. SHIM AS NEEDED TO LEVEL THE SYSTEM. IF POSSIBLE, MAINTAIN THE STRAIGHTNESS OF THE INSTALLED JOINT COVER SYSTEM. DO NOT INSTALL BASE MEMBERS SO THAT THEY OVERHANG THE JOINT OR ARE CANTILEVERED OVER THE JOINT.

FOR FLOOR-TO-WALL SYSTEMS HAVING STUD AND WALLBOARD WALL CONSTRUCTION AND USING SELF-DRILLING, SELF-TAPPING ANCHORS, PREDRILLING ANCHOR HOLES INTO THE WALL IS NOT NECESSARY.

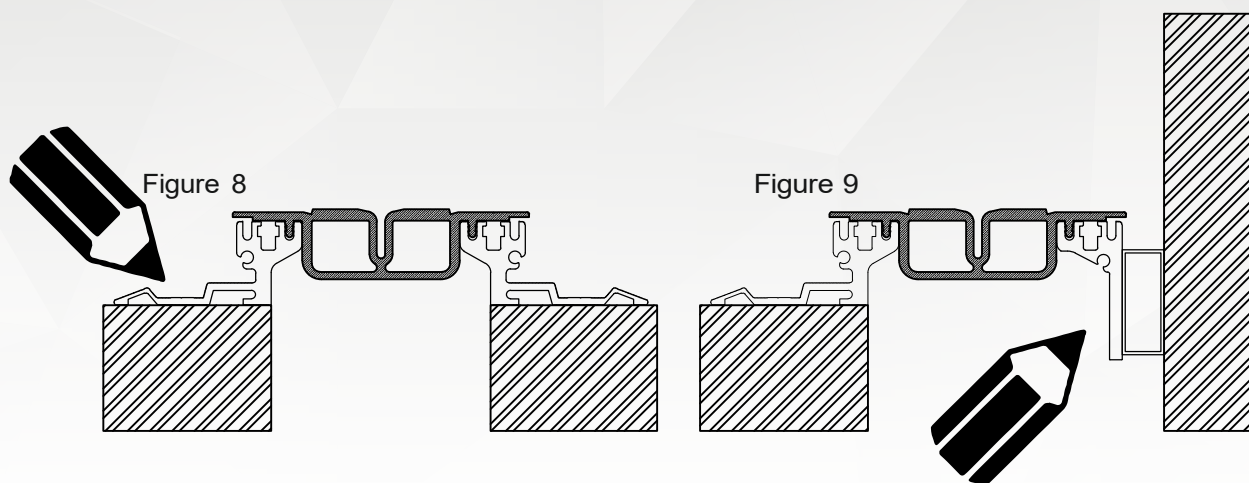

STEP 11. Drilling Concrete Hole

Using the assembled joint cover as a template, mark the location for an anchor on the concrete (see Figure 8 and Figure 9). Attach the base member to the high section of the high side of the joint first. Drill the anchor hole into the concrete at the marked locations. Drill the anchor holes 5 mm. deeper than the length of the anchors. Clean away all dust and debris from the blackout.

STEP 12. Fastening

Select the fasteners and the assembled joint cover. Place the assembled joint cover back into its installed position, aligning the anchor holes in the assembly with the anchor holes in the substrate. Shim the system as needed to assure that it is level with the finished floor and level along its run. Ensure that the joint cover system is level, firmly supported, and properly aligned. Fasten the assembled joint cover to the substrate (see Figure 10). Repeat this procedure for each section of the joint cover system.

Figure 10

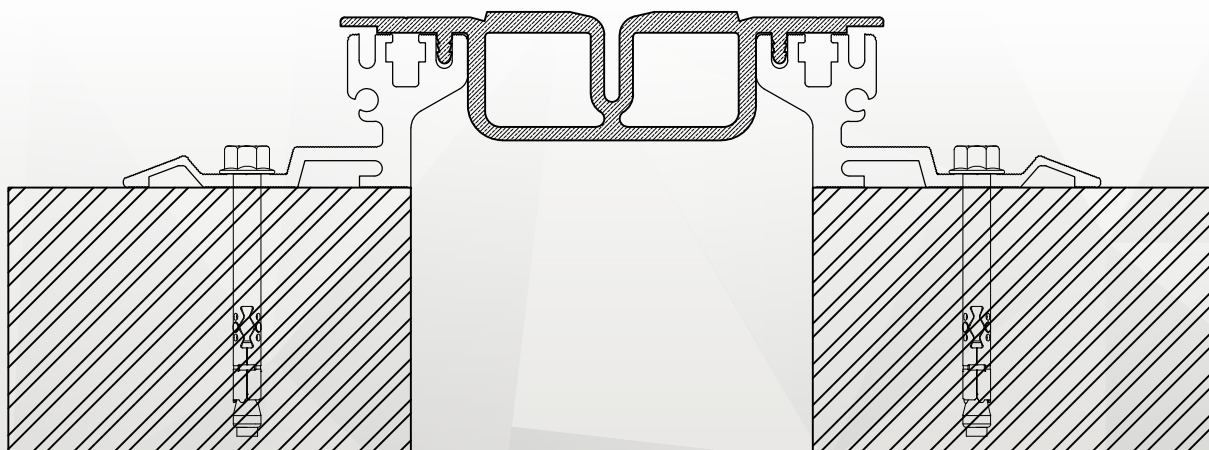



INSTALLATION INSTRUCTION



GENOTEK

WTZ-1800, WTZ-IK-1800 AND WTZK-1800 SERIES FLOOR EXPANSION JOINT COVER

STEP 13. Placement of Flushing Seal

Place the flushing seals after installation of waterproofing membrane completed by others (see Figure 11). Don't forget to put bitumin tape on the top of the waterproofing membrane before installing the flushing seal.

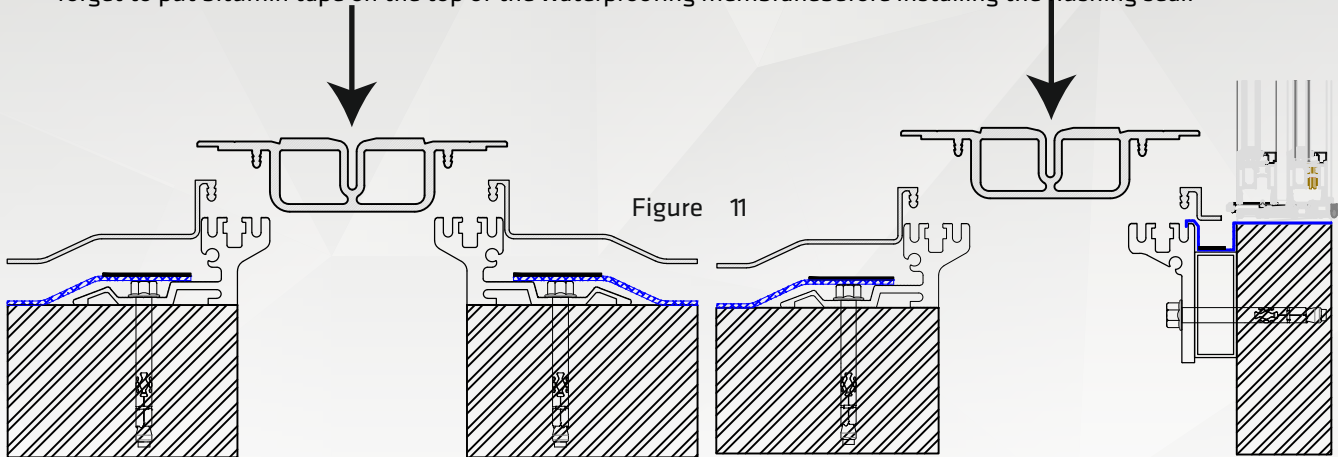

Step 14. Placement of Covers

Place the Stainless Steel Retaining Caps, **Cover Plate (optional)** and machine screws.

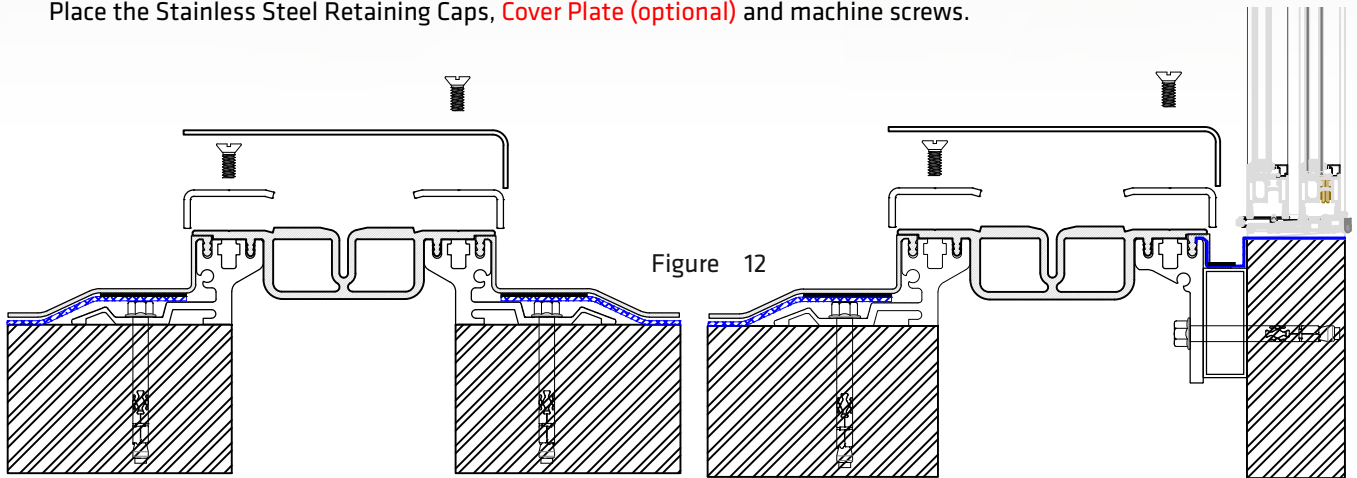

Place the 2nd layer of waterproofing membrane to encapsulate flashing seal (by others)

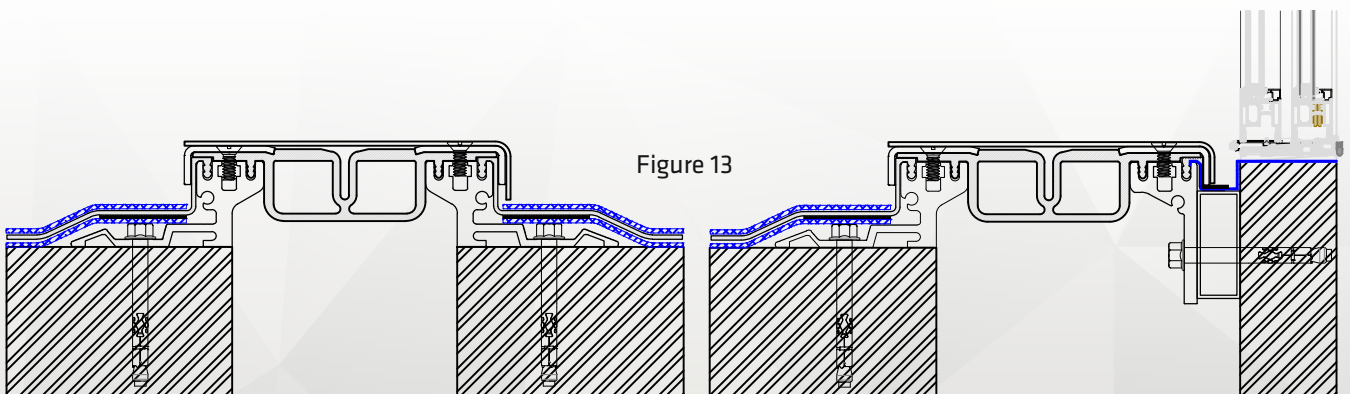



WTZ-1800, WTZ-IK-1800 AND WTZK-1800 SERIES FLOOR EXPANSION JOINT COVER

STEP 15. Place masking tape over the top of the joint cover system to protect it during grouting of the block-out. Dam the blackout for grouting. Ensure that the blackout is dammed well so that grout will not leak out of it onto levels below the installation. Place grout (by others) continuously between the base members and the blackout (see Figure 14,15 & 16).

