



INSTALLATION INSTRUCTION



GENOTEK

Z-1100 AND ZK-1100 FLOOR EXPANSION JOINT COVER

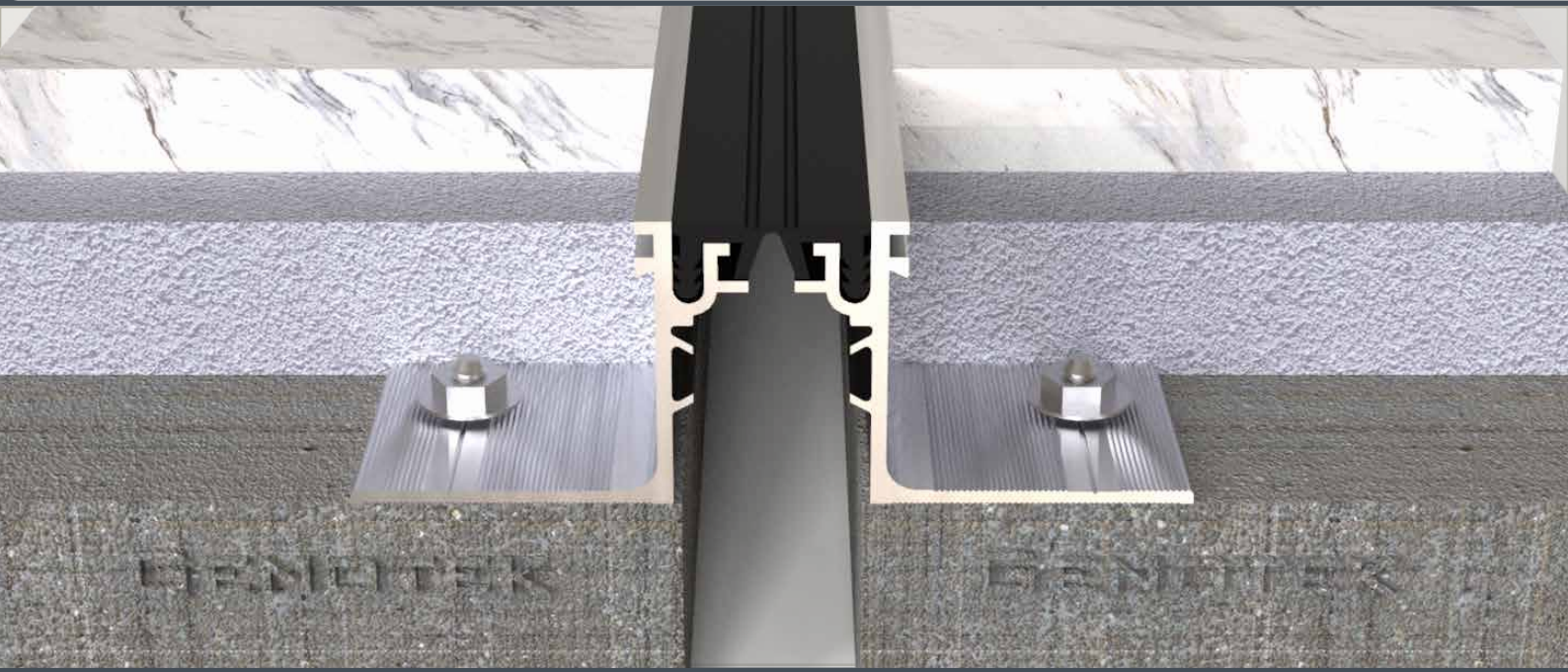

The following installation instructions are very important. Read them carefully, and be sure you understand them completely before you begin any work.

PREPARATION

1. Before beginning installation of the Z-1100 and ZK-1100, review the layouts for the various types and location as detailed on the approved GENOTEK shop drawings.
2. The concrete base should be cured at least 7 days and repairing of all cracks and spalled areas in the blockout should be done prior to the installation of the expansion joint profile. The blockouts may be formed at the time of the initial concrete pour or at a later time by removing material from the slab.
3. The base of the blockout should be leveled, flatted and paralleled. The minimum width of the blockout is 60mm. See figure 1 below for the blockout details;

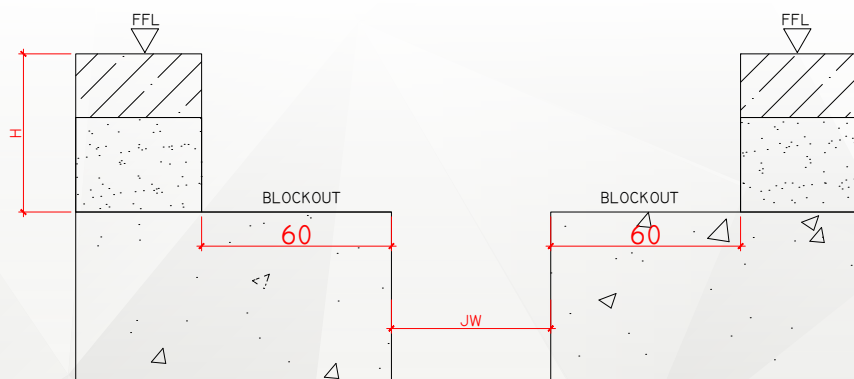

Figure 1.



Z-1100 AND ZK-1100 FLOOR EXPANSION JOINT COVER

INSTALLATION

1. Select a section of the base member. If the anchor holes have not been predrilled in the base members at the factory, mark the locations for the anchor holes on the selected base member. Standard anchor spacing is 30 cm. O.C. with an anchor at a nominal 10 cm from each end of the base member. Repeat marking of anchor locations for each section of the base member. If necessary, drill the holes into the base members at the marked locations (see Figure 2).

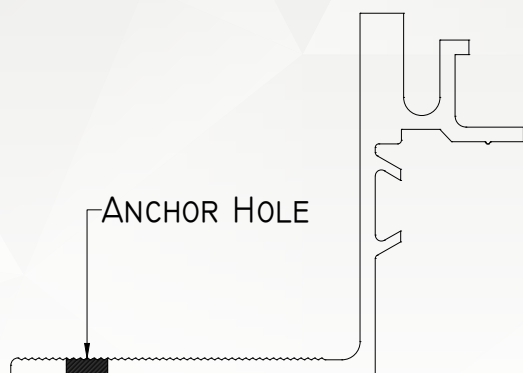

Figure 2.

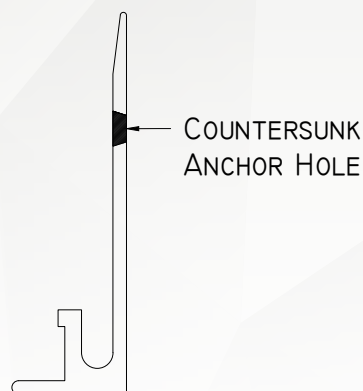

Figure 3.

2. For Floor-to-Wall joints, select a section of the wall member. If the anchor holes have not been predrilled in the wall members at the factory, mark the locations for the anchor holes on the selected wall member. Standard anchor spacing is 30 cm O.C. with an anchor at a nominal 10 cm from each end of the base member. Repeat marking of anchor locations for each section of the base member. If necessary, drill the holes into the wall members at the marked locations (see Figure 3). The wall member anchor holes are to be countersunk.
3. If fire barrier is specified, install it at this time. Refer to the appropriate fire barrier type installation instructions for additional instructions regarding the installation of the fire barrier.
4. If water barrier is specified, install it at this time. Refer to the installation instructions entitled, "INSTALLATION INSTRUCTIONS FOR GENOTEK EPDM WATER BARRIER SYSTEMS" for the recommended procedures for the installation of the water barrier.
5. Select two base members or a base member and a wall member (for Floor-to-Wall Systems), a cover plate (if applicable), and the elastomeric seal.

NOTE: THE ELASTOMERIC SEAL SHOULD BE INSTALLED IN AS LONG LENGTH AS POSSIBLE. CUTTING THE SEAL INTO LENGTHS THE SAME DIMENSION AS THE BASE MEMBERS IS NOT RECOMMENDED. THE SEAL CAN BE INSTALLED INTO A PAIR OF THE BASE MEMBERS OR A BASE MEMBER AND A WALL MEMBER, ALLOWING THE SEAL TO EXTEND BEYOND THEM SO THAT THE SAME UNBROKEN SEAL CAN BE INSTALLED IN SUBSEQUENT BASE MEMBER PAIRS. THE FACTORY RECOMMENDS INSTALLING THE ELASTOMERIC SEAL INTO THE WALL MEMBER FIRST. USE OF A WOOD BLOCK AND A Mallet ARE RECOMMENDED. ENSURE THAT THE SEAL'S TAB IS COMPLETELY ENGAGED INTO THE WALL MEMBER'S CHANNEL

6. Remove the base member from the blockout, and drill the anchor holes into the concrete substrate at the locations marked in Step 5.



Z-1100 AND ZK-1100 FLOOR EXPANSION JOINT COVER

7. Place the base members, or the base member and the wall member, about the width of the elastomeric seal apart on a flat working surface. Ensure that the base members' channels are facing one another (see Figure 4 & 5). Insert one of the elastomeric seal's tabs into the channel in one of the base members. Ensure that the seal's tab is inserted completely into the channel. Insert the elastomeric seal's opposite tab into the channel in the opposite base member. Ensure that the seal's tab is inserted completely into the channel.

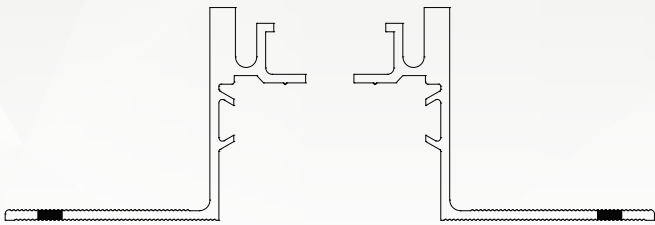

Figure 4.

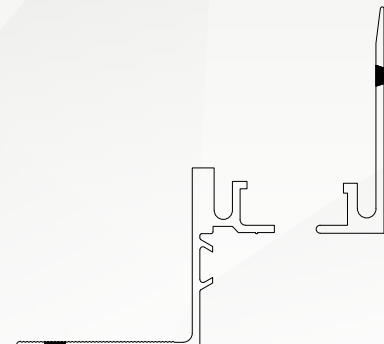

Figure 5.

8. Determine the high side of the joint or blockout. Begin the joint cover system on this side of the joint. Determine the high section of the substrate or blockout along the run of the high side of the joint. Begin the joint cover system installation at this section.
9. Place the assembled joint cover into its installed position in the blockout and over the joint (see Figure 6 & 7). Ensure that the system is plumb, level, properly aligned, and centered over the joint. For Floor to Wall Systems, ensure that the wall base member is at the proper elevation. GENOTEK recommends using awls to hold the joint cover system in position during anchoring.

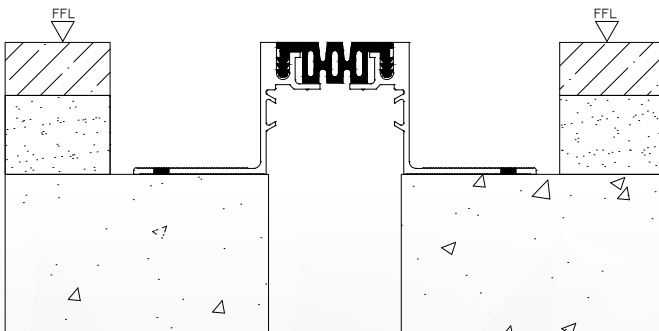

Figure 6.

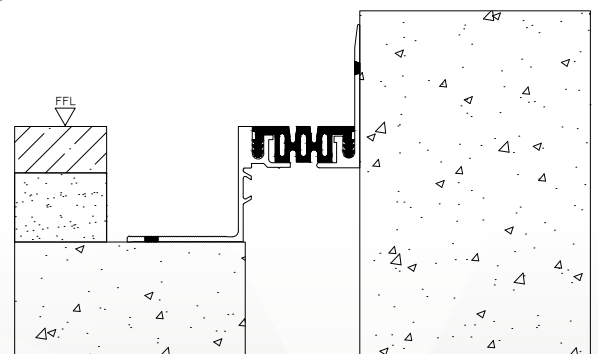

Figure 7.

NOTE: ENSURE THAT THE JOINT COVER BASE MEMBERS REST FIRMLY AND COMPLETELY ON THE SUBSTRATE SURFACE. ENSURE THAT THE COVER SYSTEM IS LEVEL WITH THE FINISHED FLOOR AND THAT THE SYSTEM IS LEVEL ALONG ITS LENGTH. SHIM AS NEEDED TO LEVEL THE SYSTEM. IF POSSIBLE, MAINTAIN THE STRAIGHTNESS OF THE INSTALLED JOINT COVER SYSTEM. DO NOT INSTALL BASE MEMBERS THAT OVERHANG TO THE JOINT OR CANTILEVERED OVER THE JOINT. FOR FLOOR-TO-WALL SYSTEMS HAVING STUD AND WALLBOARD WALL CONSTRUCTION AND USING SELF-DRILLING, SELF-TAPPING ANCHORS, PREDRILLING ANCHOR HOLES INTO THE WALL IS NOT NECESSARY.



Z-1100 AND ZK-1100 FLOOR EXPANSION JOINT COVER

10. Using the assembled joint cover as a template, mark the location for an anchor on the concrete. Attach the base member to the high section of the high side of the joint first. Drill the anchor hole into the concrete at the marked locations. Drill the anchor holes 5 mm. deeper than the length of the anchors. Clean away all dust and debris from the blackout.
11. Select the fasteners and the assembled joint cover. Place the assembled joint cover back into its installed position, aligning the anchor holes in the assembly with the anchor holes in the substrate. Shim the system as needed to assure that it is level with the finished floor and level along its run. Ensure that the joint cover system is level, firmly supported, and properly aligned. Fasten the assembled joint cover to the substrate (see Figure 8 & 9). Repeat this procedure for each section of the joint cover system.

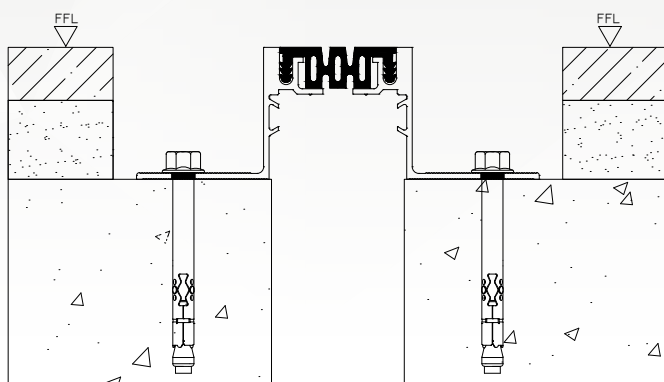

Figure 8.

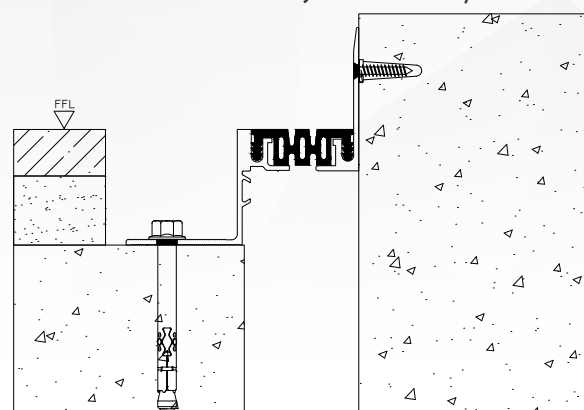

Figure 9.

12. Place masking tape over the top of the joint cover system to protect it during grouting of the blackout. Dam the blackout for grouting. Ensure that the blackout is dammed well so that grout will not leak out of it onto levels below the installation. Place grout (by others) continuously between the base members and the blackout (see Figure 10 & 11).

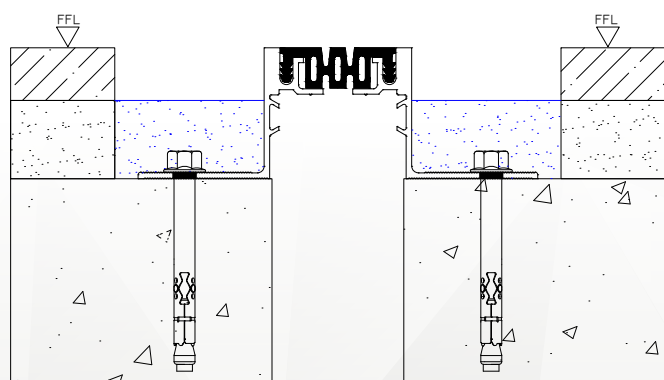

Figure 10.

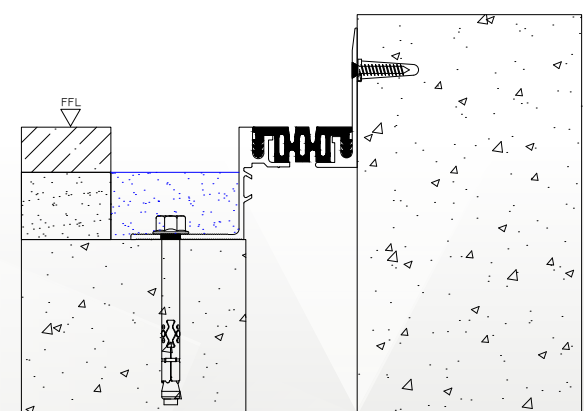

Figure 11.



Z-1100 AND ZK-1100 FLOOR EXPANSION JOINT COVER

13. Install the grout in accordance with the grout manufacturer's written instructions. Remove all excess grout from any exposed surfaces of the aluminum extrusions, base members and/or wall member, before the grout sets up.
14. Install finish floor material, if any, at this time (see Figure 12 and Figure 13). Install finish floor material in accordance with the instructions provided by the finish floor material manufacturer.

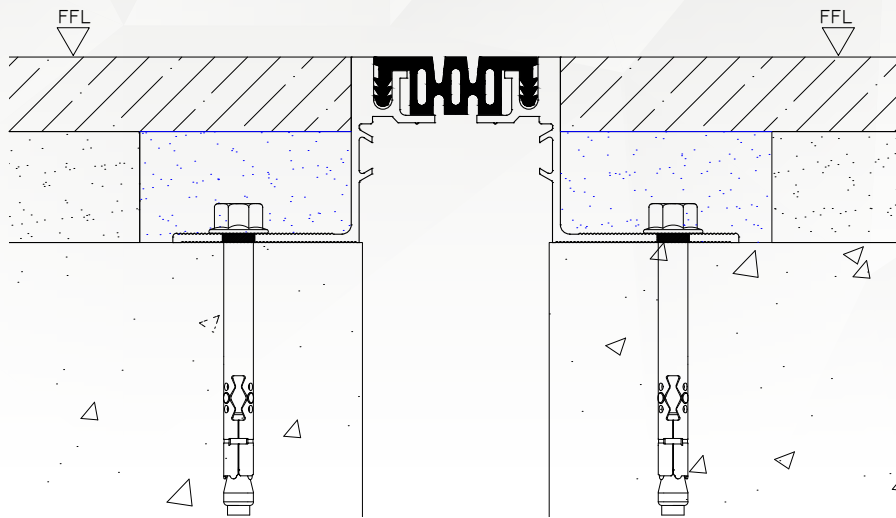

Figure 12.

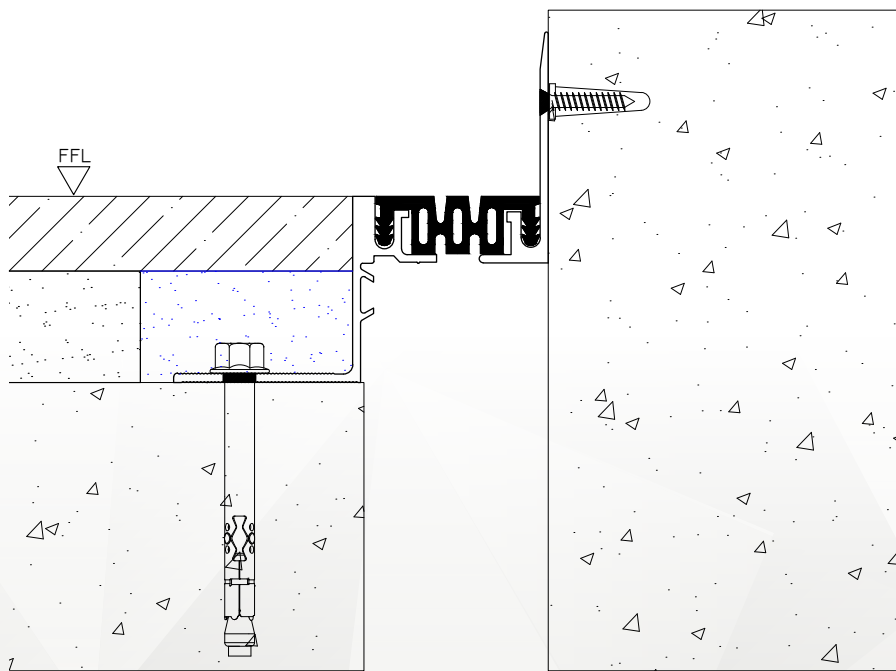

Figure 13.