



# BFM<sup>®</sup>fitting



Years of expertise & industry knowledge have created a transformed flexible connector.



# Traditional



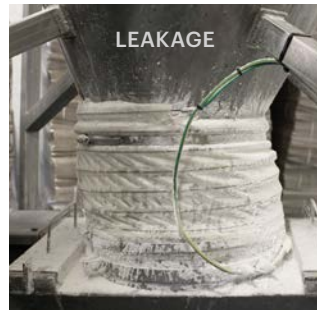



HOSE CLAMPED  
FABRIC SLEEVE

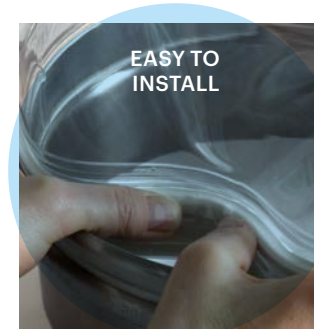

# Transformed

BFM®  
INTEGRATED  
SYSTEM



	Traditional	Transformed
<b>HYGIENE</b> 	Powder leaks through hose clips Build up between spigot and connector	Leak free – Dust free No crevices to collect product
<b>INSTALLATION</b> 	Inaccurate measurements & product variations create ill-fitting connections Installation problems due to variation in fabrication	Perfect fit every time – only in the correct place
<b>STANDARDIZATION</b> 	Connectors are made any sizes – thousands of stock variations possible	Diameters every 50mm from 100mm to 1650mm Lengths in 50mm increments standardizes stocks
<b>HEALTH &amp; SAFETY</b> 	Tools can damage connectors Installer's hands at risk	Tool free – snap fit Hand safe assembly Clean & transparent Connector gives Product flow visibility
<b>EXPLOSION RESISTANT</b> 	Overpressure causes hose clamp failure before connector failure	Seals tighter under pressure Independently explosion tested to 60 kPa +
<b>DOWNTIME</b> 	Slow and difficult to change Longer plant downtime during CIP & Maintenance Connectors wear out faster	Fastest change over in industry guarantees minimal machine interruption More durable connector means less change overs

## NON-PERMEABLE CONNECTORS

BFM®'s Seeflex range of connectors are made from clear, ether based polyurethane. Seeflex has no memory and will not fracture with flexing.



### SEEFLEX 040E - STRONG, MOST RESILIENT MULTI-PURPOSE CONNECTOR

- Temp. Range: -25°C to 110°C (-13°F to 230°F) • Surge Temp: 120°C (248°F)
- Surface Resistivity:  $10^{10} \Omega$  (Tested to ASTM D-257)
- Atex Compliant: IBExU tested
- Regulations: FDA CFR 177.1680. & 177.2600 (EC) 1935/2004, 2023-2006 & 10/2011, USDA & 3A (20-)



### SEEFLEX 020E - LIGHTWEIGHT & FLEXIBLE, IDEAL FOR WEIGHSCALE APPLICATIONS

- Temp Range: -25°C to 80°C (13°F to 176°F) • Surge Temp: 100°C (212°F)
- Surface Resistivity:  $10^{10} \Omega$  (Tested to ASTM D-257)
- Atex Compliant: IBExU tested.
- Regulations: FDA CFR 177.1680. & 177.2600, (EC) 1935/2004, 2023-2006 & 10/2011, USDA & 3A (20-)



### SEEFLEX 040AS - DESIGNED TO DISSIPATE STATIC, IDEAL FOR POTENTIALLY EXPLOSIVE AREAS

- Temp. Range: -25°C to 95°C (-13°F to 203°F) • Surge Temp: 100°C (212°F)
- Surface Resistivity:  $10^8 \Omega$  (very good at dissipating static - Tested to ASTM D-257)
- Clear ether based polyurethane with antistatic infusion
- Regulations: FDA CFR 177.1680. & 177.2600



### SEEFLEX 060ES - SUPERIOR STRENGTH FOR OVER-PRESSURE SITUATIONS

- Temp. Range: -25°C to 120°C (-13°F to 248°F) • Ether based polyurethane with internally bonded polyester scrim
- Surface Resistivity:  $10^{10} \Omega$  (Tested to ASTM D-257)
- Used for continuous pressure situations up to 1.3 bar
- Regulations: FDA CFR 177.1680. & 177.2600, (EC) 1935/2004, 2023-2006 & 10/2011



### FLEXI - SEEFLEX + WIRE COIL - IDEAL FOR BAG FEEDERS & FILLING HEADS

- Temp Range: -20°C to 85°C (-4°F to 185°F)
- Approx compression ratio: 3:1
- Also available as Flexi-Light (more flexible coil) and Flexi-Earthed with terminal lugs attached to coil ends
- Regulations: FDA CFR 177.1680, 21 CFR 175.105 (adhesives) & 177.2600, (EC) 1935/2004, 2023-2006, USDA & 3A (20-27)



### TEFLEX NP (NON-PERMEABLE) - PTFE LAMINATE FOR HIGH TEMPERATURE & CHEMICALS

- Maximum Operating Temp: 300°C (572°F) • Surge Temp: 316°C (600°F)
- Teflex NP can be used on products across the full pH scale (caustic/acid products will not effect Teflex NP)
- Designed to dissipate electrical charge - Surface Resistivity:  $10^6$  Ohms
- Regulations: FDA CFR 177.150 & CFR 178.3297, (EC) 1935/2004, 10/2011

## WOVEN CONNECTORS



### LM3 - 100% WOVEN POLYPROPYLENE - BREATHABLE & SUITABLE FOR LOW TEMPERATURES

- Temp. Range: -70°C to 94°C (-94°F to 201°F) • Surge Temp: 107°C (225°F)
- Air Permeability: 13 (cm<sup>3</sup>/cm<sup>2</sup>/sec@125Pa) 25 (ft<sup>3</sup>/ft<sup>2</sup>/min@0.5" wg)
- LM3 fulfils food contact requirements: Directives 1935/2004 and 10/2011, FDA certified for food contact



### LM4 - 100% WOVEN POLYESTER - BREATHABLE & SUITABLE FOR HIGHER TEMPERATURES

- Maximum Operating Temp: 130°C (266°F) continuous • Surge Temp: 150°C (302°F)
- Air Permeability: 0.4 (cm<sup>3</sup>/cm<sup>2</sup>/sec@125Pa) 0.8 (ft<sup>3</sup>/ft<sup>2</sup>/min@0.5" wg)
- LM4 fulfils Food contact requirements: Directives 1935/2004 and 10/2011 FDA CFR21, part 177.2800



### TEFLEX - PURE WOVEN PTFE - HIGH TEMPERATURE & CHEMICAL RESISTANT

- Maximum Operating Temp: 260°C (500°F) • Surge Temp: 280°C (536°F)
- Air Permeability: 0.3 (cm<sup>3</sup>/cm<sup>2</sup>/sec@125Pa) 0.5 (ft<sup>3</sup>/ft<sup>2</sup>/min@0.5" wg)
- Teflex can be used on products across the full PH scale (either caustic or acid)
- Regulation: FDA 21CFR 177.1550

## IN ADDITION TO THE ABOVE RANGE, BFM® CAN OFFER THE FOLLOWING PRODUCTS:



Flexi-Earthed



Flexi-Light



Steel Rings



Plastic Rings



Wash Sleeve



Tapered Connector



Black-Out Cover



Kevlar Cover



FM1 Breather Bag



Blanking Cap



Blanking Sock/Bin



TR (Tool Release) Option





