

*EveryPig*<sup>TM</sup>

Scheduling: Truck Driver  
Quick Start Guide



## Log In To Your EveryPig Account

Email

Password

[I forgot](#)



Sign in

[Trouble Logging In?](#)

[Privacy Policy](#)

©2021 All Rights Reserved. EveryPig is a registered trademark of EveryPig, Inc.

Once you have logged in  
Click on your Profile bottom left hand corner  
to update Basic User Information and  
Messaging Preferences

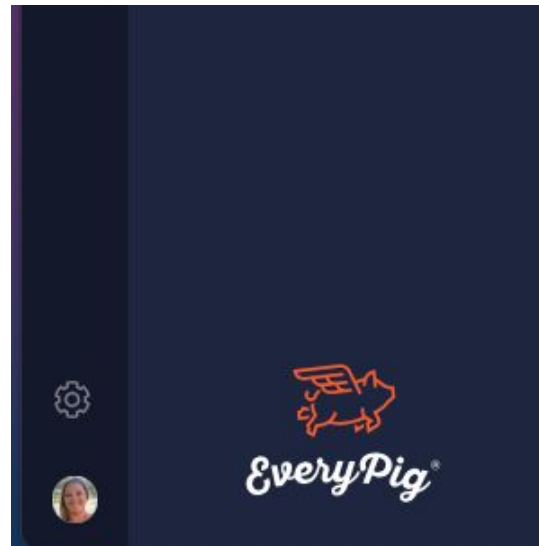

TT

DD

Dawn Driver ACTIVE  
spagirl29@gmail.com

User Information Messaging

Basic Info

Phone Number



+1 4014870025

*\*A cellphone number is required for SMS co*

First Name

Dawn

Email

spagirl29@gmail.com

Username

@ dawndriver

*Usernames are for mentioning other users to grab their attention.*

Personal

User Birthdate

MM/DD/YYYY

*With your permission, EveryPig will post a bi.*

Pork Checkoff

My Profile

Privacy Policy

Sign Out

Save Changes

## User Information -

Update Basic User information, Cell phone Number is required to receive SMS Communications

To Access Your Profile Click Here and Choose My Profile

TT



Dawn Driver ACTIVE  
spagirl29@gmail.com

User Information **Messaging**

<b>Messaging on EveryPig</b>	All notifications on, sounds on	<a href="#">Edit</a>
<b>Email</b>	All notifications on	<a href="#">Edit</a>
<b>Desktop and Mobile</b>	All notifications on	<a href="#">Edit</a>
<b>Text Messaging</b>	All notifications on	<a href="#">Edit</a>

## Messaging Preferences

Set Alerts for Messaging, Email, Desktop & Mobile as well as Text Messaging

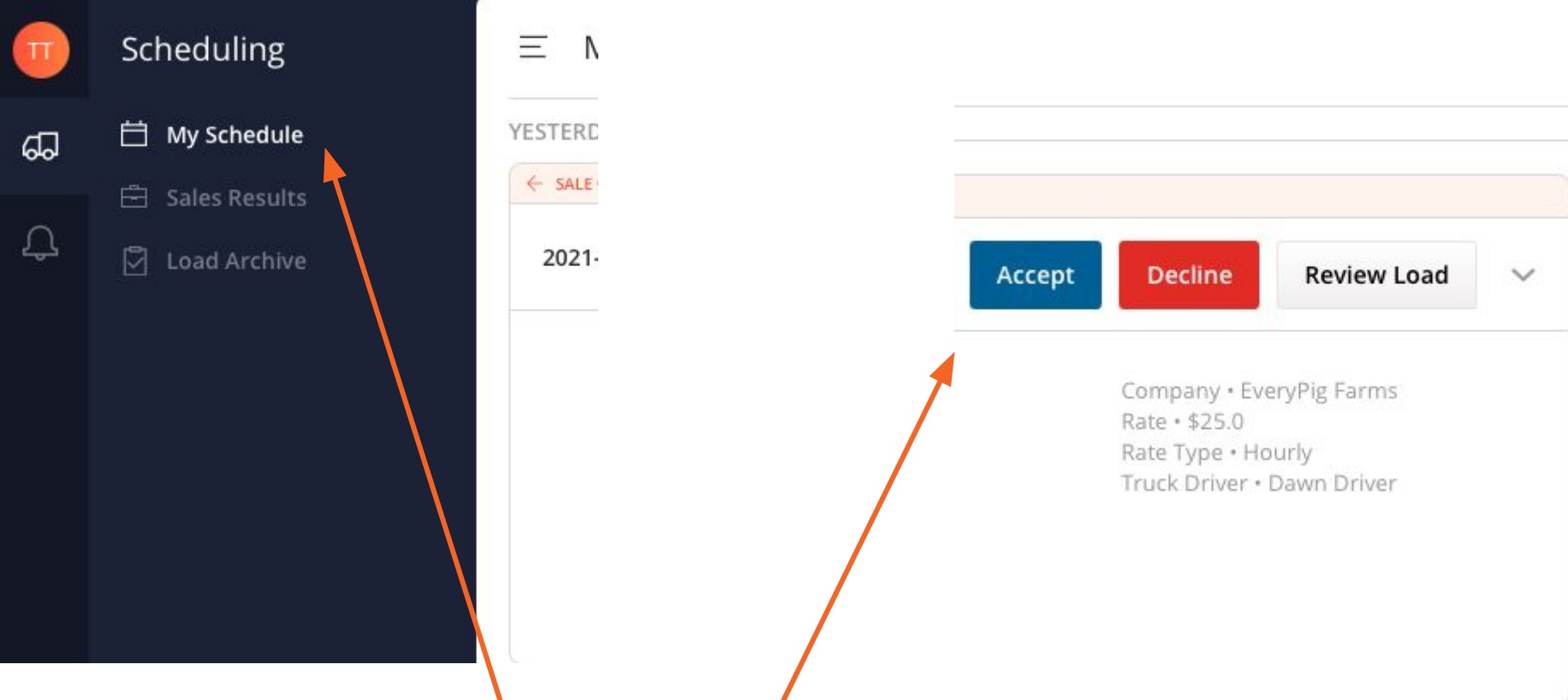

The Scheduling page will show loads assigned to you.

- Accept
- Decline
- Review Load

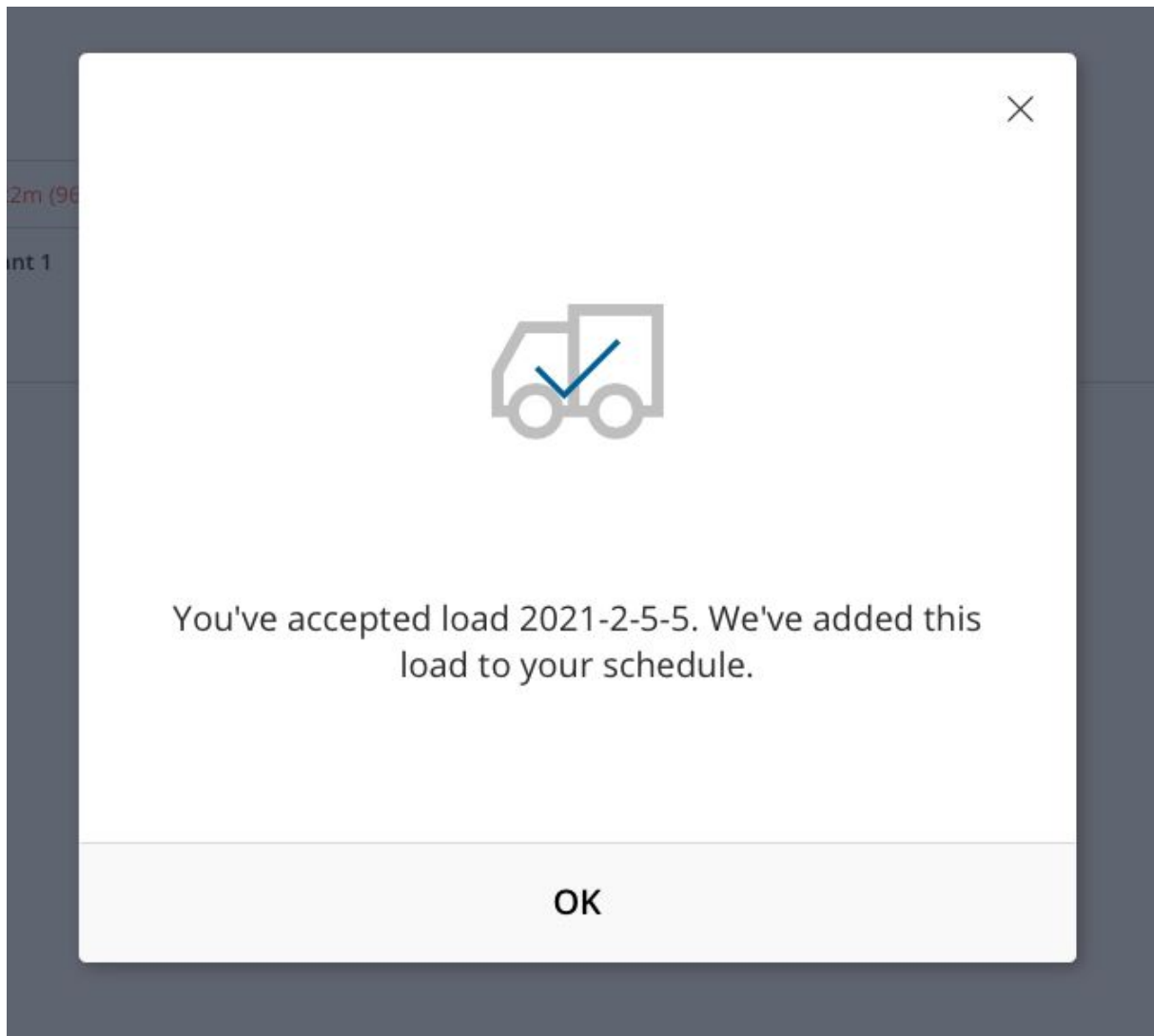

Accepting Load - Will give you a confirmation that this load has been added to your schedule.

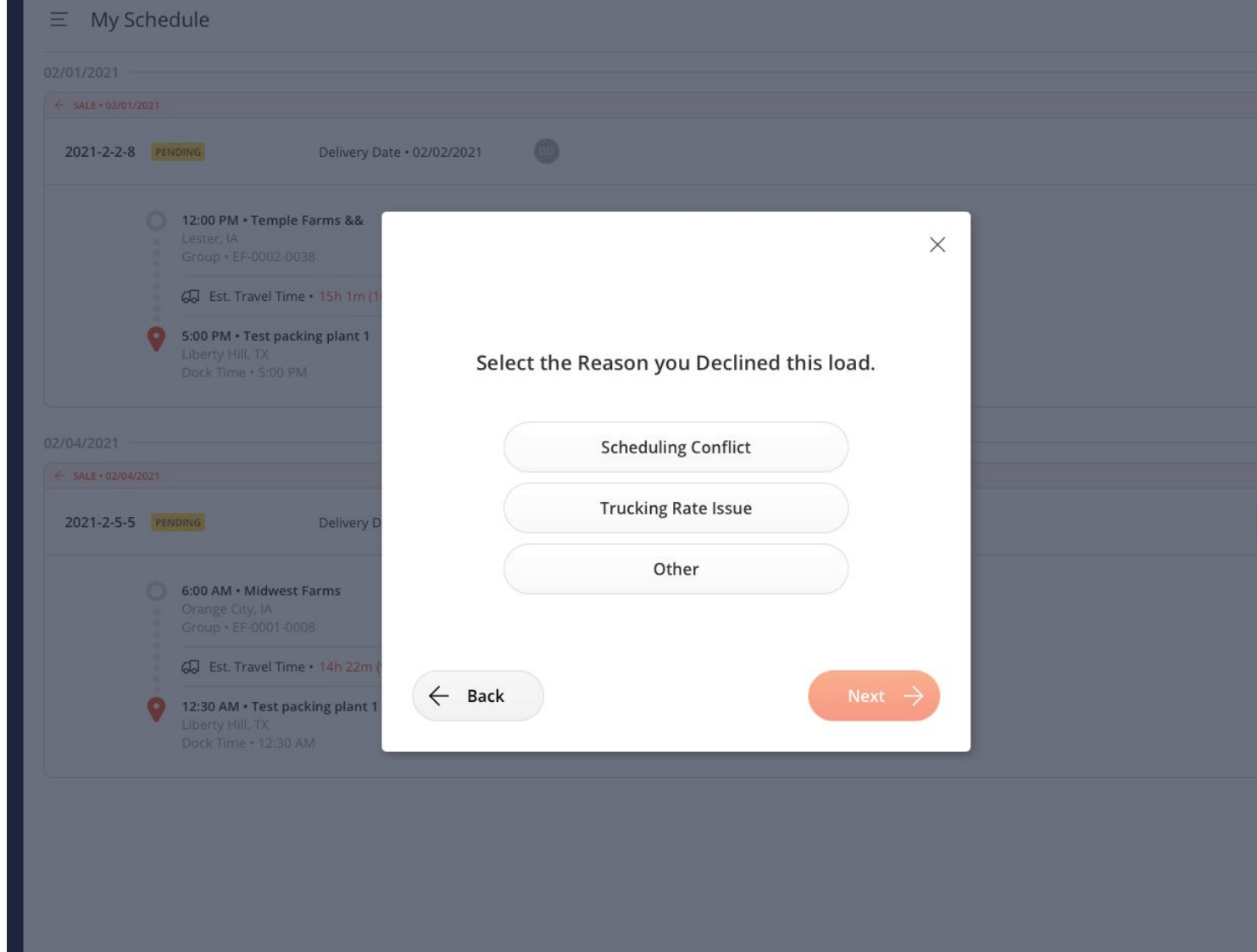

Decline - When you choose decline there are 3 options, you will need to choose 1 and then enter a reason for declining.



22m (96  
lant 1

×

Select the Reason you Declined this load.

✓ Scheduling Conflict

Trucking Rate Issue

Other

← Back

Next →

Declined Load Reasons -> Press Next

2m (96  
nt 1

Enter a note.

Enter your note here...

← Back

Decline →

The image shows a white dialog box with a dark grey border. At the top right corner, there is a small 'X' icon. The main heading is 'Enter a note.' Below this is a large, empty text input field with a light grey border and a placeholder text 'Enter your note here...'. At the bottom left, there is a light grey button with a left-pointing arrow and the text 'Back'. At the bottom right, there is a red button with the text 'Decline' and a right-pointing arrow.

**Declined Load- Enter Reason here and Click Decline, this will remove it from your schedule area**

TT Scheduling

My Schedule

Sales Results

Load Archive

My Schedule

02/01/2021

SALE • 02/01/2021

2021-2-2-8

PENDING

Delivery Date • 02/02/2021

BO

Accept

Review Load

12:00 PM • Temple Farms &&

Lester, IA

Group • EF-0002-0038

Est. Travel Time • 15h 1m (1000.9 miles) View Map

5:00 PM • Test packing plant 1

Liberty Hill, TX

Dock Time • 5:00 PM

Rate Type • Hourly  
Truck Driver • Dawn Driver

Review Load - Will take you to details on the Load.

You will have the option to Accept or Decline the load in the Review section as well.



New Sale Scheduled!

COMPANY	EveryPig Farms
LOAD DATE	02/04/2021
LOAD TIME	6:00 AM
DOCK TIME	12:30 AM
CUT LEVEL	First
TARGET HEAD COUNT	500
MILEAGE	N/A
RATE	\$25.0
RATE TYPE	Hourly
TRUCK DRIVER	DD

- 6:00 AM • Midwest Farms  
Orange City, IA  
Group • EF-0001-0008
- Est. Travel Time • 14h 22m (965.8 miles) [View Map](#)
- 12:30 AM • Test packing plant 1  
Liberty Hill, TX  
Dock Time • 12:30 AM

**Trucking Company**  
Texas Trucking  
Beaumont, TX

**Truck Driver**  
Dawn Driver

## Review Load Details

Decline Load

Accept Load



## Notifications



EARLIER



New load Assignment! First pick up 02/04/2021, 6:00 AM, at Midwest Farms. Last destination 02/05/2021, 12:30 AM at Test packing plan

7 days ago • Read



New load Assignment! First pick up 01/29/2021, 6:00 AM, at Temple Farms && . Last destination 01/30/2021, 10:30 AM at Test packing pl

7 days ago • Read



New load Assignment! First pick up 02/04/2021, 6:00 AM, at Midwest Farms. Last destination 02/05/2021, 12:30 AM at Test packing plan

7 days ago • Read



New load Assignment! First pick up 02/01/2021, 12:00 PM, at Temple Farms && . Last destination 02/02/2021, 5:00 PM at Test packing pl

7 days ago • Read

Notifications - Allows you to review the details of loads