

PS_6020_HSRB_9_004B

NO.	DRAWING #	DESCRIPTION	QTTY
1	PS_6020_HSRB_9	PS-6020-HSRB SHAFT ASSEMBLY	1
2	SH_739HS	SHAFT, 7300 HIGH-SPEED BLOW OFF	1
3	JT_HSRB	DUAL BLEED REBOUND JET	1
4	SP_8770HSC_40_HSRB	RENTON COIL-SPRING - VARIOUS RATES	1
5	JT_73HS_RD_VESPEL	JET, 7300 HIGH-SPEED BLOW-OFF SHAFT POPPET VALVE 01	1
6	HG_73HS_RD_254B	HOUSING, 7300 H/S REB BLOW-OFF SHAFT	1
7	VW_73HSRD	VESPEL WASHER	1
8	OR_6MMX1MM_V	O-RING, BROWN VITON	1
9	OR_2007_B	O-RING, BUNA	1
10	AS_KN_73HS_RD	ASSEMBLY, KNOB, 7300 SERIES HIGH-SPEED BLOW-OFF SHAFT OPTION	1
11	RS_73HS_081C	SCREW, 7300 HIGH-SPEED BLOW-OFF SHAFT ADJUSTER	1
12	KN_73HS_034C	KNOB, 7300 HIGH-SPEED BLOW-OFF SHAFT ADJUSTER	1
13	SP_70439	SPRING, DETENT	1
14	SC_73HS	SCREW, SHCS 4-40 X 1.750, DETENT	1
15	CP_73HS_036A	SPRING RETAINER, 7300 HIGH-SPEED BLOW-OFF SHAFT ADJUSTER	1
16	BA_0625_ST	.0625 STEEL BALL	4
17	MR_HSRB_240	RD METERING ROD	1

PS-6020-HSRB ASSEMBLY PROCEDURE

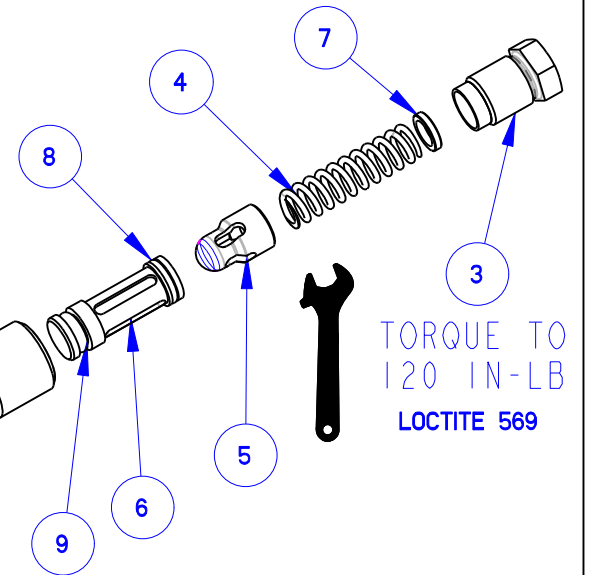

NOTES:

- 1) APPLY LOCTITE PRIMER TO (16) STEEL BALLS AND (12) AND ALLOW TO SET-UP UNTIL ODOR IS NO LONGER DETECTED.
- 2) APPLY LOCTITE 648 TO HEMISPHERICAL POCKETS IN (12)
- 3) USE PUNCH TO STAKE BALLS IN (12) WITH HAMMER. WIPE OFF EXCESS.
- 4) LOCTITE THREAD SEALANT 569 IS APPLIED TO (3) AND TORQUE TO 120 IN LBS
- 5) APPLY MOBIL 1 RED GREASE TO THREADS OF (11)
- 6) APPLY LOCTITE 263 TO THREADS OF (14)
- 7) TIGHTEN UNTIL CAP SCREW HEAD IS UNDER FLUSH WITH END OF (11) BY .370".
- 8) UNLESS NOTED, ALL O-RINGS RECEIVE BEL-RAY WATERPROOF GREASE.

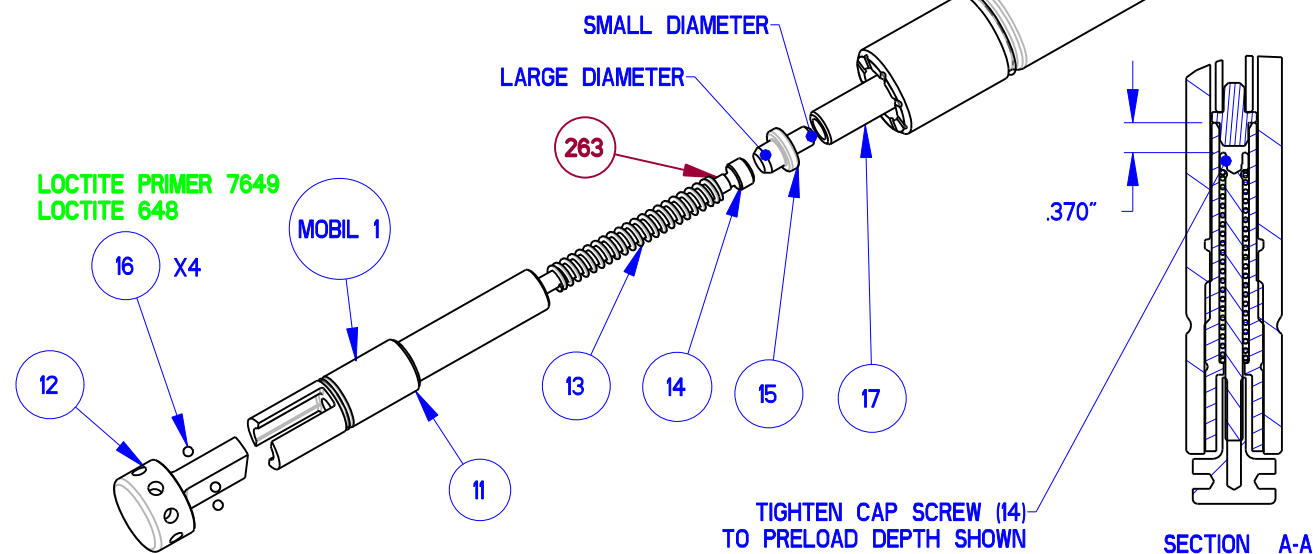

SCALE 0.375

SHAFT P/N	SHAFT LENGTH	MR-12 LENGTH
SH-735HS	8.625"	4.060"
SH-736HS	9.625"	5.060"
SH-737HS	10.500"	5.935"
SH-738HS	11.500"	6.935"
SH-739HS	12.500"	7.935"

REVISIONS			THIRD ANGLE PROJECTION		DO NOT SCALE		IF IN DOUBT - ASK		
NO.	WAS	DATE	PENSKE RACING SHOCKS		THIS DRAWING AND THE INFORMATION CONTAINED HEREIN IS THE PROPERTY OF PENSKE RACING SHOCKS. IT IS PRIVATE AND CONFIDENTIAL AND IS ISSUED ON THE EXPRESSED CONDITION THAT IT IS NOT COMMUNICATED DIRECTLY OR INDIRECTLY, IN WHOLE OR IN PART, OR USED FOR MANUFACTURE OF ANY PARTS SHOWN HEREIN, WITHOUT THE WRITTEN CONSENT OF PENSKE RACING SHOCKS. ACCEPTANCE OF THIS DRAWING WILL BE CONSTRUED AS ACCEPTANCE OF THE FOREGOING CONDITIONS.				
1	ISSUE	04/06/2011	150 FRANKLIN STREET, READING, PA 19603 U.S.A. (610)375-6180(PH) (610)375-6190(FAX)		TOLERANCES U.S.	DESIGNED BY: JMA	CHECKED/FEA BY:	ISSUE DATE: 04/06/2011	WEIGHT(LBS.):
			FRAC. ± 1/32	MATERIAL:	MACH. FINISH: 32	FINISH/PROTECTION:	HEAT TREATMENT:		
			.XX ± .010 .XXX ± .005 .XXXX ± .001	TITLE: PS-6020-HSRB SHAFT OPTION, HSRB					
			ANG. ± 1/2°	SCALE: 0.875	SHEET 1 OF 1	DRAWING NUMBER: PS_6020_HSRB_9_004B			