

NU-FORM™ UNIVERSAL BACK BRACE 0637

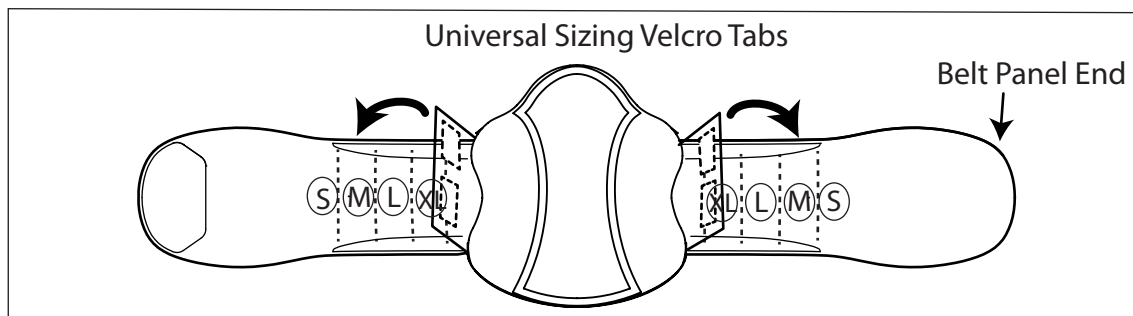

1. Adjust universal sizing by moving panels through D-ring to the desired size. Size markings are clearly labeled on the inside of each panel. Align and firmly secure each panel by attaching the hook to loop area.

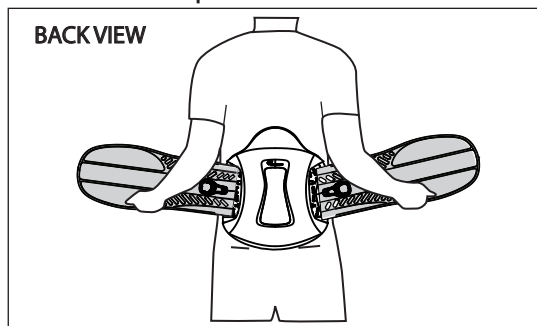

2. Position the brace so that it is centered on the back over LS area.

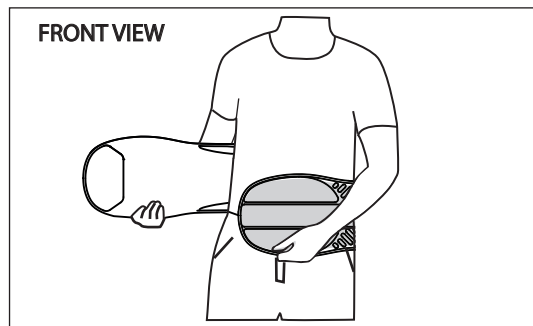

3. Pull the belt panel ends forward around waist, placing right belt panel on top of left belt. Engage the hook and loop.

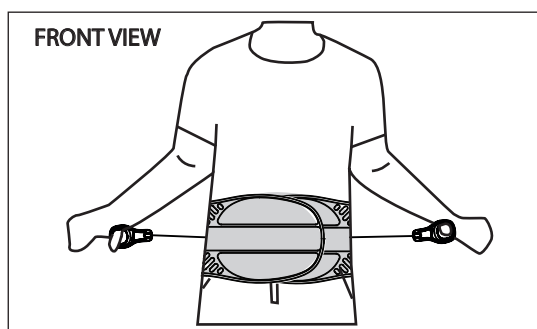

4. Pull both sides of pull rings forward and around for comfortable adjustment (micro fit).

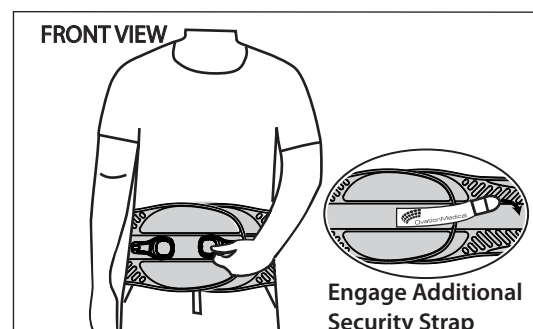

5. Secure pull rings by pressing firmly onto front of the brace. Adjust as needed. Security strap can be used for extra security.

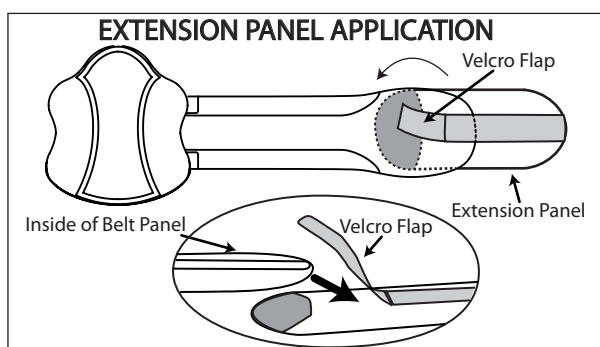

If patient requires a larger size than universal, an Extension Panel is available to add 18 inches in length (70 inches in total girth). The Extension Panel attaches to the outside of the left belt panel. The velcro flap of Extension Panel should attach to the inside of the belt panel.

NOTE: Do not over tighten, adjust as necessary.

CAUTION: If swelling increases and pain, numbness, skin irritation occurs, discontinue use. Contact medical provider immediately. This product is only a support device, not to prevent injuries or prevent reoccurrence of injuries.

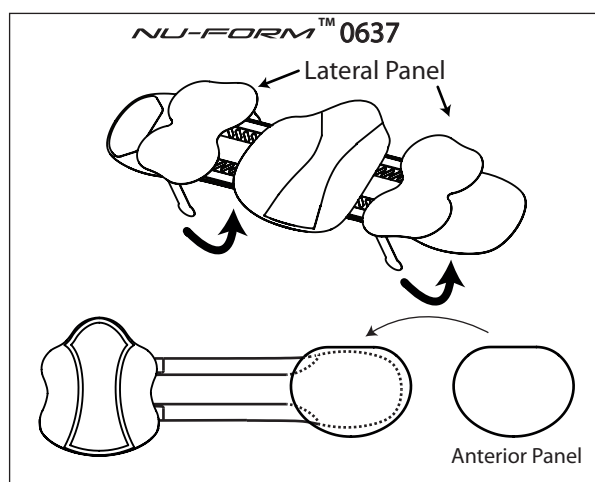

The NU-FORM™ 0637 comes with an anterior and lateral panels for support and compression.



OvationMedical®

5155 Clareton Dr.
Agoura Hills, CA. 91301
USA
800 403-6466
www.ovationmed.com

EC REP

MDSS GmbH
Schiffgraben 41
30175 Hannover
Germany

